

NAME	TOTAL	CLASS	DATE	SCORE	TIME
WILLIAMSON, DON					722-3604
KENNETH ARGENT	1.7	-	10/4	500-4266	
✓ SKIPPER ALLEN	35.1	S	9/27	557-6634	727-3614
✓ GERALD AURILLO	2.6	S	10/7	341-6660	822-0079
✓ FRANK BENFATTI	23.0	S	9/16	900-4210	
TOM BAKER	14.5		6/29		
BOB BAKER	13.0	S	10/9	557-5412	525-3471
CARLOS BERTOT	5	-	4/15		
JERRY BROWN	2.0	-	4/17		
✓ BRYAN BURCH	34.0	S	9/26	5-0257	721-2211
BOBBY CARBAJAL	23.0	S	9/19	341-1722	255-2149
WILHELM COLN	13.0	-	3/25	443-5452	Royal Crown
CHARLES COULON	33.3	S	3/4	524-0056	729-2411
✓ NEEL COUVILLON	14.0	S	10/9	524-9603	522-4571
JAMES CURRAN	36.0	P	4/26/65		
PHILIP DEGRACIAS	20.4	S	8/23	506-2090	650-3700
MARVIN DESCANT	462 115.0	S	10/9	484-7648	255-3112
KEITH DUFOUR	115.0	-	4/24		
CYRILLE DUPONT	1.0	-	4/24		
RICHARD DUESSE	22.0	S	3/31	100-0040	525-3018
JESSIE ESTAPA	2.5	-	6/8	65-3077	
HOWARD FILBY	43.0	S	10/6	293-8157	527-0000
JOHNNY FRALICK	4/0	P	7/10	701-1219	
DON FLETTRICH	39.0	S	5/24	537-0867	652-2644
TIM GEORGE	27.0	S	2/6	684-6748	680-3131
CHARLES GEORGE	102.0	P	9/23	544-8665	722-0190
GEORGE GORSIE	102.0	P	10/7	544-8665	555-3100
HARVEY GUSTAFSON	54.0	S	9/7		
SPINARD, FRANK		S		282-1910	524-3131
Pasche, Curtis		S		524-8182	704-7211
Poole, Carol				894-7665	866-7011
Brown				527-0000	722-0000

NAME	TOTAL	CLASS	DATE		
ROBERT HANNIGAN	8.0	E	10/9	729-2075	
JIMMY JOHNSON	30.0	S	10/3		
STEVE LAMBERT	29.5	S	6/6		
DR. LAGO	47.6	S	10/9		
STANLEY MONTZ	100.0	E	10/6		
LENNARD LEE	6.8		10/4	288-1755	255-3350
RONNIE LEHMAN	91.7		10/3	279-4668	251-351
PAT LYNCH	106.0	P	9/7		
SANDY MIEGLEA	5.0	S	10/8		
JIMMY MILLER	36.1	S	10/5		
WAKE MIRE	21.0	S	10/9	835-2582	835-3300
JOE MOLINARY		S	9/24	255-7275	522-1446
BYRON MYRICK	18/0	S	10/8	277-6734	
TED NORRIS	9.0	S	10/2	266-6693	866-5074
BRUCE NOLAN	1.0	S	9/15	682-0443	755-1511
CHARLES O'DELL	55.0	P	9/24	341-1634	
JAMES PARKER	1.5		3/8	543-2752	
DON PETERS	99.0	P	9/28	242-2447	
EDWARD POLK	1/0		4/12		
BILL RHEADE	9.0	S	9/7	447-3871	
J. ROSENTHAL	1.0		9/22		
LEE RICHENAU	14.0	S	10/1	442-3005	279-4114
JACK SAWYER	26.0	S			
BOB SIMONETTE	102/0				
VIC SCHILLEST	60.0	P	9/22	255-7221	
ALAN SWEAR	23.0	S			
SPRENGER					
NICHOLS, D.					
More on					
Inclining for 5721 Burgundy 943-7458					
Most handles 833-2546 535-6071					

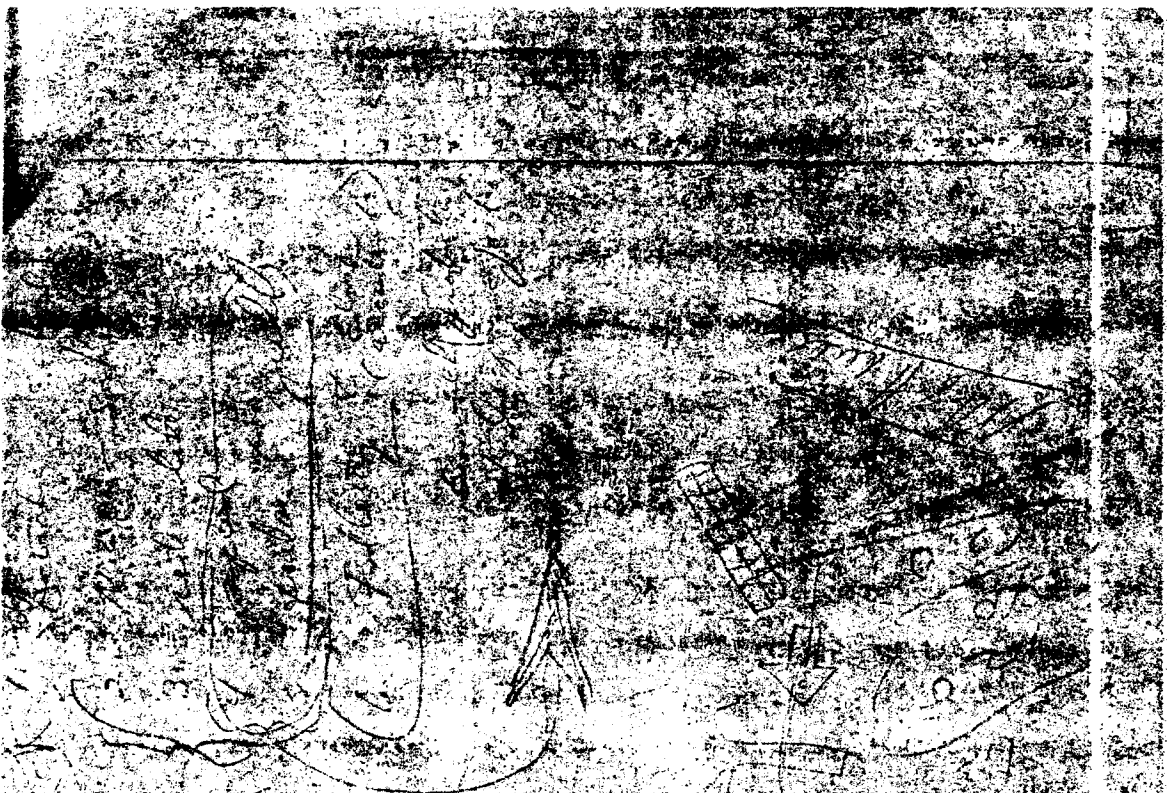

I make my own
light & charcoal
portraits
747
Champion
In which point I differ
from Judge

GHS TEAMWORK
 DENNIS TIRDALE
 ROBERT TAYLOR
 GEORGE WADE
 HOWARD WILLIAMS
 RONALD WOODS
 BRENNER WATERS
 DONN WILLIAMS
 JIM WILLIAMS
 WARREN WHITSON
 BOB BERN
 RONALD DUNN
 JIMMY DUNN
 JIMMY DUNN
 LARRY DUNN
 DON DUNN
 DON NEUMANN
 JOY HOUON
 JOHNNY KIRBY
 ALLEN MEIER
 DR. REYNOLDS
 JOHN PERREA
 BOB PLUNKET
 JOHN PORTER
 NICKY SIMONETTE
 LEAN SCORIAS
 Abbie L. (71763) 16000 (20) (4/10/40) 486-4934 255-38
 Betty AL 255-2451
 Graham H.
 Les ("LOVER") TEMPLETON Esq. 256 241-2360 Wh-3876

DAVE FERRIE

I have to fly 1 hour.

Will you wait for me?

The airplane to the
next week

Sunday station 12:00

30645

7/20/50

7/21/50

7/22/50

7/23/50

7/24/50

7/25/50

7/26/50

7/27/50

7/28/50

7/29/50

7/30/50

7/31/50

8/1/50

8/2/50

8/3/50

8/4/50

8/5/50

8/6/50

8/7/50

8/8/50

8/9/50

8/10/50

8/11/50

8/12/50

8/13/50

8/14/50

8/15/50

8/16/50

8/17/50

8/18/50

8/19/50

8/20/50

8/21/50

8/22/50

8/23/50

8/24/50

8/25/50

8/26/50

8/27/50

8/28/50

8/29/50

8/30/50

8/31/50

9/1/50

9/2/50

9/3/50

9/4/50

9/5/50

9/6/50

9/7/50

9/8/50

9/9/50

9/10/50

9/11/50

9/12/50

9/13/50

9/14/50

9/15/50

9/16/50

9/17/50

9/18/50

9/19/50

9/20/50

9/21/50

9/22/50

9/23/50

9/24/50

9/25/50

9/26/50

9/27/50

9/28/50

9/29/50

9/30/50

10/1/50

10/2/50

10/3/50

10/4/50

10/5/50

10/6/50

10/7/50

10/8/50

10/9/50

10/10/50

10/11/50

10/12/50

10/13/50

10/14/50

10/15/50

10/16/50

10/17/50

10/18/50

10/19/50

10/20/50

10/21/50

10/22/50

10/23/50

10/24/50

10/25/50

10/26/50

10/27/50

10/28/50

10/29/50

10/30/50

10/31/50

11/1/50

11/2/50

11/3/50

11/4/50

11/5/50

11/6/50

11/7/50

11/8/50

11/9/50

11/10/50

11/11/50

11/12/50

11/13/50

11/14/50

11/15/50

11/16/50

11/17/50

11/18/50

11/19/50

11/20/50

11/21/50

11/22/50

11/23/50

11/24/50

11/25/50

11/26/50

11/27/50

11/28/50

11/29/50

11/30/50

12/1/50

12/2/50

12/3/50

12/4/50

12/5/50

12/6/50

12/7/50

12/8/50

12/9/50

12/10/50

12/11/50

12/12/50

12/13/50

12/14/50

12/15/50

12/16/50

12/17/50

12/18/50

12/19/50

12/20/50

12/21/50

12/22/50

12/23/50

12/24/50

12/25/50

12/26/50

12/27/50

12/28/50

12/29/50

12/30/50

12/31/50

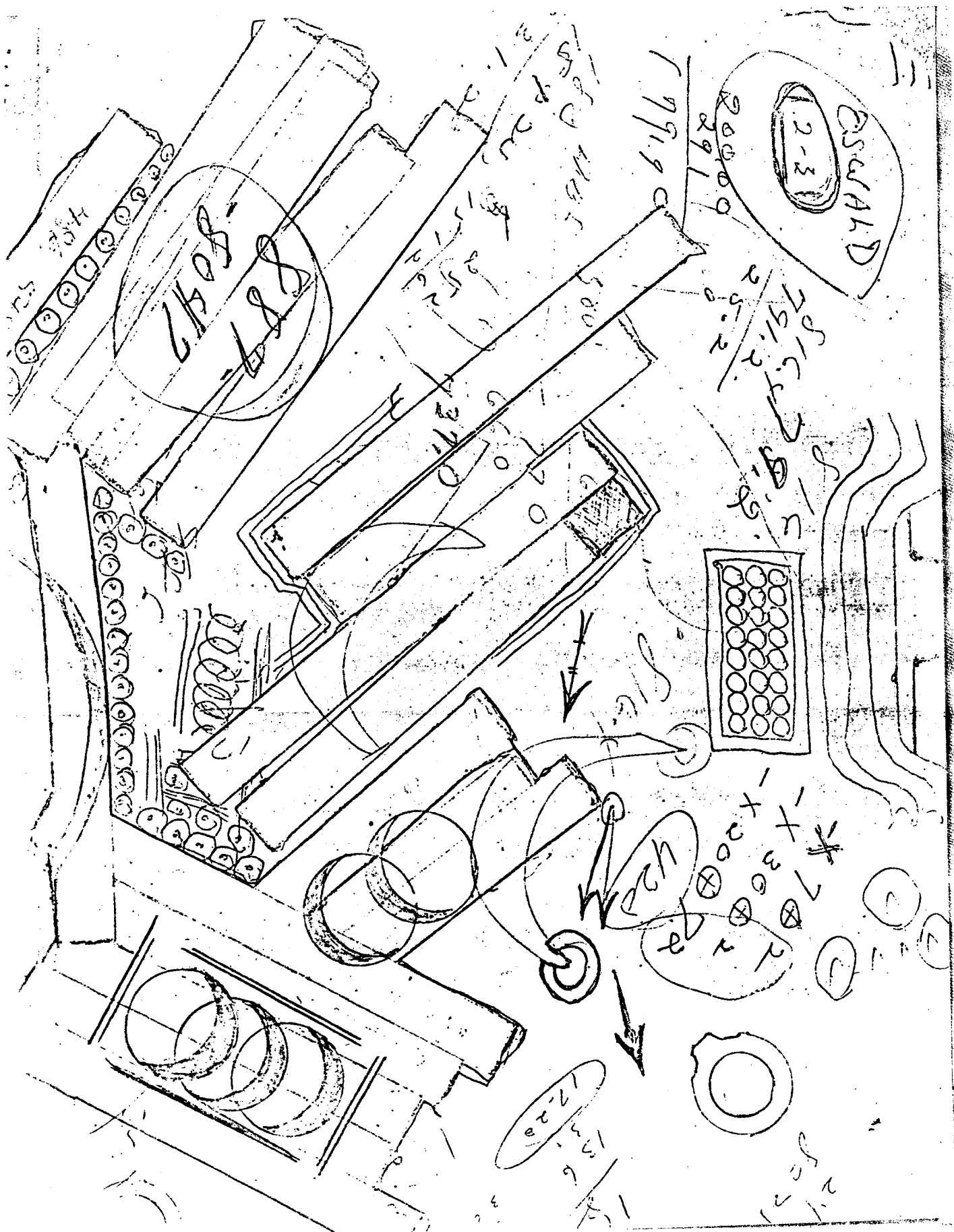

MARCH 20 1963 OSWALD IN DALLA
APRIL 24 1963 FAMILY + OSWALD MOVED TO

8495227
RODNEY

COFFEY

COFFEY

305-783-6294

1955-1956

PINKY

BIVOUAC

739669
Bivouac

10/1
1/2
- 4075 -
588

SEPT 27 1963 OSWALD IN MEX CITY

LIBRARY

McMurtrei, Richard

P

815-968-8292

11/10/60

NAME	TOTAL	CLASS	DATE	NAME	DATE
<i>Amello</i> DAVE PIER <i>FEAR (Chester Hill)</i>					822-029/3618660
LES BEAMAN	3.5	B	10/1	242-2192	253
CHARLES SMITH	1.0	B	9/10		
GUS TERRAVOIT				163-4272	114-2
DENNIS TIDDALE	1.0	B			
ROBERT TOWLES	2.0	B			
GEORGE WADE ✓	2.0	B	10/1	242-2164	
HOWARD WILLIAMS	20.6	B	4/29	307-5657	
RONALD WOODBURN	16.7	B	5/27	725-2100	
BRENNER WATERS	101.0	P	9/5	145-1271	135
DOUG WILLIAMS	19.3	B	9/20	834-2427	60
JIM WILLIAMS		P		143-2367	55-2
WARREN WITTENBORN	16.0	B	9/17		
BOB BERAN <i>MOVED</i>	10.0	B	9/30	143-2264	
RONALD DUNHAM	18.6	B	9/19	143-0189	436-3
JOHN FLYNN		B	10/6	234-0344	509-14
JIMMY GELB	20.2	B			
LENN GIBSON	2.0	B	9/8		143-21
ROBERT HARRIS	17.2	BP	10/5	208-4770	
DON HEUMANN	5.0	B	10/6	143-3611	246 810
JOY HOUON	25.0	B	9/19	240-2181	835-69
JOHNNY KIRSON	29.6	B	10/10	242-4443	834
ALLEN MEISER	4.0	S	10/2	233-6922	
DR. NICHOLS	20.3	B	9/20	TW 1-2981	
JOHN PERREA	5.7	B	9/19	341-1634	
BILL PLUNKETT	6.3	S	10/8	834-2613	
JOHN PORTER	29.7	BP	10/9		527-3111
MIKEY RIMMERT	9.0	B	9/5		
LEON SCORIELS				935-4624	
Abdell J. <i>(71763)</i> 16200 <i>(20)</i> <i>(4/18/46)</i> 456-4934					25
BATTEY, AL				255-3651	
Graham, H.				879-0745	
hes ("LOVER") TEMPLETON Esq. 24912				242-2360	Wh-381

NAME

TOTAL

CLASS

DATE

BRADY SMITH

4.5

S

10/19

HV 5-9358

522-8122

DON VESLEY

10.0

S

10/8

CHART

PAUL WILLIAMS

12.0

S

9/18

335-1250

522-8223

RICHARD WIEGAND

16.0

S

9/29

Le Clancy, Larry

8/10/79

(Logan)

Wade

8/30/79

Wade, Mike

End

835-8088

835-1190

Wade, Mike (354)

End

835-3064

Wade, Mike

End

835-1120

DAVE FERRIE

I have to fly 1 hour.

Will you wait for me?

The airplane to the
next week

Sunday - 12:00

James