

22 November 1963
1230 CST

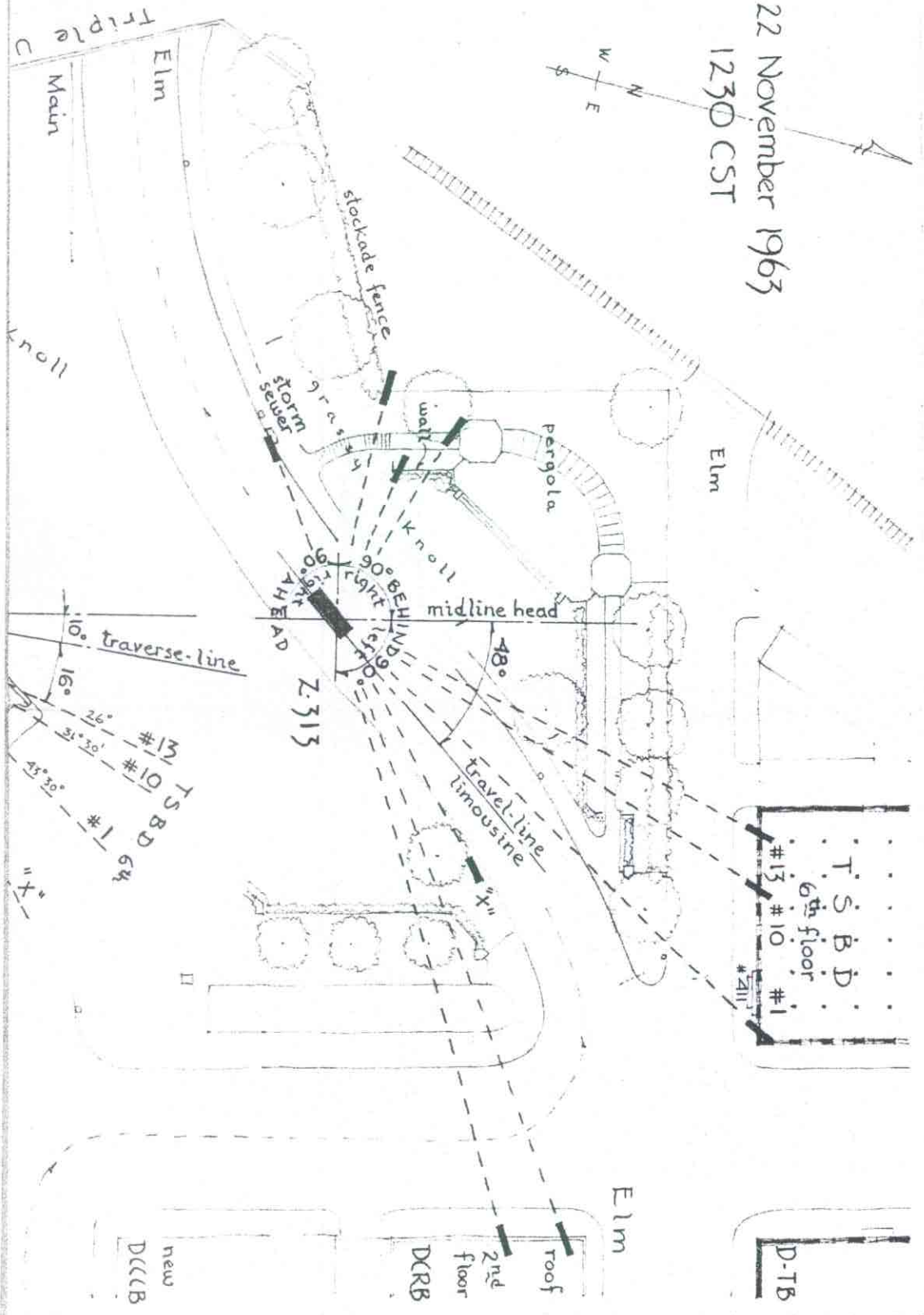
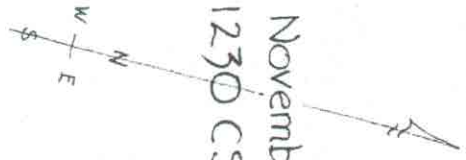

where to explain the forward then rearward motion

vi/16/76 ps. I'm not adamant or angry -
quietly suggestive for thought

Underpass
Commerce

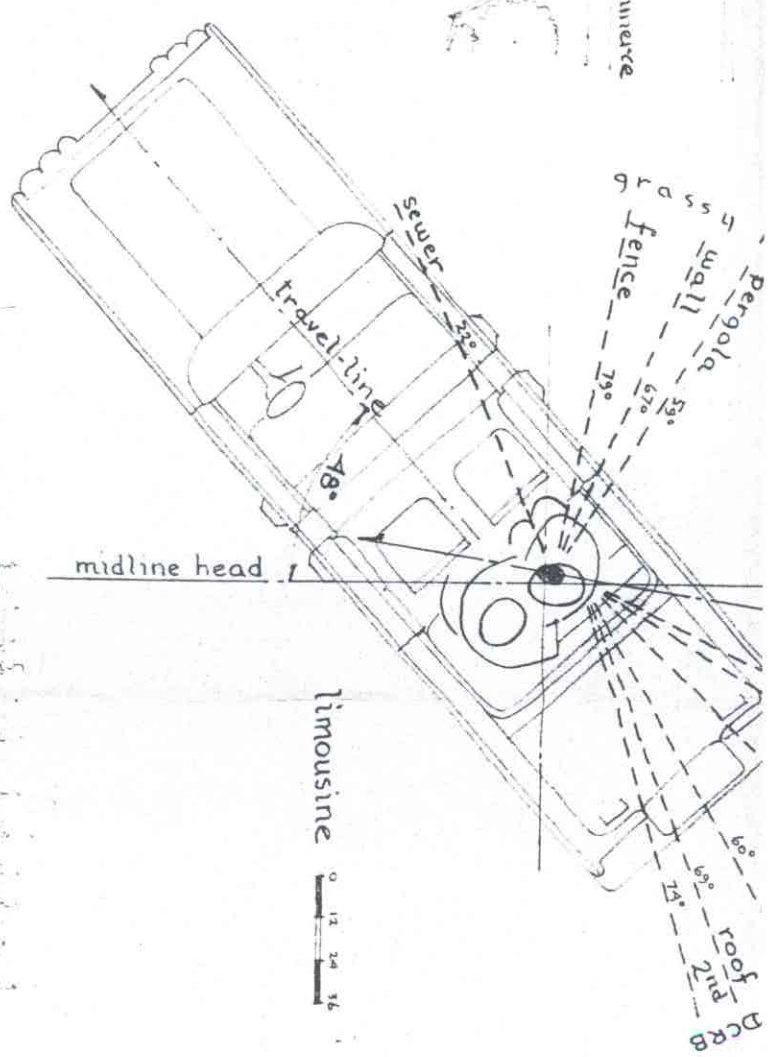

DEALEY PLAZA

DALLAS, TEXAS

11/76

SECOND-RIFLE THEORY

CUTLER DESIGNS

38 Union St Manchester Mass 01944

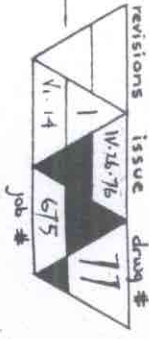

revisions issue drug #

For reference in checking back on the original...
 the main point I would like to suggest, only suggest please,
 is that the hypothesized rifle positions on the grassy knoll do
 not fire bullets from in front of the head at Z-312 and/or Z-313 and/or Z-314
 hence this entire S-RT, second-rifle theory is theory only, and you must look else

#K:
 very gently I submit this for your perusal -
 reference Post Mortem p 81 - right and north are not the same.
 the main point I would like to suggest, only suggest please,
 is that the hypothesized rifle positions on the grassy knoll do
 not fire bullets from in front of the head at Z-312 and/or Z-313 and/or Z-314
 hence this entire S-RT, second-rifle theory is theory only, and you must look else

