

CUTLER DESIGNS

1/2/68 Many thanks for the interesting and worthwhile work. If you do anything with the Nation it will be a pleasant surprise to me.. However, it is the kind of formulayion they should be most willing to go for, In the phrase of the publishing trade.

R. B. CUTLER, ARCHITECT

38 UNION ST. MANCHESTER, MASS. 01944

TEL. 526-1521

In the phrase of the publishing trade.

MESSAGE

REPLY

TO Harold Weisberg

Route 8

Frederick Md 21701

DATE XII/29/68

HW :

enclosed please find the five illustrations to my article which is now being read by the Nation - Saturday Review said it was too technical and Atlantic Monthly said it didn't suit them and my guess is that Ramparts might be the one -- I want to rewrite the words so only pay attention to the drawings which I feel are direct and clear -- I've sent a set to Garrison on the outside chance they might be helpful, one never knows just where good luck in Jan & Feb in NO happy holidayze

of course if you want to use some of the material please check with me as hopefully it may be available soon

SIGNED

Sorry you didn't compute the angle through the President for 399. It is rather a large one, according to an engineer, Whitney Joy, who did. Something like 45 degrees from the autopsy report, which also failed to do it. If I ever am able to publish POST MORTEM, which was ready for the camera more than a year ago, I might want to ask your permission to use some of it. I've now more material to add to it....Please do me a favor. My addressbook was lifted in New Orleans some months ago. With it I lost some number of which I had no other record. There is a fine guy with Bob Scott at WRKO. I think his name is Allan Bickley. I know it is Allan. I'd like him to phone me some night, about the subject of our last conversation, if he recalls that. I was then in New Orleans....Unless the shaw trial is again postponed, I will be there very soon. New rumor, not from N.O.: Percy Foreman has taken Shaw's case. If this is true, that will mean a delay. ..Good luck with your worthwhile project. And have a good year!

Sincerely

SIGNED

The travel-line of the limousine, spotted on Z-186, makes an angle of 17°10' with the flightpath, largest of the five tests..... the President and Governor both face the crowd along the Elm Street sidewalk which establishes the relationship between the former's neck and the latter's right shoulder maintained through the first three tests..... the horizontal angle makes it necessary for CE 399 to zig hard-right, yaw, then zag hard-left to hit the Governor properly.... Even if the Governor is positioned further inboard the bullets gyrations must be fantastic to produce the magical maneuver hardly classifiable in plan as 'alignment'..... To consider the rise in elevation, the yaw, required to effect the 25-degree declination through the Governor's chest is to strain the mind well beyond the allowable boggle-limit

PRESIDENTIAL LIMOUSINE 1963

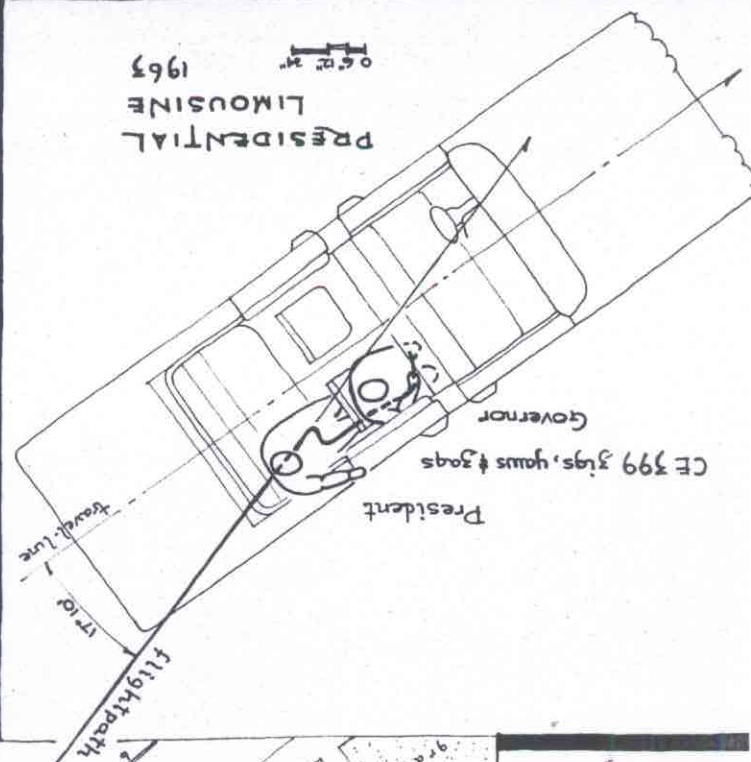

PLAN of NORTH CORNER DEALEY PLAZA

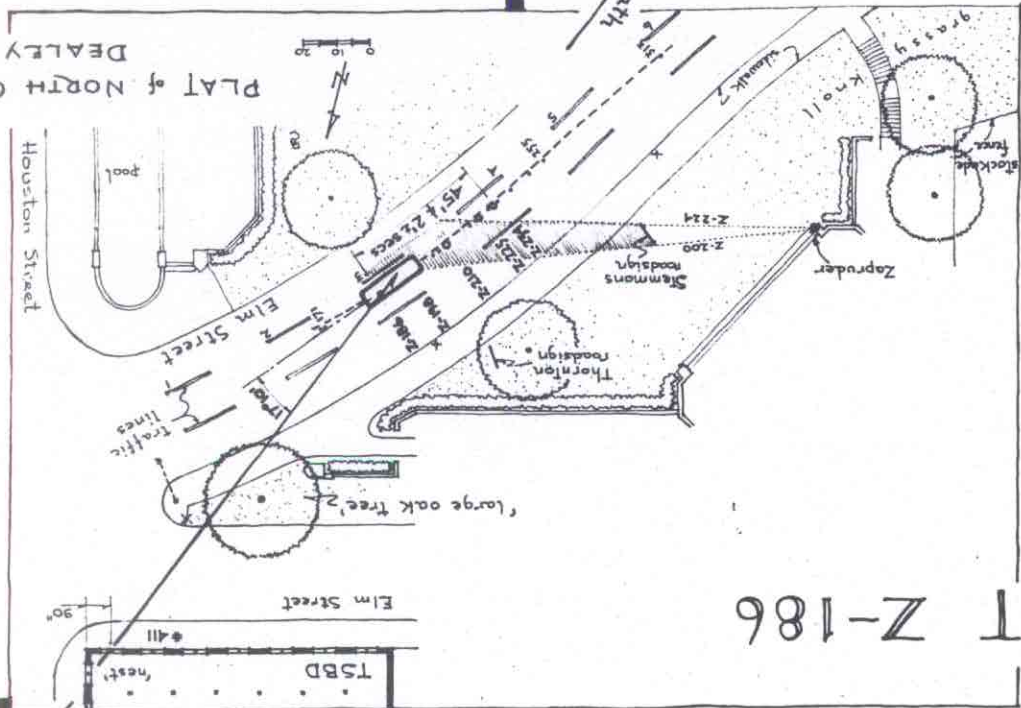

TEST Z-186

FLIGHTPATH of CE 399

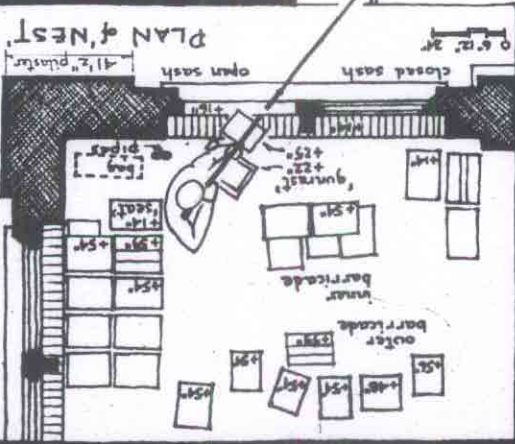

FLIGHTPATH of CE 399

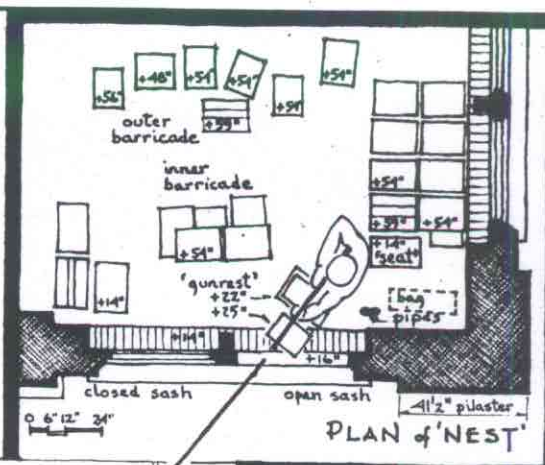

TEST Z-198

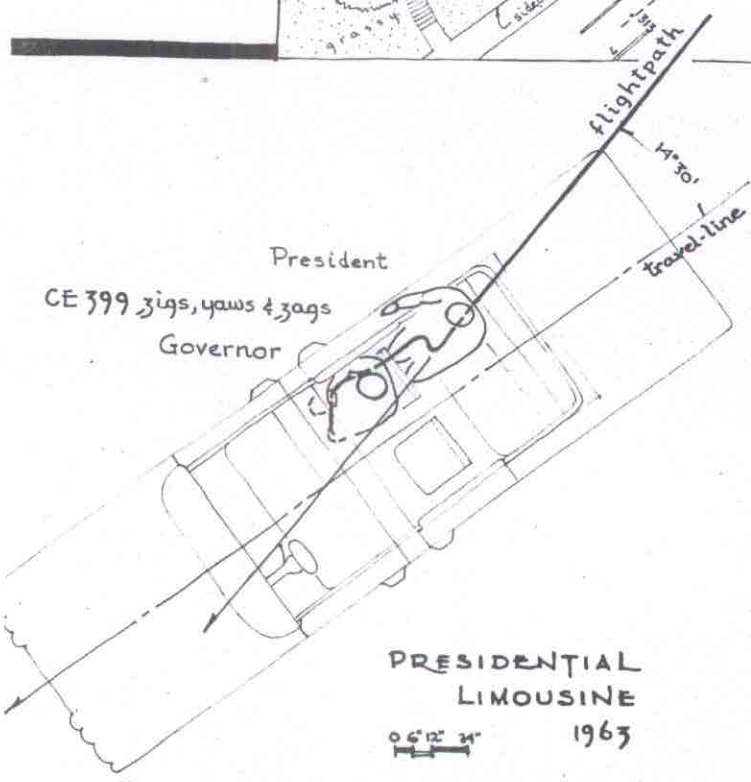
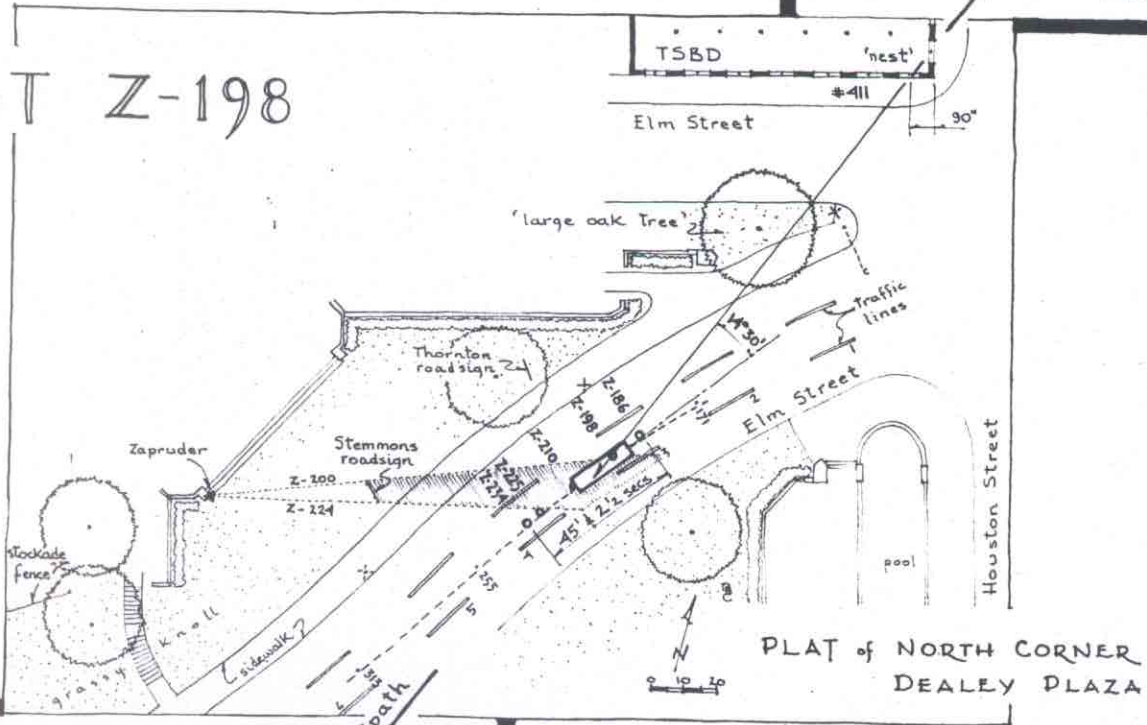

The President is still facing the sidewalk crowd, waving as in the first test; the Governor has turned his head slightly to his right indicating that he has heard the sound of the first shot, which he recognized as such, and is trying to see the President out of the corner of his right eye.

The divergence between the travel-line and the flightpath has narrowed 2°40' to 14°30' which still makes CE 399's extraordinary zig & zag, not to mention the yaw-between, a manoeuvre of monumental intricacy if its assignment is to be carried out as per the Report.

FLIGHTPATH of CE 399

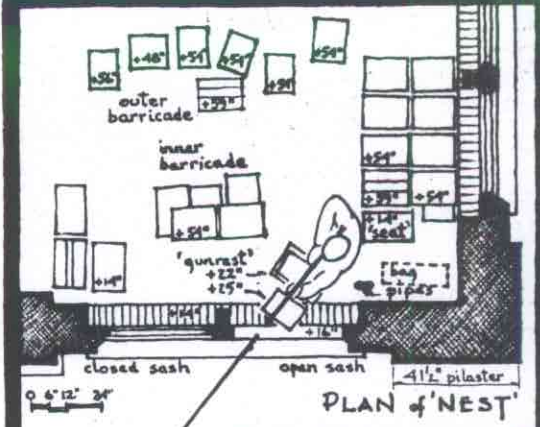

TEST Z-210

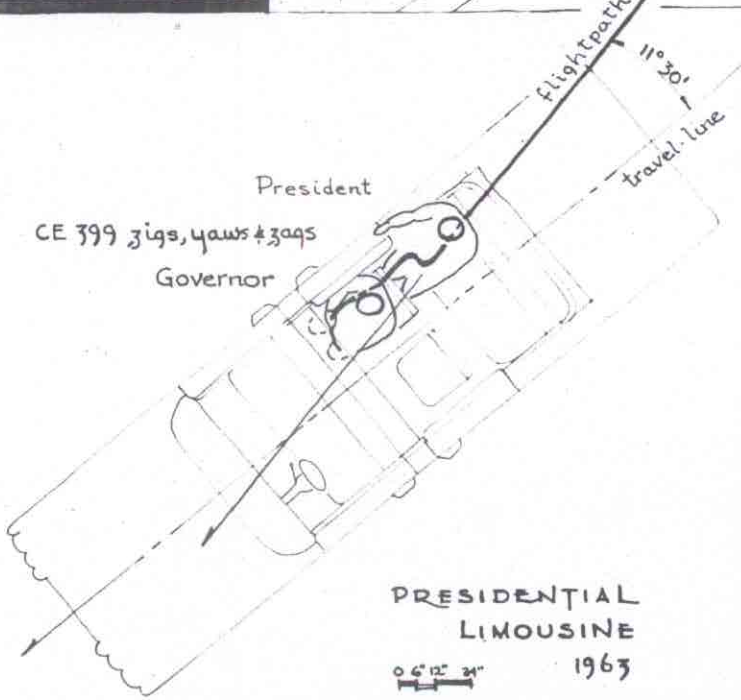
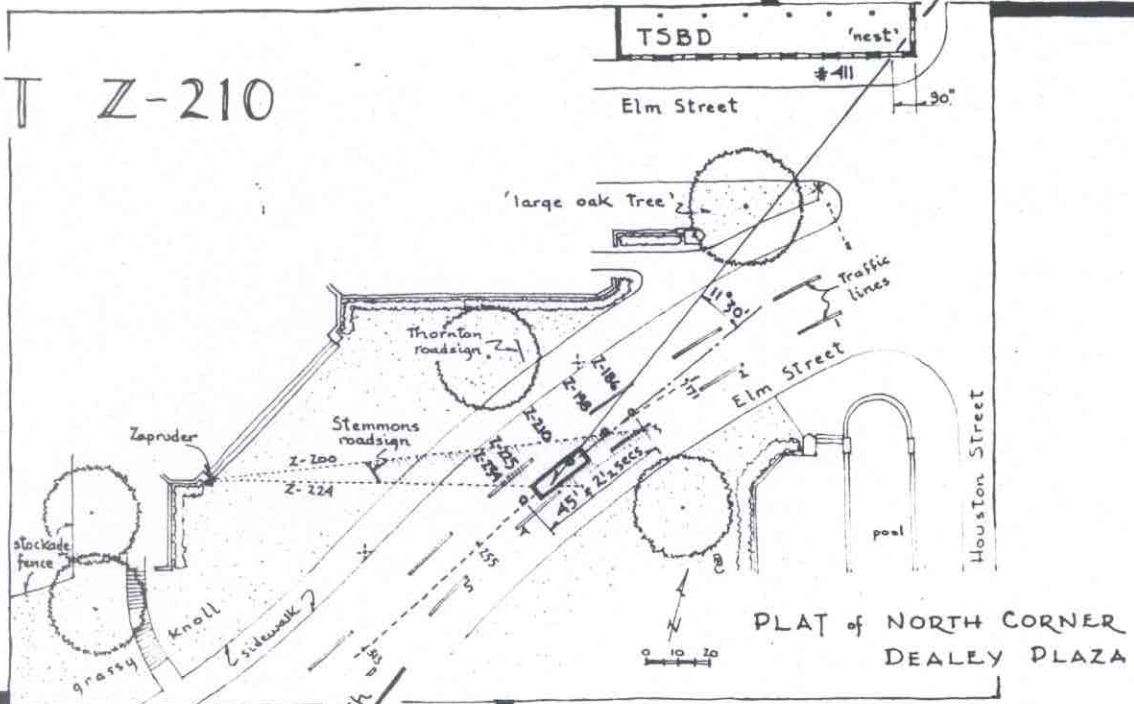

The Stemmons roadsign's 'shadow' blanks out the limousine's seating section rendering it impossible to re-position the President or the Governor. The top of the former's head is all that is visible in this frame and the latter disappeared in the preceding frame; no change is made in either from the Z-198 test.

The travel-line/ flightpath angle has dropped 3° to 11° 30' and presents CE-399 with the easiest zig-zag of all the tests, however yaw is maximized in that it must be accomplished in the minimum amount of space.

Nonetheless the least zig & zag is far beyond the reasonable of how a bullet could, would or should perform.

FLIGHTPATH of CE 399

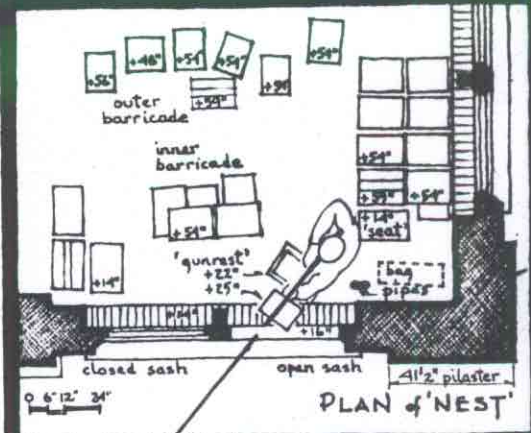

TEST Z-225

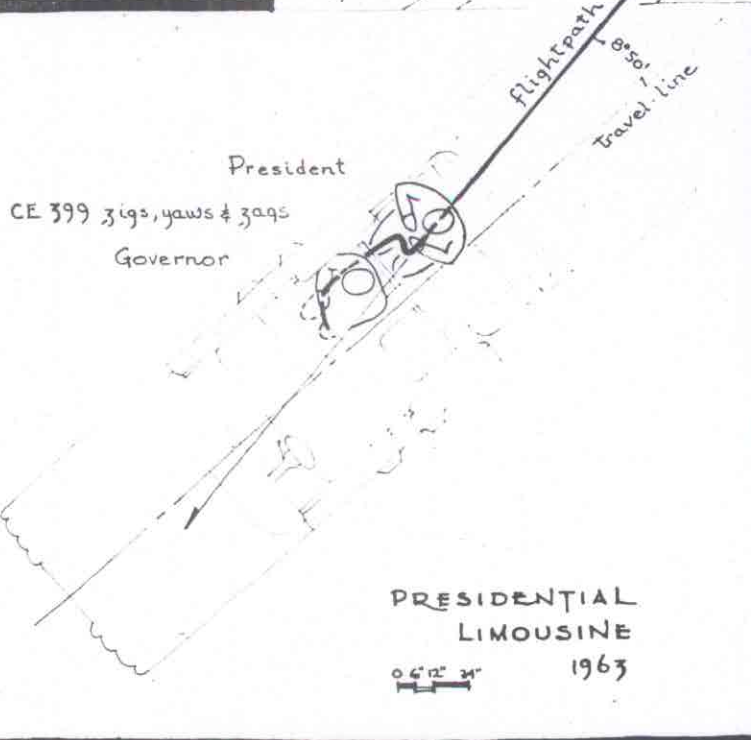
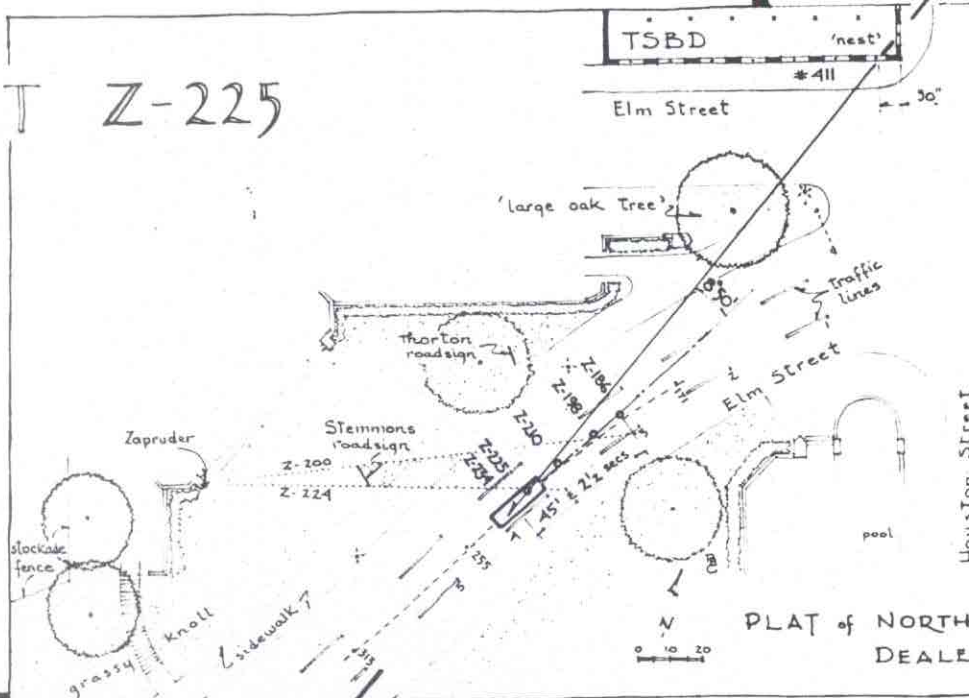

This is the first of two tests wherein an insurmountable difficulty is introduced into the political pattern of the flightpath. The President, in 'barely reacting' to his having been hit, is raising both hands to his throat which is the area of CE 399's activities; the autopsy report makes no mention of hand wounds. The travel-line/flightpath divergence has narrowed to 8'50', close enough to 'alignment' to admit the Single Bullet Theory - given another set of results. Extension of this test's normal flightpath indicates the puncture of the Governor's left lung to be a more suitable alternative to being 'hit by a bullet which entered the extreme right side of his back.' The Governor has started his turn to the left, having failed to glimpse the President out of the corner of his right eye; the President has swayed slightly forward and closer to the travel-line to his left. This widens, as well as shortens, the zig-yaw-zag distance to about the same laterally as Z-186. Thus, to this unconceivable contortion this test adds the successful negotiation of a clear passage between the President's clutching fingers.

FLIGHTPATH of CE 399

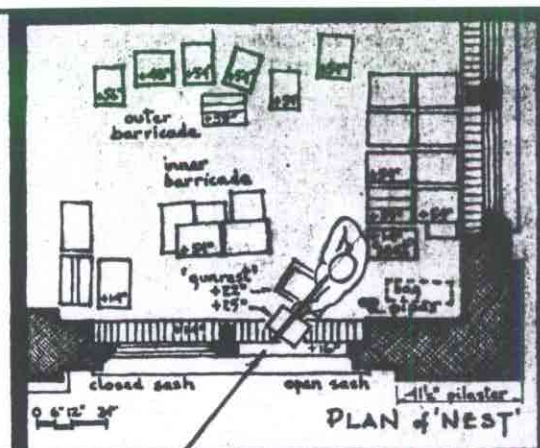

TEST Z-234

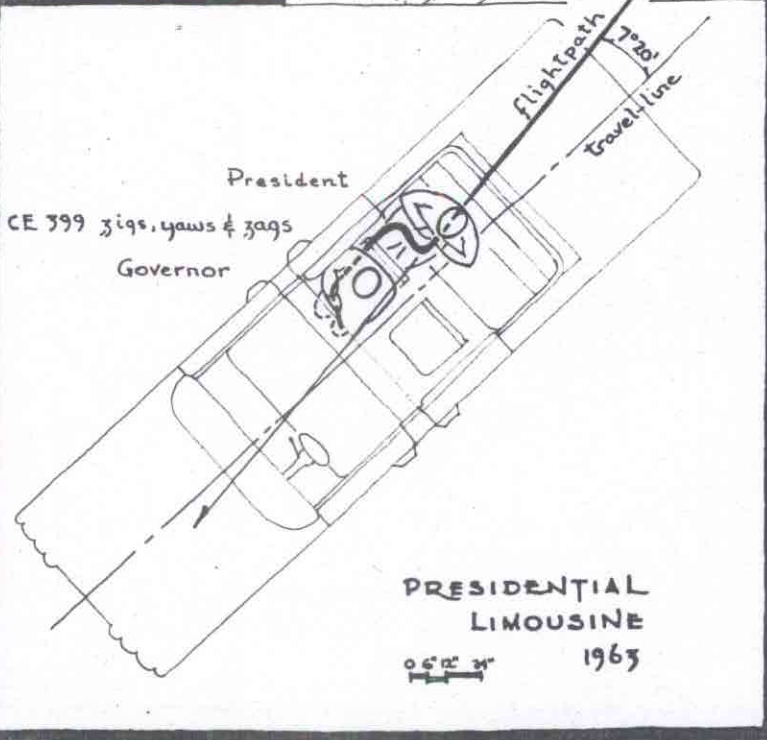
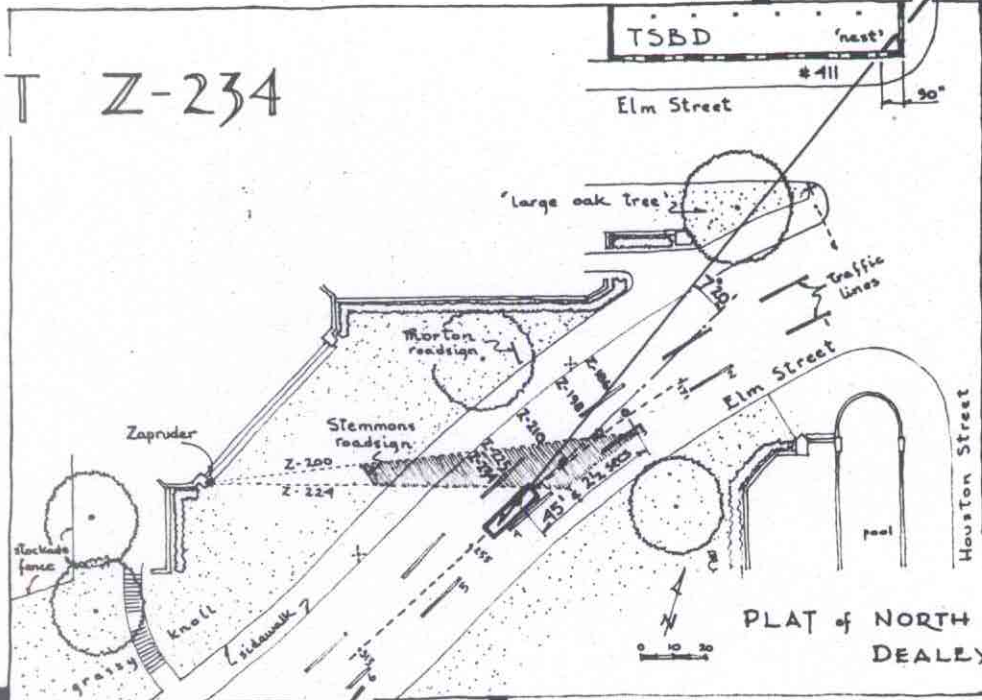

The President's hands are closer about throat; he has leaned farther forward and to his left; the Governor has turned slightly beyond center where he felt something strike him in the back.

This last chance for sober consideration of the Single Bullet Theory presents the maximum zig-yaw-zag routine, the asset of the minimum angle of travel-line/flight-path divergence being more than offset by the liability of the changes in body positions.

Despite the valiant literary efforts of the authors, Assistant Commission Counsels Arlen Specter, Norman Redlich and Alfred Goldberg coupled with Commission-sanctioned nuances of phraseology, the Single Bullet Theory remains nothing but an insult to common sense; its anti-physical zig & zag defying nature and its incredible, climbing yaw floating the imagination. It is totally inimical to the flightpath of any and all bullets - even CE 399; it is pure, unadulterated, ballistical-balderdash deserving only the kindness of instant incineration.