

APPENDIX

Q 202 34030

O

-5

cb-87 [initials]

Q 2 3 0 10

Q

Subject: 115X U. S. ...  
Birm ... film ...  
Kennedy ... sheet

enclosed is ...  
taken by Mr. H. Zepher ...  
exas (KIG-67)

The President ...  
was shown

the address ...  
as ...  
Zepher

Note: ...  
Mr. ...  
film ...  
copy of ...  
"master" ...  
given to Eric Sorels, this ...  
print is forwarded.

M. D. Ph.  
Spec of Ident -

P. 138

66

E/A

1105TH ST

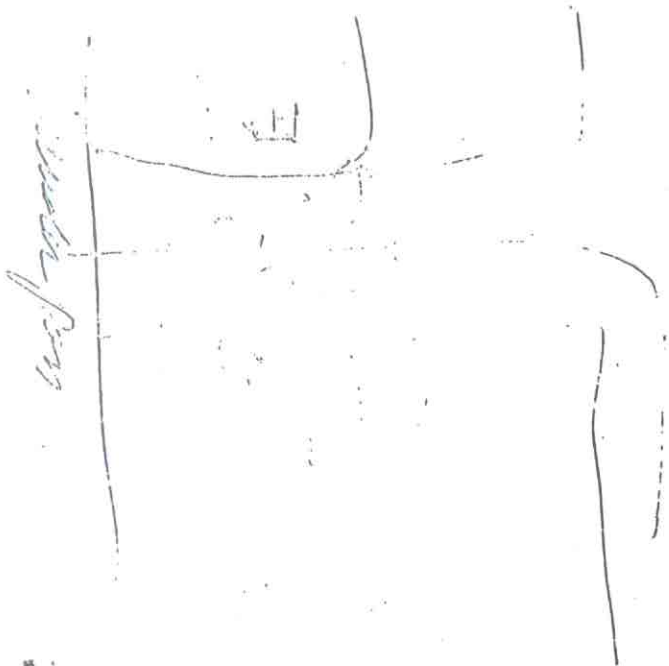

M

65

P. 139

These are the clearest copies that can be made from the very poor copies of the legally and historically important memorandum with which the Zepher movie was sent to Washington.