

THE DALLAS COUNTY HISTORICAL FOUNDATION

DALLAS COUNTY ADMINISTRATION BUILDING
411 ELM STREET DALLAS, TEXAS 75202-3301 (214) 749-6666

December 28, 1987

*Replied by hand
1/3/88*

Ms. Sylvia Meagher
302 W. 12th Street, Apt. 15-D
New York, NY 10014

Dear Ms. Meagher:

The Dallas County Historical Foundation is currently finalizing plans for the creation of a permanent historical exhibit on the Kennedy assassination which will be installed on the 6th Floor of the former Texas School Book Depository. I enclose a synopsis of content for your review. The exhibit is scheduled to open in early November or early December, 1988.

Many books and articles have been written over the years which offer criticisms of the official investigations into this crime, and today some 85% of the country believes that President Kennedy was killed as a result of conspiracy.

The historical role of these researchers will be included in the exhibit, and we would appreciate your views as to the major contributions that have been made by them in this regard.

Your insights will help us present a balanced historical analysis to our large world audience.

I welcome your questions and hope that you will not hesitate to call or write. Our new phone number is (214) 653-6666.

Best wishes for the new year.

Sincerely,

Conover Hunt

Ms. Conover Hunt
Project Director

DIRECTORS
MRS. REUBEN H. ADAMS
MRS. CHARLES D. AGEЕ
MR. PEDRO AGUIRRE
MRS. LILLIAN M. BRADSHAW

MRS. JOHN CHENEY
MR. WILLIAM E. COLLINS
MR. JOE M. DEALEY, SR.
MR. JESS HAY
MR. REX JOBE

DR. GLENN LINDEN
MR. BOONE POWELL, SR.
MRS. ROBERT POWER
MS. MEG READ
MAJOR GENERAL HUGH ROBINSON
UNITED STATES ARMY - RETIRED

MR. GENE SPARKS
MR. JIM WASHINGTON
EX-OFFICIO MEMBERS
MR. JOHN CRAIN
DR. THOMAS SMITH

THE SIXTH FLOOR DALLAS, TEXAS

NORTH SIDE

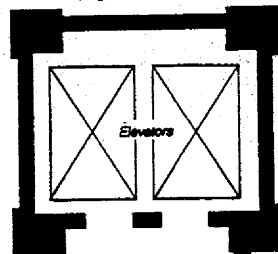

14'

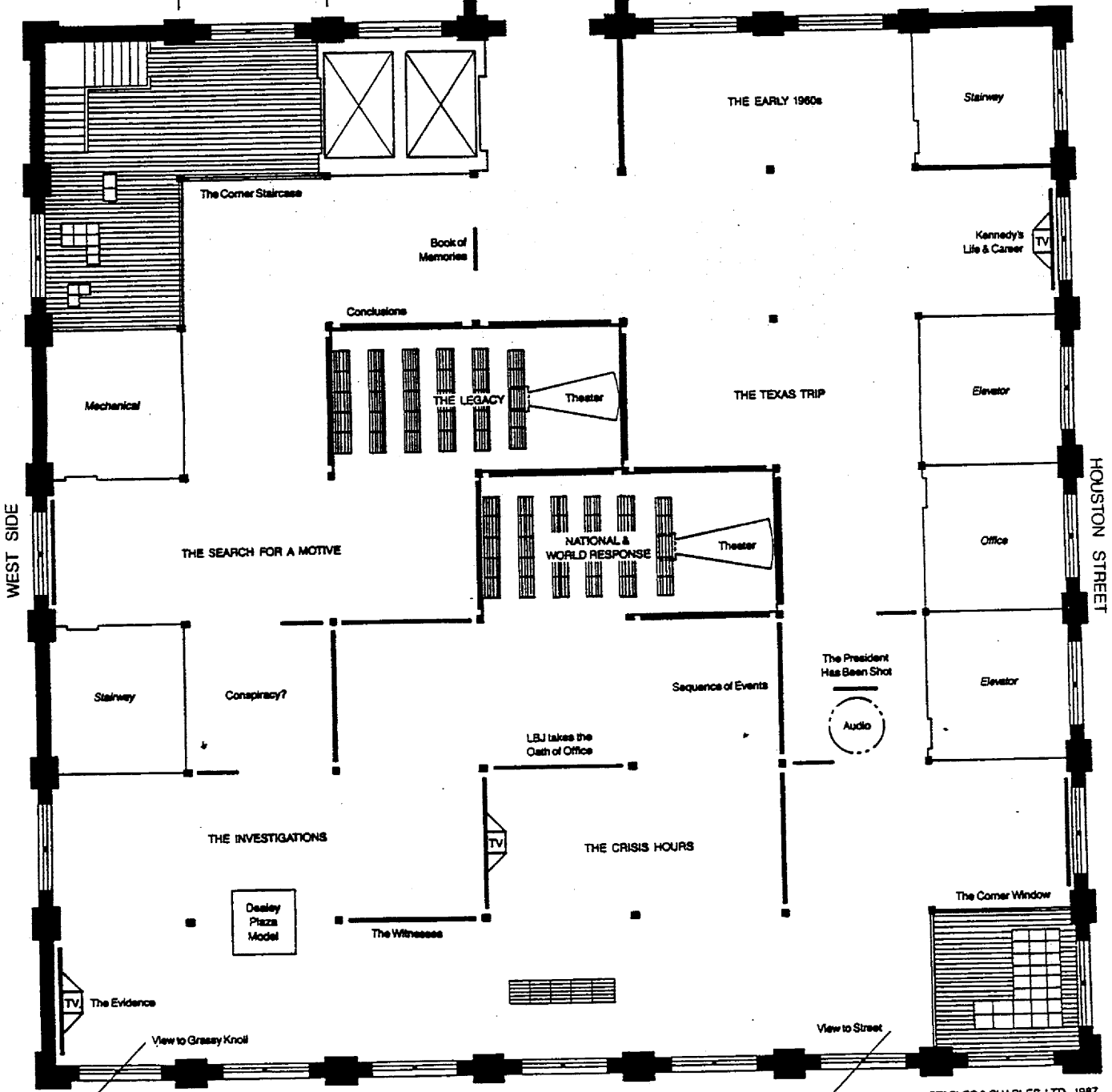

DEALEY PLAZA

STAPLES & CHARLES, LTD., 1987.

TECHNICAL CONSULTANTS, DESIGNERS, ARCHITECTS

Mrs. Reuben H. Adams - President, Dallas County Historical Foundation

- Chairman, Dallas County Historical Commission (1975 - 1982)
- President/Chairman, Dallas Historical Society (1981 - 1982); Texas Heritage Council (1977 - 79) Dallas County Heritage Society (1973 - 74); Dallas American Revolution Bicentennial Heritage Chairman (1976).
- Recipient of eleven major preservation and civic awards (1978 - 1987), including the 1978 Linz Award.
- Board of Trustees for 21 civic organizations, 1982 - 1987.

Conover Hunt - Project Director

- Consultant to museums on management, collections and exhibits (1974 - present).
- Chief Curator, Dallas Historical Society (1980 - 82)
- Curator, DeGolyer Estate (1978 - 80)
- Director, DAR Museum, Washington, D.C. (1974 - 75)
- Curator, Association for Preservation of Virginia Antiquities, Richmond (1971 - 74)

Staples & Charles, Ltd. - Exhibit Designers

- Robert Staples and Barbara Charles, principals.
- Designers of permanent museums, temporary and traveling museum exhibitions, books and films for a broad range of organizations.
- Major projects: Gerald R. Ford Museum (1981); *We The People* (National Museum of American History Bicentennial exhibit 1975); *Chicago History Galleries* (Chicago Historical Society 1979); *The American Cowboy* (Library of Congress, 1983).

Hendricks, Nyfeler & Callaway - Elevator Access Architects

- James L. Hendricks, FAIA, principal.
- Restoration/renovation projects- Old Cumberland Hill School (SEDCO), DeGolyer Estate, Belo Mansion, Old City Park, Texas Governor's Mansion.
- Renovation of former Texas School Book Depository, 1979 - 1981.

Eugene George, AIA - 6th Floor Architect

- Professor of Architecture, University of Texas, Austin, 1975 - present
- Resident Architect, The Colonial Williamsburg Foundation, 1971 - 73.
- Committee on Historic Buildings, AIA; former Texas State Preservation Coordinator; Texas Society of Architects Committee on Historic Resources.

E.B. Brown - Security Consultant

- President, E.B. Brown & Associates Museum Advisors
- Director of Building Services/Security, Kimbell Art Museum, Fort Worth., 1969 - 1984.
- President/Chairman, American Museum Association Security Committee 1974 - 1985.
- President, International Committee on Museum Security, ICOM, Paris

Thomas Taylor - Structural Consultant

- Major projects include public and historic buildings- City Place, Tarrant County Courthouse, Texas Governor's Mansion, and the Dallas County Administration Building.

Adah Leah Wolf - Assistant Project Director

- Consultant to museums on care of collections and administration, 1986 - present.
- Curator, Texas Historical Commission, at the Sam Rayburn House Museum, 1982 - 86.
- Education Coordinator, Arizona State Museum, University of Arizona, 1981.

THE SIXTH FLOOR EXHIBIT CONTENT

1960's

This section of the display will place the era into historical perspective by outlining the major social movements of the times, the dominant lifestyles and fashions of the era, and the national and international milieu. A part of this introductory section will outline the life and career of John F. Kennedy. There will be a short video which, like others in the display, will have a contemporary newscaster over view and will incorporate historic film and photographic footage.

The Texas Trip

This short part of the exhibit re-examines the reasons for the trip to Texas and will use another video with historic film footage to recreate the enthusiastic reception that the Kennedys received in Texas.

The Corner Window

This accurate recreation of the southeast window area as it looked on November 22 will be further explained with adjacent photographic enlargements, and supporting radio and tickertape documentation of the first news of the assassination. There will be no public access to the actual window area and no original evidence will be displayed.

Views Into Dealey Plaza

Simple access to the sixth floor itself and experiencing the views into the park below speak volumes about the event. All south-facing windows will be available for viewing, with informative graphics to place the event into perspective.

The Crisis Hours

The events of the weekend, from Friday noon until noon on Monday, will be outlined in this section. A news video unit will summarize the events up to the funeral. Along one wall will be a full chronology explaining the sequence of events as they unfolded in Dallas, Washington, and elsewhere.

At the back of this section will be a seated theater with a ten-minute analysis of the national and world reaction to the assassination. This will include pertinent clips from the funeral, plus seldom seen material about prayer vigils in India and torchlight parades in Germany. Individual reflections on this impact will be incorporated as well.

Adjacent to the theater will be visuals of the swearing-in of President Johnson and the beginning of the first investigations into the crimes.

The Investigations

There have been four official investigations into the event, beginning with the first local and FBI investigations in November, 1963. This section will place the investigations in historical sequence, outlining the participants, the procedures and the major findings.

At the southwest corner of the floor will be visuals relating to the witness testimony suggesting a second gunman near the grassy knoll (visible from the display at this point), plus a carefully produced video that explains the evidence examined by each of the major investigations. Suitable still photographs relating to evidence will be shown in this area as well. All material will be carefully screened for accuracy. There will be a diorama showing the location of key witnesses and photographers who were in Dealey Plaza at the time of the assassination.

The Search For a Motive

Nearly 85% of the public believes that the President was killed as a result of conspiracy. Who the possible conspirators could have been, as well as their motives, will be discussed in this section. Some of the conclusions of the various investigations into this event have been harshly criticized over the years. The nature of the criticisms will be explained historically, and this section will contain the results of recent national polls.

The Legacy

The second seated theater in the display deals with the long-term meaning of the assassination. Kennedy's legacy of hope and the questions about the real impact of this event on American and international thought will be explored. Better laws and a more careful effort to protect national leaders are among the positive results of this event, and this will be included in the film. Reflections of national leaders with hopeful predictions for the future will give a positive note to the conclusion of the formal display.

The Corner Staircase

This last evidential area where the sniper exited and where the rifle and clipboard were found will be recreated.

Conclusion

Since the primary purpose of the exhibit is to provide an accurate overview of events, and to let the public have access to this major part of its own history, this section will give the visitor an opportunity to communicate his own historical message. Memory books, allowing visitors to write their comments, will be available. As books are filled, they will become a part of the display for others to study.