

This briefing book belongs in
62 19060-EBF2654X

THE ASSASSINATION OF
PRESIDENT JOHN F. KENNEDY

NOVEMBER 22, 1963



BUS AND TAX
EXHIBITS

FEDERAL BUREAU OF INVESTIGATION
UNITED STATES DEPARTMENT OF JUSTICE
John Edgar Hoover, Director

EXHIBIT NO. 1 - RIGHT SIDE, FRONT, OF BUS 433, DALLAS TRANSIT COMPANY.

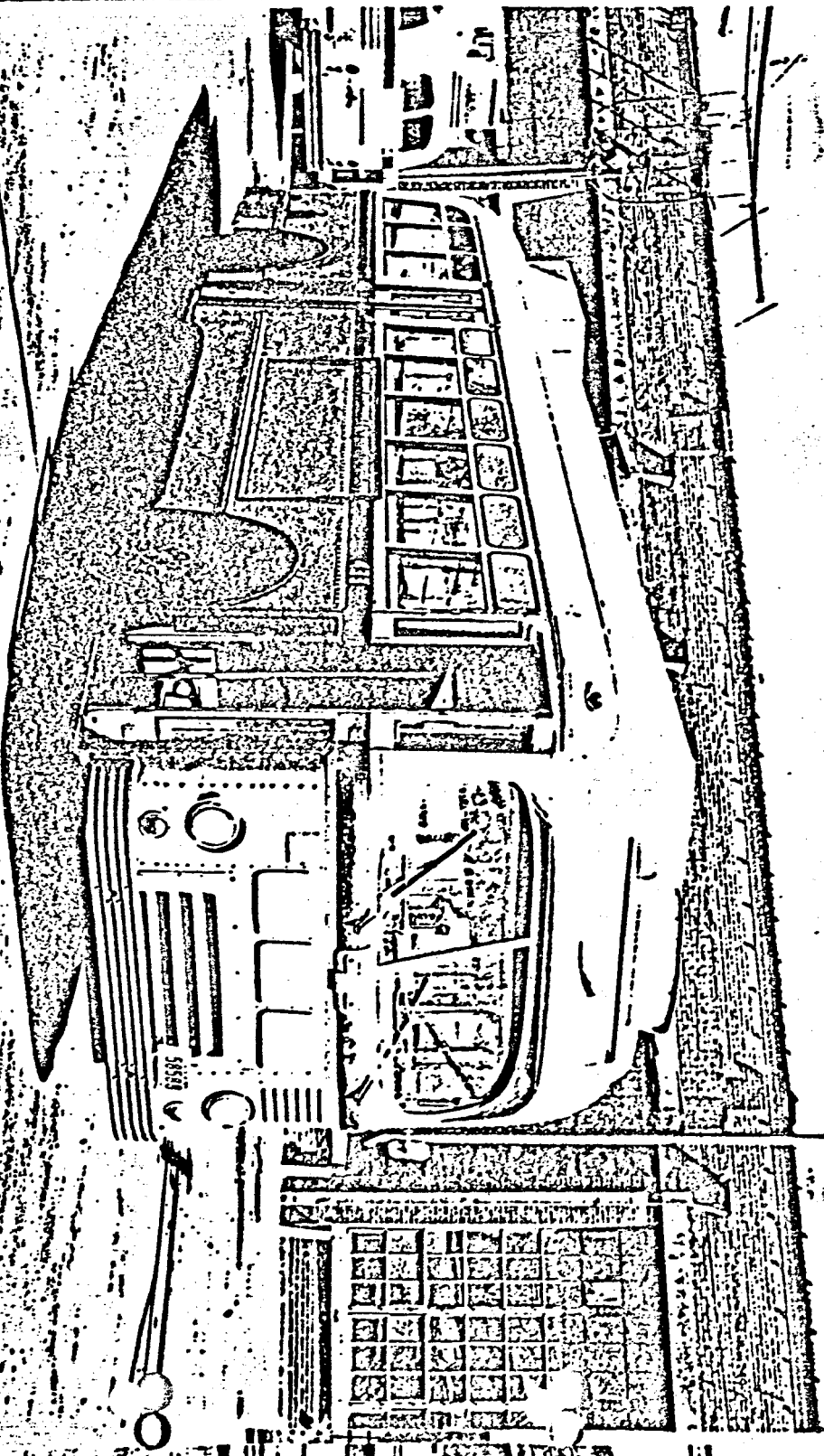

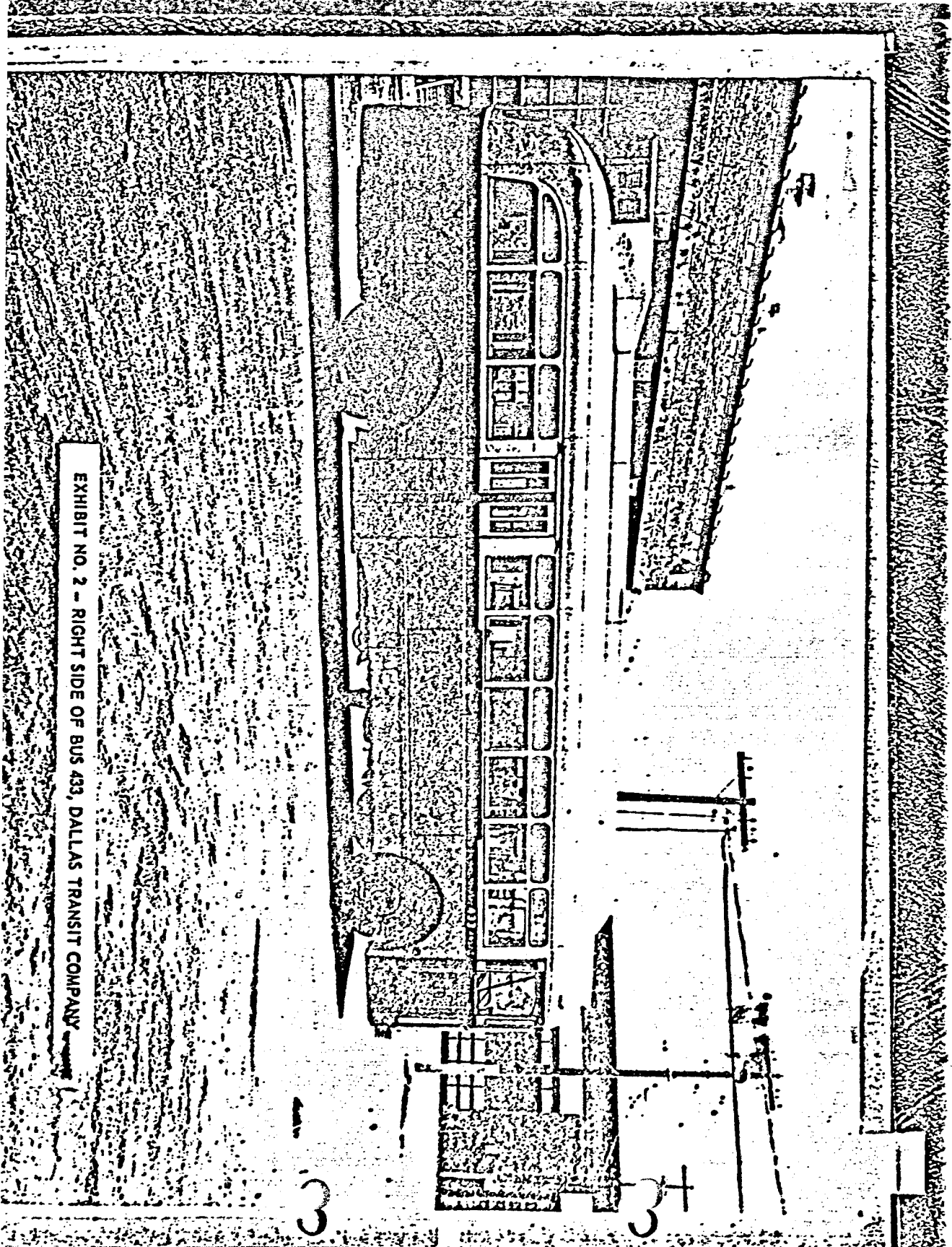

EXHIBIT NO. 2 - RIGHT SIDE OF BUS 433, DALLAS TRANSIT COMPANY

3

3

EXHIBIT NO. 3 - RIGHT SIDE, REAR, OF BUS 433, DALLAS TRANSIT COMPANY.

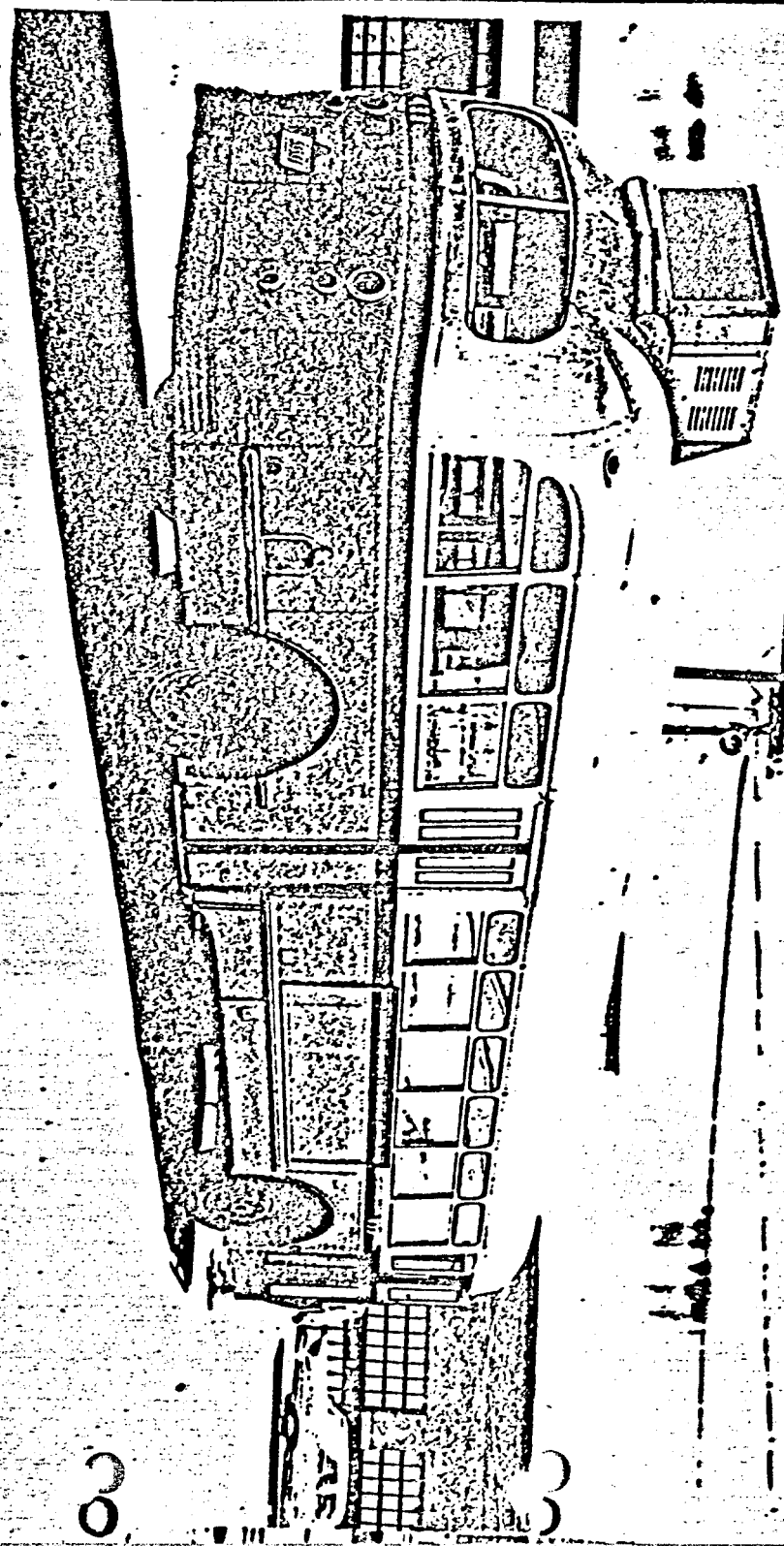
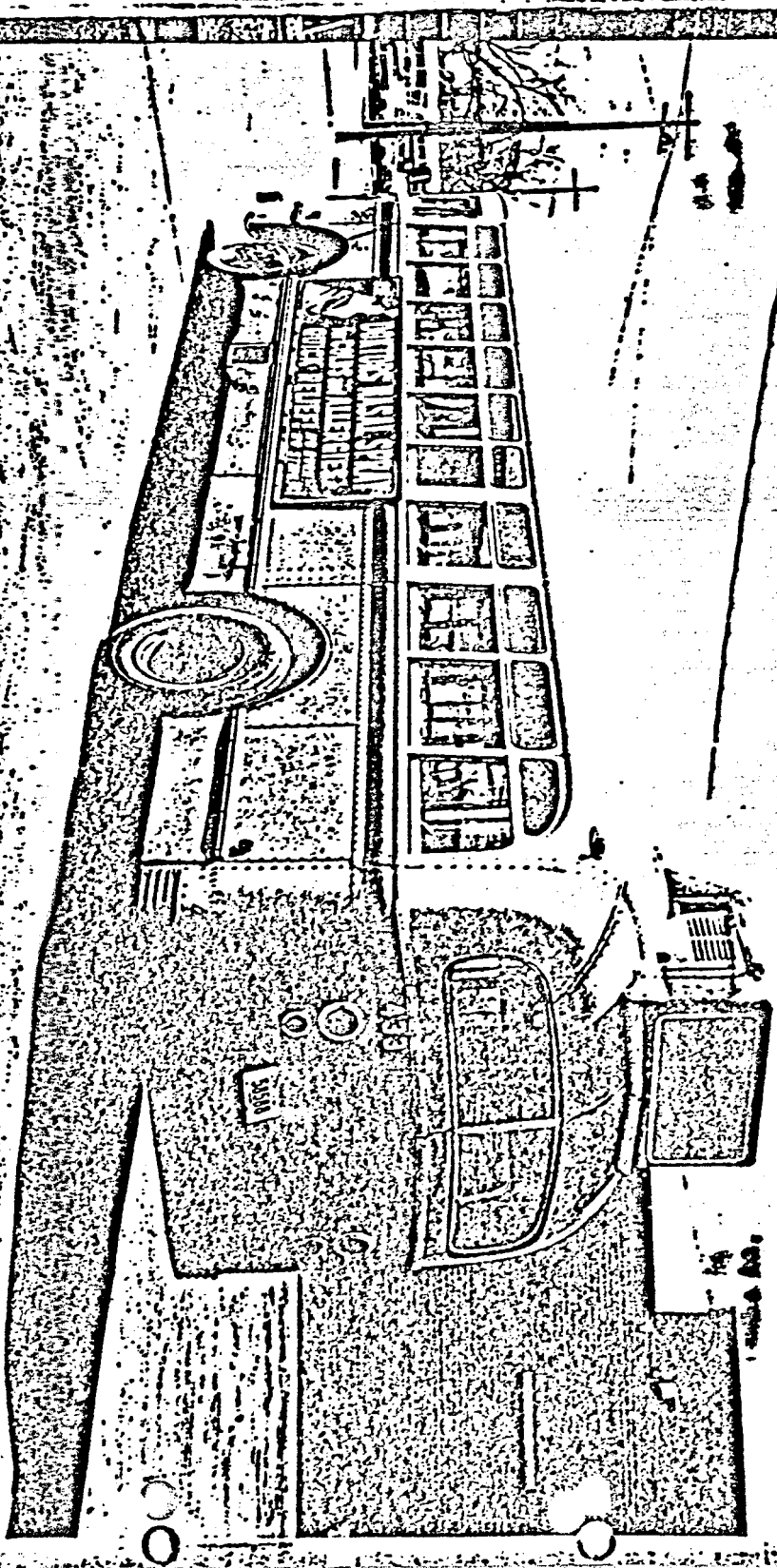

EXHIBIT NO. 4 - LEFT SIDE, REAR, OF BUS 433, DALLAS TRANSIT COMPANY.



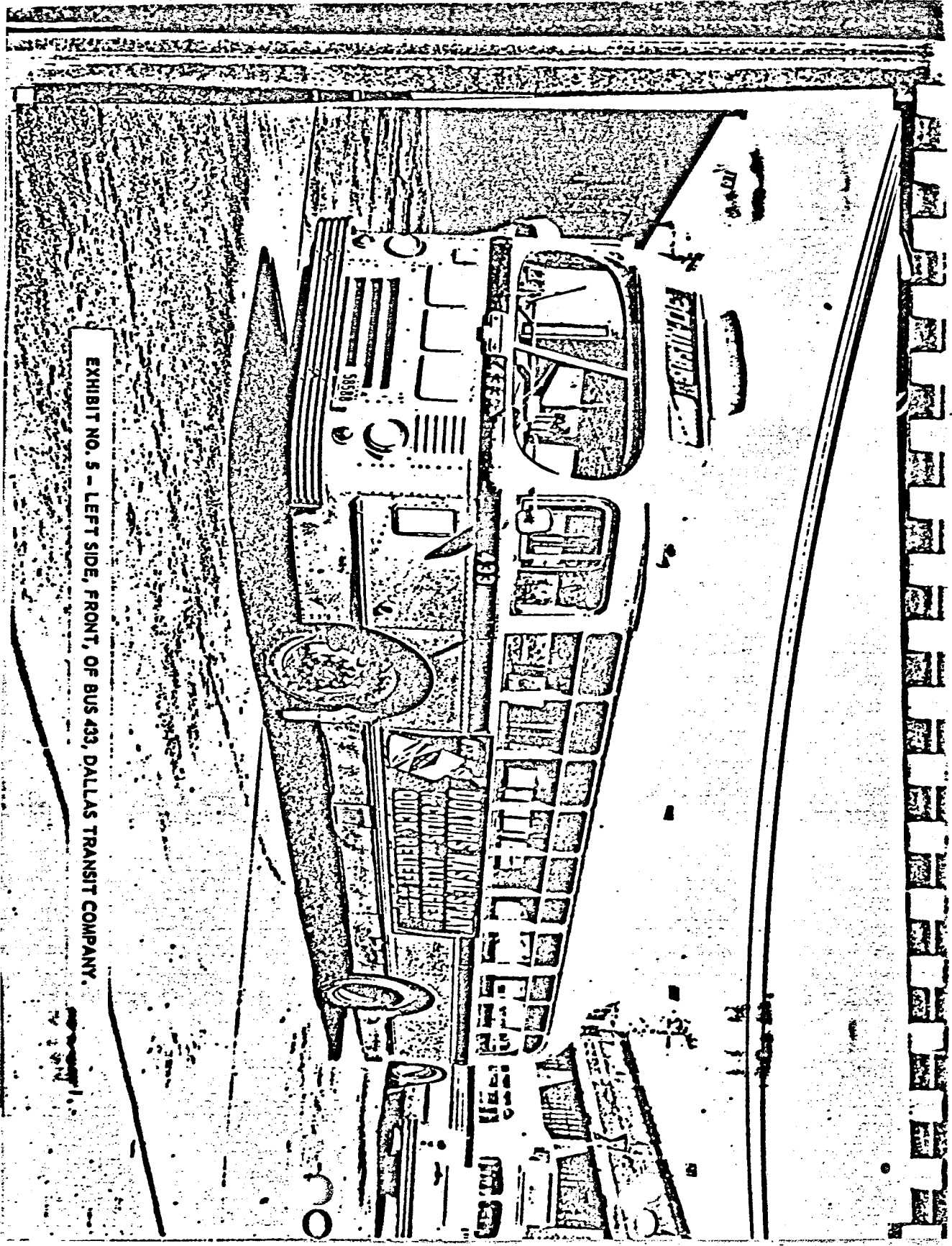

EXHIBIT NO. 5 - LEFT SIDE, FRONT, OF BUS 433, DALLAS TRANSIT COMPANY.

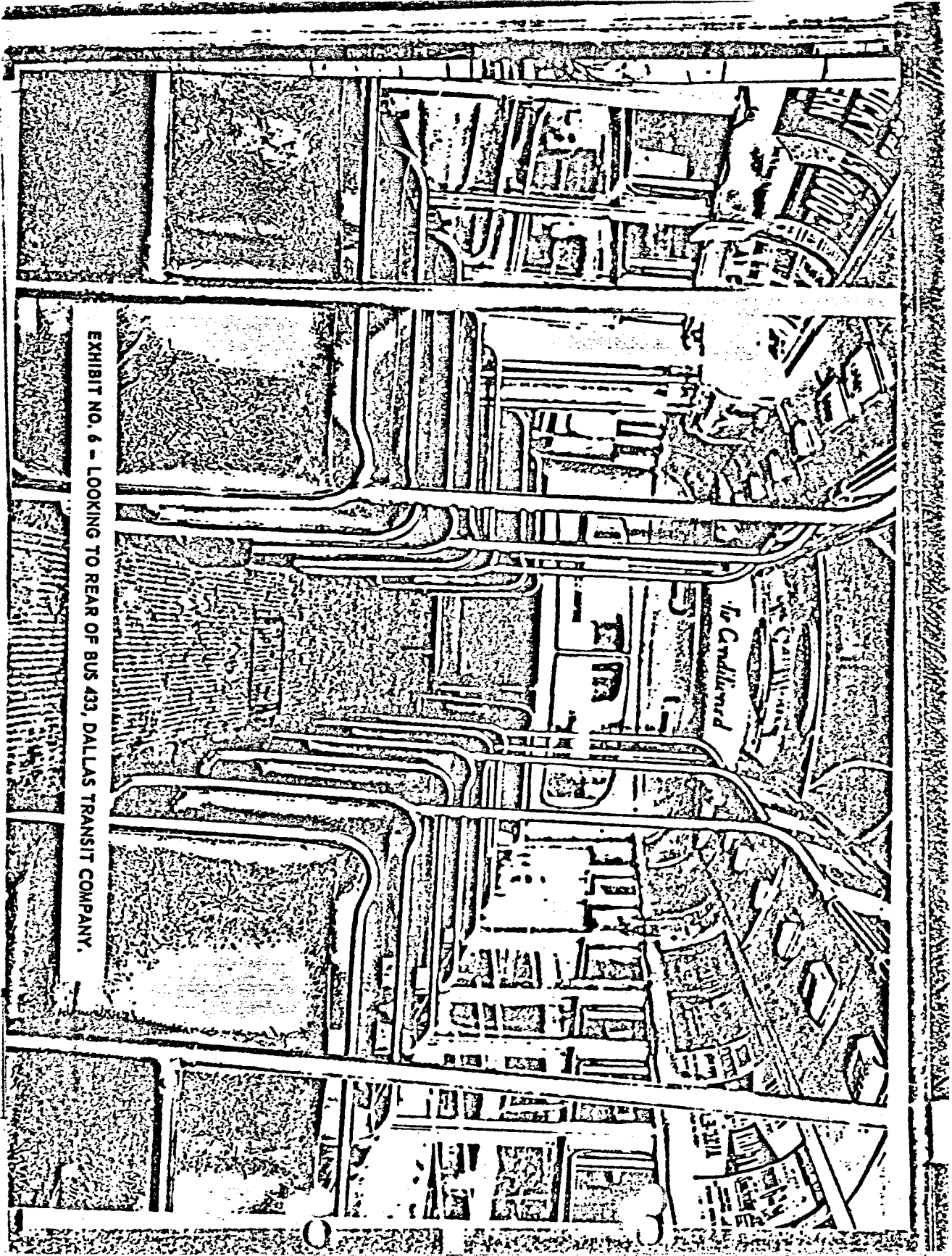
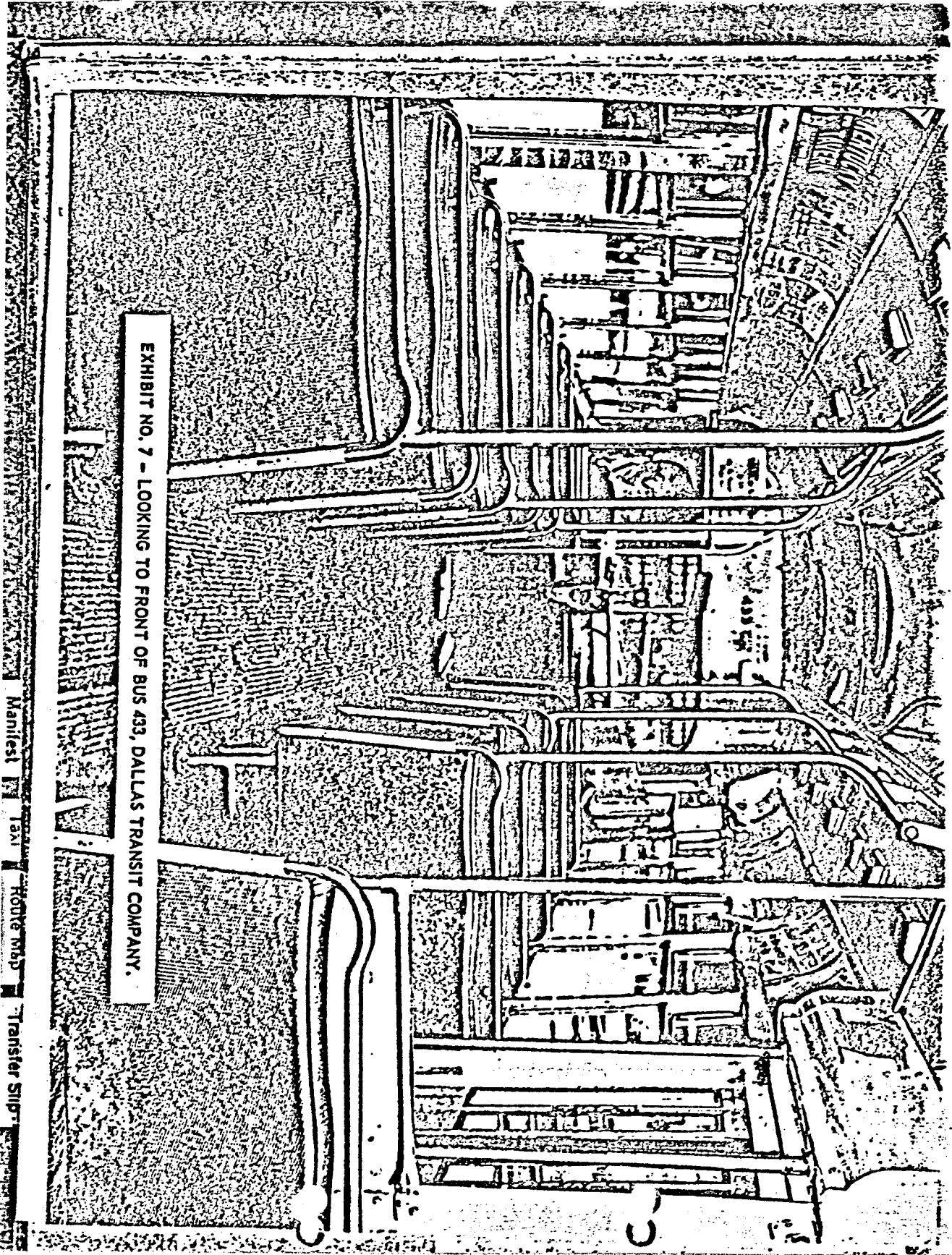

EXHIBIT NO. 6 - LOOKING TO REAR OF BUS 433, DALLAS TRANSIT COMPANY.

to Condensed

EXHIBIT NO. 7 - LOOKING TO FRONT OF BUS 433, DALLAS TRANSIT COMPANY.



Manifest Taxi Route Map Transfer Slip

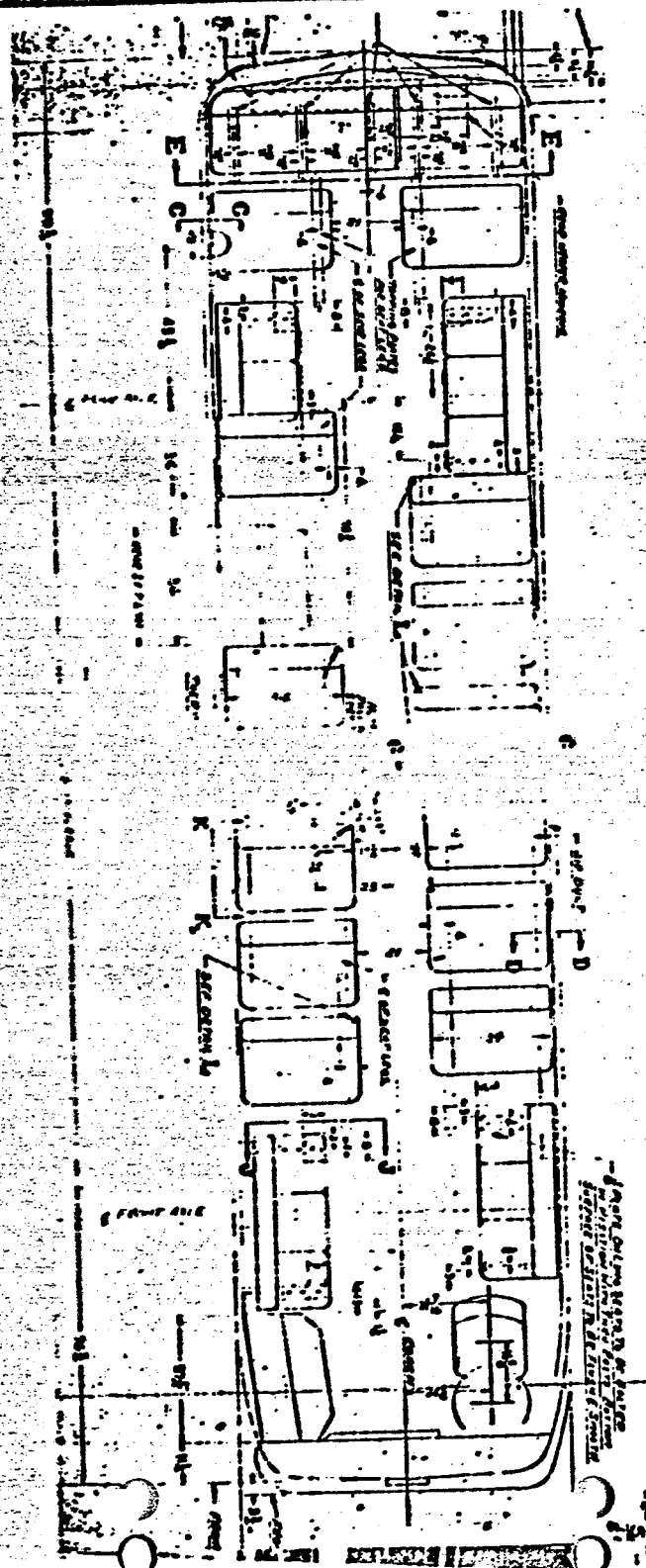

EXHIBIT NO. 8 - TYPICAL BUS SEATING ARRANGEMENT PLAN USED IN BUS 433, DALLAS TRANSIT COMPANY.

509 1/10/64

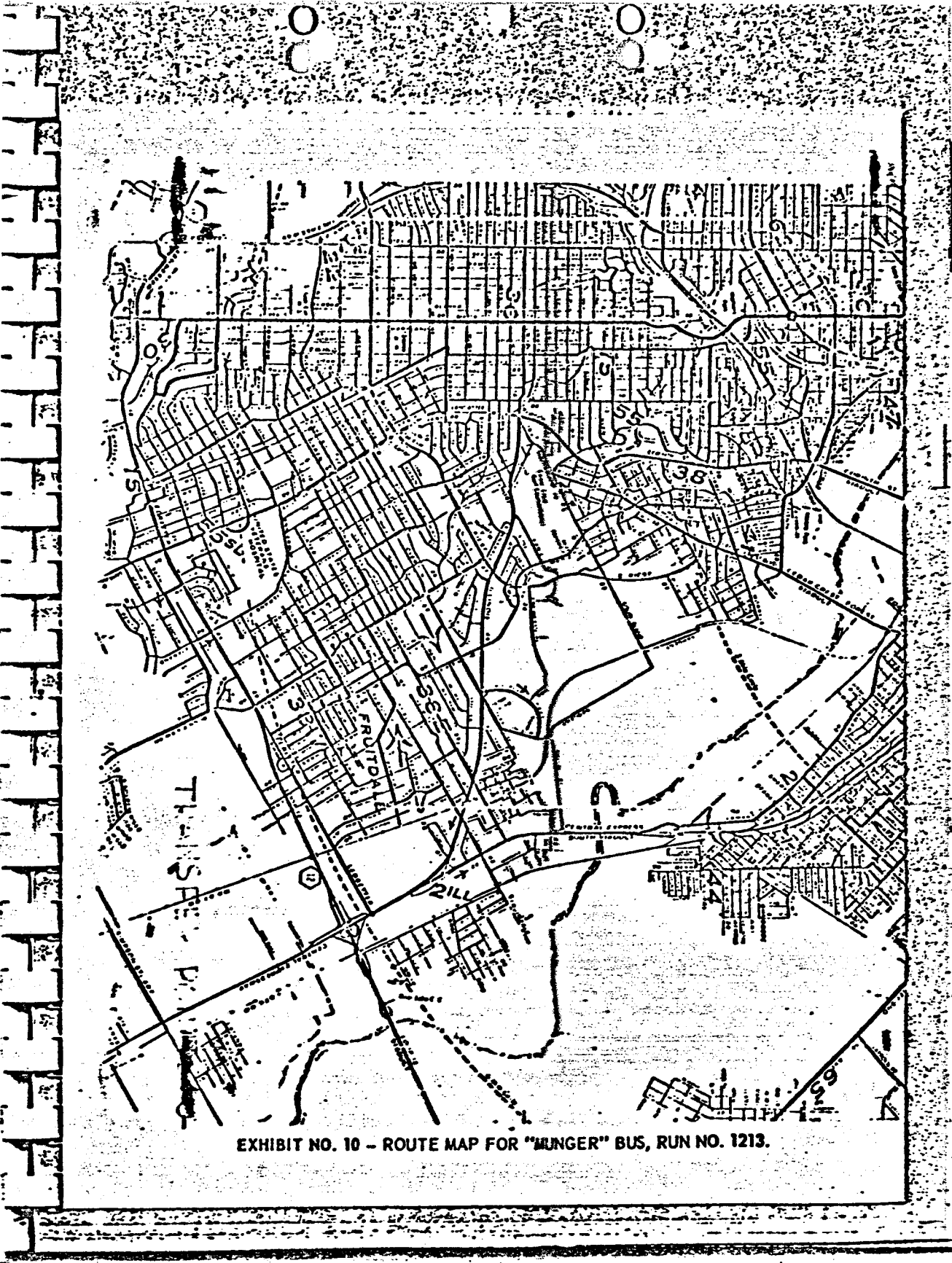
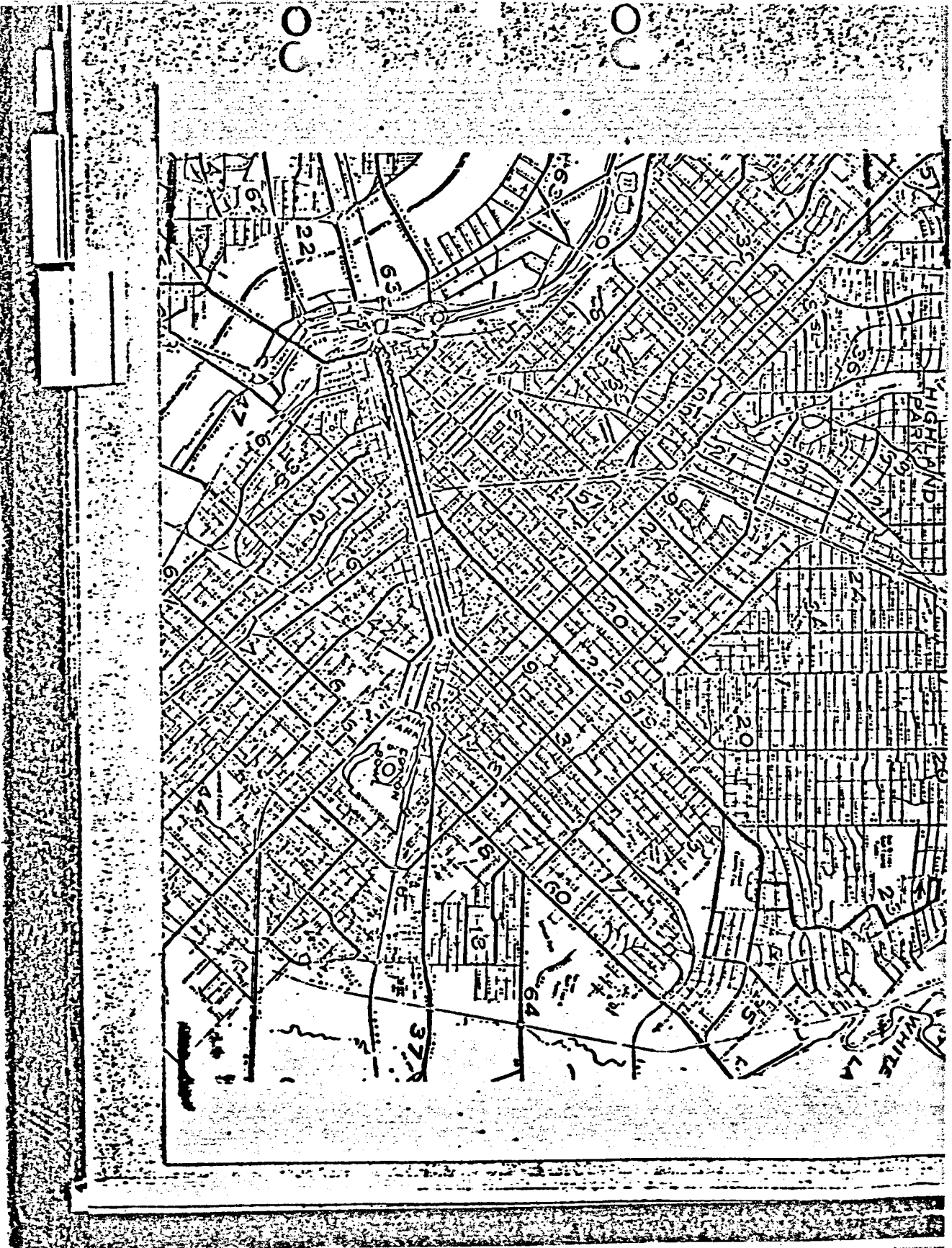
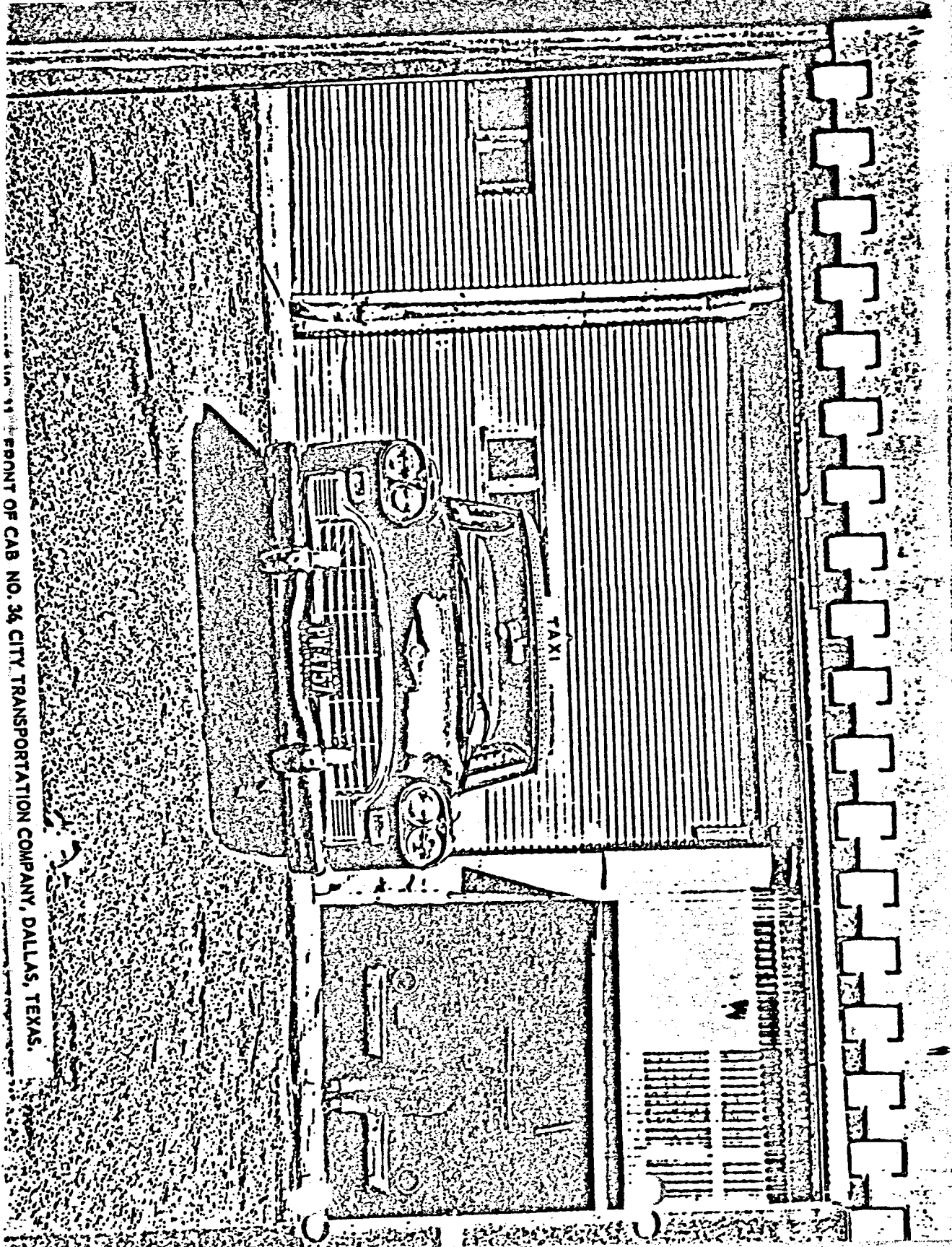

EXHIBIT NO. 10 - ROUTE MAP FOR "MUNGER" BUS, RUN NO. 1213.





FRONT OF CAB NO. 36 CITY TRANSPORTATION COMPANY, DALLAS, TEXAS.

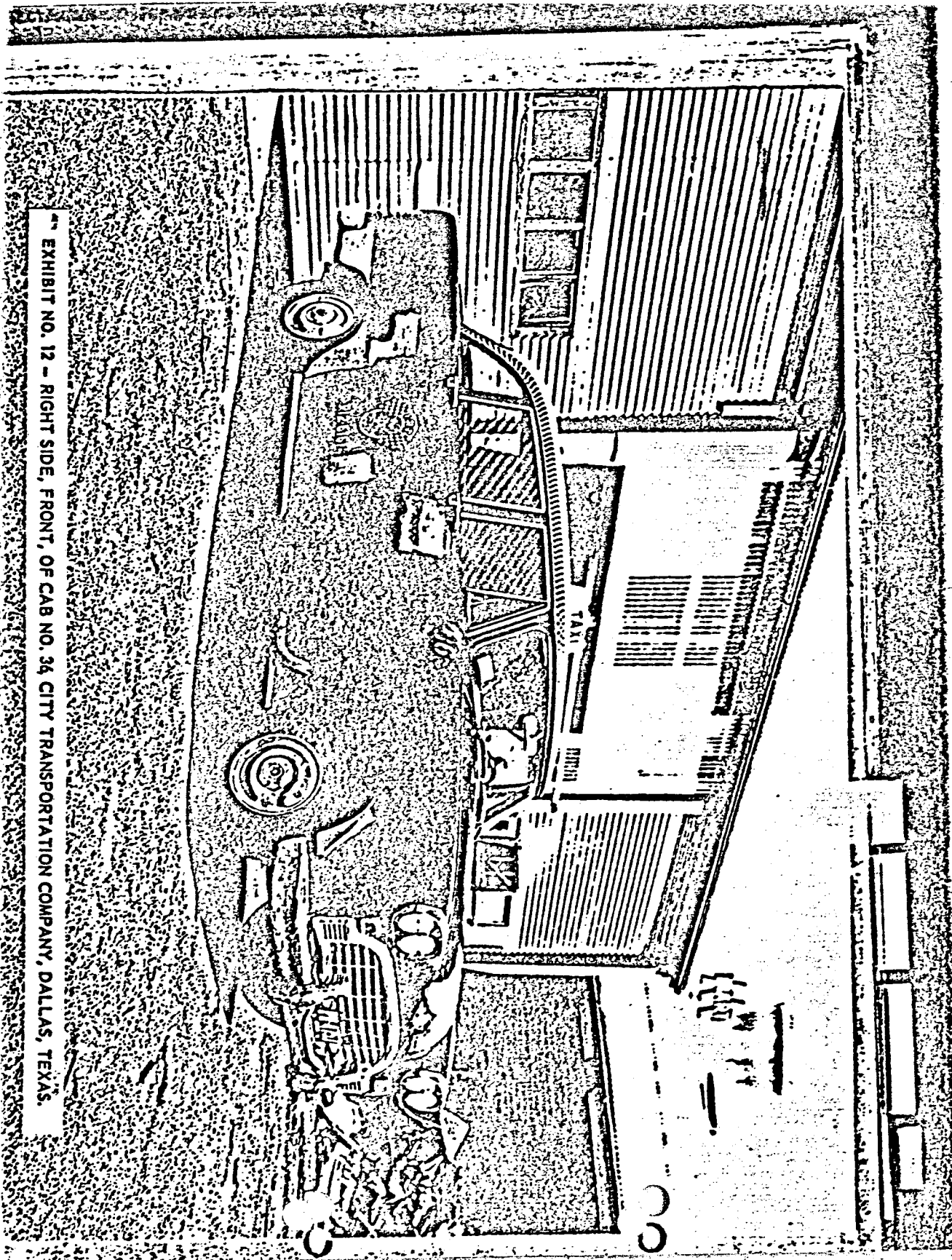

EXHIBIT NO. 12 - RIGHT SIDE, FRONT, OF CAB NO. 34 CITY TRANSPORTATION COMPANY, DALLAS, TEXAS.

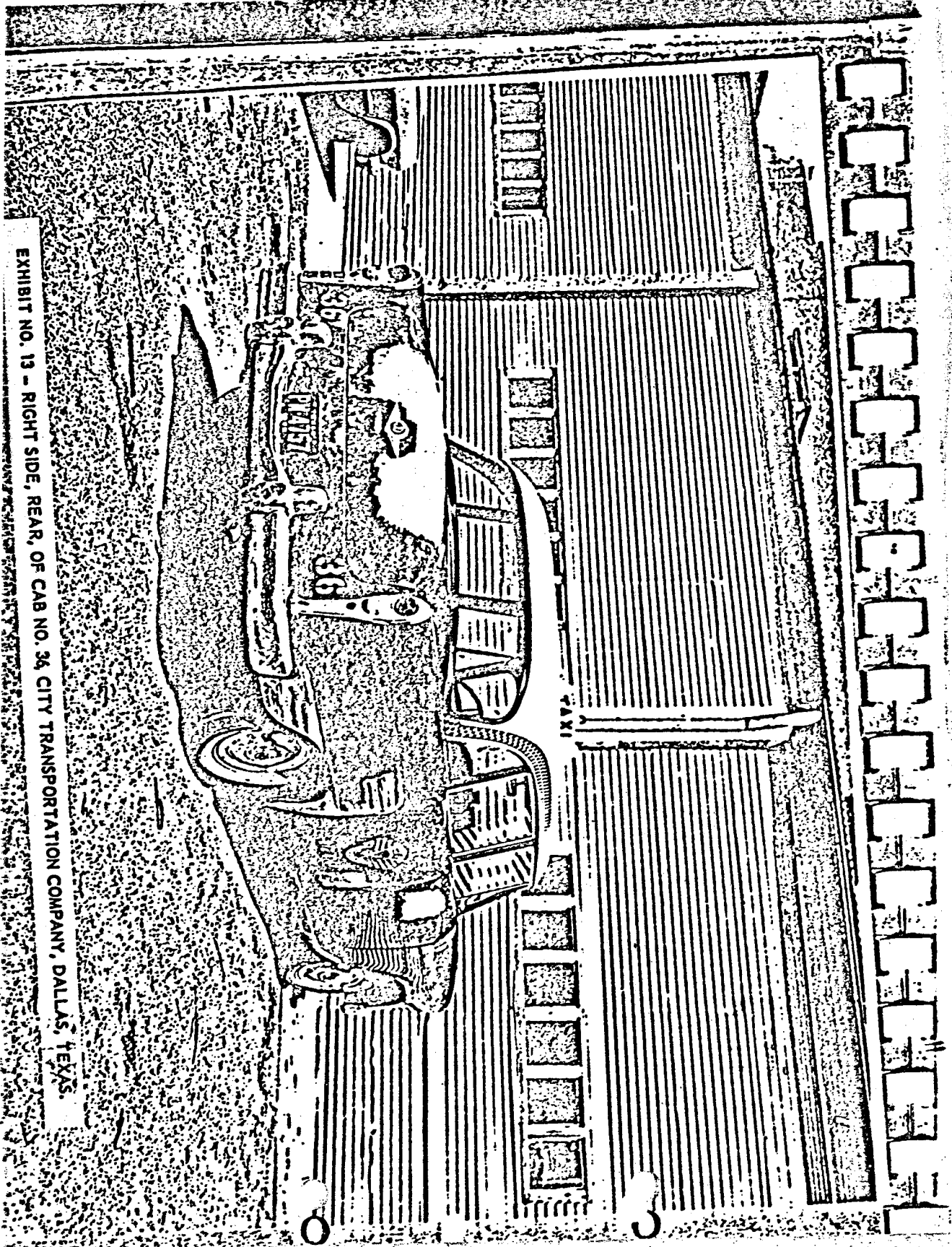

EXHIBIT NO. 13 - RIGHT SIDE, REAR, OF CAB NO. 36 CITY TRANSPORTATION COMPANY, DALLAS, TEXAS.



EXHIBIT NO. 14 - LEFT SIDE, FRONT, OF CAB NO. 36, CITY TRANSPORTATION COMPANY, DALLAS, TEXAS.

COURTEOUS, ALERT DRIVERS ARE SELDOM INVOLVED IN ACCIDENTS

SAFETY FIRST - OBEY ALL TRAFFIC LAWS - GIVE PROPER SIGNALS - AVOID SUDDEN STARTS AND STOPS.
 MILES IN 802.50
 MILES OUT 802.35
 TOTAL MILES _____
 Use Only if Two Cans Are Driven or Meter Changed

Driver W. W. Wheeler
 Shift SHORT DAY
 Car No. 310
 Date Nov 22 5 05 AM '63

Subject Trips/Units if OK ✓
 Total _____
 Add Second Meter Readings _____
 Office Verification By: _____

Call No.	FROM	TO	Mile	Rate	Charge	No. Pass	Time	Time	Mile	Mile	Trips	AVOID ERRORS
C 1	4934 Belmont	Albert	175			4	600	620	44	44	21	9.45
C 2	10697 South	4116 Belmont	85			1	630	700	44	54	Units	15.70
P 3	Robert Kelly Dr.	2804 Tompkins	75			1	700	715	54	58	TOTAL	25.15
C 4	5623 Comhalt	Stankley	205			1	730	750	58	70		
C 5	3210 Knight	3403 Hall	55			2	810	830	70	71		
P 6	3403 Hall	3310 Knight	175			1	820	845	71	77	Less: Charge	
C 7	3807 Hawthorne	5317 Brady	185			1	900	940	77	84	Net Cash	
C 8	Mulvane	Albina Hall	135			1	945	940	84	92		
C 9	6002 Winston	6002 Wynnton	225			1	1030	1050	92	99	Gas 57c	
C 10	Leona Road	3528 Oakway	85			1	1100	1115	99	05	Oil	
C 11	2918 W. Henderson	Elm & St Paul	115			2	1115	1130	05	09	Pick Up 8	
C 12	Traffic Hall	#116	55			3	1200	1215	09	11	Calls 13	
P 13	#116	Stoughton	55			1	1215	1230	11	12	Parade 29	
P 14	Stoughton	508 W. Buckley	95			1	1300	1345	12	15		
P 15	Stoughton	Stoughton	55			1	1400	1415	15	16		
P 16	Stoughton	1809 S. Lamar	75			1	1415	1430	16	19		
C 17	Jarvis	FILE	55			1	130	145	19	20		
P 18	#116	Pal St. etc.	345			1	145	230	20	32		
C 19	Franklin	Diopart	150			2	245	310	32	42		
C 20	3105 Postle	#116	95			1	345	330	42	45		
P 21	#116	105 Ann	105			1	330	345	45	49		

EXHIBIT NO. 15 - TRIP MANIFEST FOR CAB NO. 36 CITY TRANSPORTATION COMPANY, DALLAS, TEXAS, NOVEMBER 22, 1963.

1332022 25.15
 1332022 25.15
 1332022 25.15

KEEP A SAFE DISTANCE BEHIND THE CAR AHEAD

STOP AT FLASHING RED LIGHT — SLOW AT FLASHING AMBER LIGHT

ENTER ALL INTERSECTIONS CAUTIOUSLY — EXERCISE EXTREME CAUTION IN CHANGING LANES OR BACKING

Call No.	FROM	TO	Hour	Rate	Charge	No. Miles	Time Out	Time In	Miles Out	Miles In
24										
25										
26										
27										
28										
29										
30										
31										
32										
33										
34										
35										
36										
37										
38										
39										
40										
41										
42										
43										
44										
45										
46										
47										
48										
49										
50										

Employer Remarks:

MINIMUM PASSENGERS AT A SAFE, CONVENIENT PLACE — GET OUT OF CAB — OPEN AND CLOSE DOORS.

- Signal 1. — Minor Accident.
 - Signal 2. — Major Accident.
 - Signal 3. — Hi-jacking.
 - Signal 4. — Drunk in Cab.
 - Signal 5. — Fight in Cab.
 - Signal 6. — Return to Office.
 - Signal 7. — Call the Office.
- For Wrecker Service Call RI 2-2814

IMPORTANT
 Keep radio on at all times.
 Check in after unloading each trip.
 Answer radio when called.
 Check out of service when out of cab for any reason.
 Report all accidents immediately.

ACCIDENTS DON'T JUST HAPPEN — THERE IS A CAUSE — DON'T BE THE CAUSE OF ONE