



FEDERAL BUREAU OF INVESTIGATION
WASHINGTON, D. C.

*Advised
Lab file*

To: **FBI, Dallas (89-43)**

Date: **December 11, 1963**

Re: **LEE HARVEY OSWALD, aka;
ASSASSINATION OF PRESIDENT
JOHN FITZGERALD KENNEDY,
11/22/63, DALLAS, TEXAS
AFO**

J. Edgar Hoover
John Edgar Hoover, Director

FBI File No. **62-109060**
Lab. No. **D-457464 AX
D-457563 AX**

Examination requested by: **Dallas**
Reference: **Letter 12/1/63**
Examination requested: **Document - Fingerprint**

Remarks:

Photographs of Q132 through Q135 are attached for your information.

The typewriting on Q132 through Q135 was not identified in the National Security File. Appropriate photographs will be added to this file.

Q134 and Q135 were received in the Laboratory on 12/2/63, along with a group of other letters for translation, from the office of the Attorney General.

Enclosures (6) (Photographs Q132 - Q135, & Lab report)

- 1 - Mr. Schatz, 5723
- 1 - Mr. Turner, 649 EB
- 1 - Mr. Latona, 8136 EB

JCC:gl
(9)

REPORT
of the



FEDERAL BUREAU OF INVESTIGATION
WASHINGTON, D. C.

To: **FBI, Dallas (89-48)**

Date: **December 10, 1963**

Re: **LEE HARVEY OSWALD, aka;
ASSASSINATION OF PRESIDENT
JOHN FITZGERALD KENNEDY,
11/22/63, DALLAS, TEXAS
AFO**

FBI File No. **62-109069**

Lab. No. **D-437464 AX
D-437562 AX**

Specimens received **12/9/63**

D-57
2

Q232 Envelope addressed to Lee Harvey Oswald, Mail Office, Dallas, Texas, U.S.A., postmarked La Habana, Cuba, November 28; 9:30 A.M., 1963

Q233 Typewritten letter headed La Habana, 10 de Noviembre, 1963, addressed to Lee Harvey Oswald, Mail Office, Dallas, Texas, U.S.A., bearing salutation of Amigo Lee and ending "Siempre sincerely, Pedro Charles" signed "Peter"

Specimens available in Bureau

58
}

Q234 Envelope addressed to Mr. Roberto Kennedy, Secretary of Justice, Department of Justice, Washington, D. C., U.S.A., postmarked on reverse side Habana, Cuba, Nov. 28 9:30 AM, 1963

Q235 Typewritten letter headed La Habana, 17 de Noviembre, 1963, addressed Mr. Robert Kennedy, Secretary of Justicia, Washington, D. C., bearing on reverse side the handwritten and typewritten signature "Mario del Rosario Molina"

Result of examination:

It was concluded that specimens Q232 through Q235 were prepared on the same typewriter. This machine is equipped with Remington Number 10 large pica type, first used on standard correspondence machines in October, 1955. This typewriting was not identified in the Anonymous Letter File. Appropriate photographs will be added to this file.

Page 1

(continued on next page)

100:gl (3)

It was concluded that the envelopes, Q232 and Q234, came from the same source. These envelopes have a yellowish tinge indicating they are from an old batch. It was noted that the postmark on the reverse side of both envelopes is the same and that the "9:30 A.M." portion of the postmark is upside down on both envelopes. Furthermore, both envelopes have an illegible postmark on the face of the envelopes of which only the "1963" is legible. In addition, it was noted that the same kind of three-cent stamp was found on both envelopes.

Q233 measures 8.28" x 12.89" x 0.0020" (manifold paper). Q234 measures 8.29" x 12.89" x 0.0042" (bond paper). No watermarks or other significant characteristics were noted which would indicate the source of the paper or envelopes, Q233 through Q234.

It was found that the same type of pen and ink were used to prepare the signatures on Q233 and Q234. These signatures are limited in nature and are not comparable with each other. Hence, it could not be determined if both signatures were written by the same individual.

No indented handwriting was found on Q233 through Q234. No microdots were found on Q233 through Q234.

It was concluded that the envelopes, Q232 and Q234, had been previously opened and resealed.

No latent prints of value were found on Q232 through Q234.

The submitted evidence is retained.

T. J. ...
12/9/63

Cadigan
D437562
12/9/63

1st Let.

Dated Nov. 10, 63

e b - y H w t l a r i
↑ ↑ ↑
high low high low

Available in Bureau

Q234,235

2 Page let. and " " " " " " "
Env. addressed TO
Mr. Robert Kennedy } - 7^{1/2} from Rolander, Crypt. sent over by dept for
dated 27 Nov. 63 } Transl.-office of A.G.

Letter is .0042 a bond contracted to thin white .002 of let to LHO
W = 8.3 x 12.89

Sig ink pen & blue ball ink w to let to LHO
TW ident prev

PM on back of env same PM as prev also noted the "9⁵⁰/₁₁" portion upside down.
no crease along left side of upper flap same as prev - also on rt side seam
Face of env has 1 stamp rt side missing. Stamp on env same as prev
Concl this env & prev are same. Both show yellow effect as tho' from
an old box of envs. (6 1/2 x 3.64 x .0024) + printing defects

As before env was opened & resealed -
No indented line. No WM. Again PM front but only "1963" part
is legible. No inked dots.

No latent prints of value were found on env. / ident dis.
Sig ink & ball ink used to let to LHO

457464
12/9/63
Jr

Letter:

Q233 - TW Rem Pica (B2) no indent writings, now M. Sig written fountain
or ~~per~~ per blue ink. Piece manifold plain white - now M or other
NTB black feature to indicate source
PM or back Habana Cuba NOV 26, 9:21 AM 1963

Can't tell who
wrote

Envelope:

Q232 - TW Rem pica (B2) stamps perforated all 4 sides hence from a sheet rather
than a roll. now M. Air mail type stationary no WM or other feature to
indicate source

TW Q227, 228 molders ALF + NSF

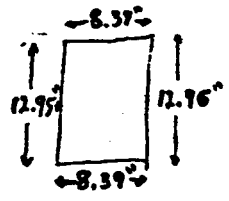

.002"
.002"
.002"

PM base
963

[Send foto to Dallas]

only this can be seen - IR, IR Lum, UV - neg
as to date (day + month)

Rem Large Pica #10 used since Oct 1935 -
std correct machines first

No microdots were found
Envelope was opened &
resealed - glue added
side seams added glue & stuff
no breaks of edge as in original

no latent prints of value on Q232, 233 per Hippenthal 12/9/63

to LFPS 12/9/63

cc Saltona + worksheet

Photoed 12/9/63