

File No. 44-1639-1A (44)Date Received 12/2/1963From Dallas P. O.(PROPERTY CONTRIBUTOR)Dallas, Texas

(ADDRESS OF CONTRIBUTOR)

(CITY AND STATE)

By Les L. Robertson

(NAME OF SPECIAL AGENT)

To Be Returned

Yes No

Description:

Handwritten list of
 serial numbers + series nos.
 of \$1⁰⁰ bills (10 pages).

2 pages handwritten list
 of \$5⁰⁰ bills serial nos. +
 series nos. + 1/4 page of
 \$5⁰⁰ bills + number of
 3 Amer X-pun travel checks
 each in amt. \$20⁰⁰.

Above bills in pos. of Jack
 Ruby at time of arrest for
 shooting of the President.

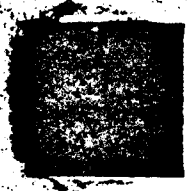

5.00 Bill	" " " "	" " " "	A 17436890 B	1	1950 C H28
" "	" " " "	" " " "	g 04127679 B		" " C I28
1.00	" "	Silver certificate	R 80997288 A		1957 B
" "	" "	" "	V 33120390 A		1957 A 566
" "	" "	" "	Q 01283665 A		1957 A 17
" "	" "	" "	B 25256838 A		1957 A G 62
3.20 Travelers Chicago Express Co Signal Counter signed Samuel B. Bowen			DA 49-990-257 DA 49-990-258 DA 49-990-259		

5.00 bills

Gen. Inv. Note

Inv. #	Series	Mint
A 259874	B	1950-C D 396
B 30140833	B	" A F 164
B 26527963	B	" A D 171
C 08309480	B	" A B 265
C 06913293	B	" A D 271
D 69244056	A	" A G 181
F 1955 8817	C	" C F 333
F 2359 1563	C	" C G 234
F 1887 1724	C	" B H 315
F 3180 7380	C	" C G 309
F 9160 2229	B	" B I 179
F 30771444	C	" C I 271
F 10616121	C	" B I 301
F 18613963	C	" B M 304
F 42276800	C	" C H 368
F 09726428	D	" C A 328
Q 45935294	D	" C K 334
Q 95887890	C	" B G 297
Q 21359049	C	" B F 301
Q 73269048	C	" B G 185
Q 43879103	D	" C P 281
H 82925105	A	" A G 276
H 19542170	B	" C Q 276
H 25585030	B	" C B 388
H 14306025	B	" B M 333
H 18549163	B	" C G 224
H 31456978	A	1934 G 25
H 11731782	B	1950 B - K 334
J 98853468	A	" C - K 330
J 46740990	A	" C - O-327
J 04897106	A	" B - K 359
J 09250042	B	" C - M 343
J 04555353	B	" C - L 352
J 90933763	A	" C - K 300
J 68746848	A	" B - R 221
J 26657284	A	" A - C 149
J 65960108	A	" B - E 265
K 59366007	A	" B - G 267
K 97934869	A	" B - A 263
K 00102402	B	" C - F 206
K 67799746	A	" B - F 309
K 74115085	A	" B - P 319
K 70113177	A	" B - N 230
K 66636577	A	" B - B 263
K 64257969	A	" B - I 265
K 61809134	A	" B - M 278
K 02968581	A	" B - E 207
K 46489237	A	" B - M 280
K 68982715	A	" B - L 308
K 66134358	A	" B - M 185

K 73 86 47 69 A	1950 B	D 349
K 67 17 76 44 A	" B	K 285
K 65 37 69 48 A	" B	K 314
K 65 23 50 66 A	" B	D 295
K 92 20 37 36 A	" B	C 277
K 61 72 38 18 A	" B	I 187
K 61 57 63 19 A	" B	A 318
K 58 81 23 79 A	" B	G 241
K 68 42 46 73 A	" B	B 311
K 68 42 46 73 A	" B	B 281
K 69 14 69 83 A	" B	R 318
K 54 51 87 40 A	" B	A 257
K 93 84 92 98 A	" B	H 333
K 93 75 89 59 A	" B	B 358
K 75 26 77 52 A	" B	P 314
K 66 55 78 12 A	" B	N 328
K 69 03 68 08 A	" B	G 297
K 64 96 91 79 A	" B	I 356
K 93 41 56 48 A	" B	M 307
K 65 74 22 30 A	" B	P 274
K 69 78 99 05 A	" C	G 334
L 22 44 78 30 C	"	K 75
L 28 32 30 47 A	"	H 94
L 40 50 18 98 A	"	G 326
L 89 05 35 64 B	" B	M 251
L 41 64 33 60 C	" D	

\$5.00
U.S. Note

C 46744870 A	1953 B	R 19
C 48530654 A	" B	O 30
C 46961805 A	" B	I 14
C 17783480 A	" B	H 23
C 39147714 A	" B	N 13

H/24/63 Money found in apt. 207 - 923 S. Ewing
 by Lt. Rose, H. M. Moore, Lamark - 131.41

Den.	Type	Serial #	Series
# 10 Bill	Fed. Res. note	K 76214832 A	11-1958 B - A387
" "	"	F 84764817 B	6 - " Q411
\$ 1.00	Silver certificate	B 25142260 A	1957 A B628
" "	"	U 42405263 A	" B A758
" "	"	Z 04553762 A	" B D597
" "	"	U 05712706 A	" B F776
" "	"	Q 81973853 A	" A C731
" "	"	Q 81973852 A	" " " "
" "	"	D 022338438	1935 G D7654
" "	"	Q 97349452 A	1957 A D653
" "	"	N 61492660 A	" B C734
" "	"	D 04903707 A	" A F625
" "	"	I 87539311 A	" A A313
" "	"	L 04377205 A	" A C696
" "	"	M 98144636 A	" A D719
" "	"	A 04106986 A	" A F634
" "	"	Q 01174185 A	" A C719
" "	"	A 60891183 A	" A E700
" "	"	F 49097543 A	" A Q724
" "	"	R 01652876 A	" B C724
" "	"	N 06951821 A	" A D703
" "	"	U 96293210 A	" A Q533
" "	"	K 95329310 A	" A B686
" "	"	C 15877628 A	" A B131
" "	"	I 75560470 A	" A C683
" "	"	V 41974323 A	" B C774
" "	"	D 690760358	A35 G P7897
" "	"	T 94456039 A	1957 B C760
" "	"	J 44921035 A	" A G671
" "	"	M 52010314 A	" " A710
" "	"	U 41949091 A	" B B774
" "	"	K 94861541 A	" A H682
" "	"	U 42414465 A	" B A758
" "	"	U 05485828 A	" " C770
" "	"	J 74976727 A	" A E693
" "	"	T 60927888 A	" B Q755
" "	"	R 99992297 A	" B H743
" "	"	K 07981438 A	" " H315
" "	"	T 54560501 A	" A A734
" "	"	J 94162182 A	" " E690

Silver Certificate

Serial #	Series	Denomination
F 85173989 A	1957 A	C 662
Q 69760464 A	" A	A 719
R 24749563 A	" B	F 734
E 59895102 A	" A	C 657
I 46796491 A	" "	D 309
N 81662449 A	" A	D 714
P 22839744 A	" A	F 717
F 46637703 A	" "	D 311
L 49430459 A	" A	H 700
A 03679053 A	" A	H 685
I 72864303 A	" "	D 238
L 21705046 A	" "	F 697
T 48692146 A	" B	C 755
Z 36902183 A	" "	F 588
I 46863456 A	" "	H 309
R 61288835 A	" "	A 734
R 30440871 A	" B	C 729
P 50547687 A	" B	H 712
N 52106129 A	" A	F 682
I 86920598 A	" "	C 234
R 55360887 A	" B	A 722
G 94792406 A	" A	D 668
B 79797644 A	" A	F 625
Z 95543320 A	" "	B 601
R 55655836 A	" B	E 722
H 75909434 A	" A	D 677
I 73368979 A	" "	E 294
I 51126158 A	" "	E 681
H 70148676 A	" A	E 677
N 18318040 A	" A	D 709
C 90404541 A	1935 G	C 858 1/2
G 27253958 A	1957 A	C 647
I 46863455 A	1957 A	H 309
K 11032051 A	" A	H 695
Q 92496752 A	" A	A 743
I 94232989 A	" 1935 G	H 315
D 33738428 A	1935 G	M 8251
M 52590993 A	1957 A	F 712
D 70306198 A	" A	D 641
I 86763149 A	" 1935 G	C 234
D 69490558 A	1935 G	A 810 1/2
C 24482481 A	1957 A	A 647
L 98537414 A	" A	G 696
I 46969400 A	" A	E 309
L 04053240 A	" A	F 696
T 43480864 A	" A	G 513
L 12028134 A	" A	B 696
P 50154945 A	" A	D 712

J	86	50	60	85	A	1957	A	F 743
U	32	88	90	29	A	"	B	E 759
C	25	60	62	46	A	"	"	A 149
A	17	59	40	09	B	"	B	H 758
Q	97	04	54	25	A	"	B	E 735
V	32	36	04	54	A	"	"	C 557
R	28	08	90	57	A	"	B	E 746
I	86	82	21	44	A	"	"	F 234
U	86	00	11	31	A	"	B	K 768
D	94	44	07	89	A	1935	H	G 8227
L	65	30	98	35	A	1957	A	B 706
V	33	69	48	23	A	"	"	E 549
D	94	83	33	46	A	1935	H	H 8132
G	99	34	27	15	A	1957	A	H 665
L	97	60	82	30	A	"	A	A 705
A	20	63	53	48	A	1935	H	F 8211
D	94	52	87	42	A	"	H	K 8132
E	09	74	11	68	A	1957	A	H 644
V	31	74	03	52	A	"	"	D 560
K	11	00	86	79	A	"	A	G 695
C	97	41	88	45	A	1935	A	K 7749
D	69	08	55	25	A	"	G	G 8218
F	29	58	59	49	A	1957	"	H 224
A	98	84	49	55	A	"	A	G 694
B	90	07	61	26	A	"	"	H 127
D	94	62	57	37	A	1935	H	P 8271
U	19	00	50	95	A	1957	B	G 772
C	71	04	69	58	A	1935	G	G 8332
C	57	88	23	93	A	1957	"	G 135
V	05	98	48	54	A	"	"	D 561
U	18	79	04	98	A	"	B	D 772
A	74	15	76	24	A	"	A	D 711
Q	41	87	47	92	A	"	B	F 774
Q	82	15	07	16	A	"	A	D 7731
D	94	50	04	50	A	1935	H	G 8227
R	08	69	87	68	A	1957	A	C 729
U	97	16	77	71	A	"	B	C 744
C	44	68	41	91	A	"	"	C 773
R	82	36	57	66	A	"	"	G 170
D	01	66	63	10	A	"	B	D 729
V	94	50	50	15	A	1935	H	G 8277
V	05	83	36	93	A	1957	"	D 561
U	31	88	54	59	A	"	"	C 564
V	66	61	70	06	A	"	B	C 766
V	32	34	92	52	A	"	"	B 557
V	32	35	01	14	A	"	"	B 557
D	33	86	30	13	A	"	"	B 560
94	71	29	14	14	J	1935-H	"	B 8227

Q	01	04	19	39	A
N	18	27	97	76	A
B	25	72	81	76	A
V	32	08	07	85	A
N	50	43	18	49	A
L	54	38	77	97	A
D	94	54	51	50	A
A	20	80	06	90	B
R	59	15	14	76	A
D	20	54	47	27	G
D	55	50	42	87	G
V	11	04	65	09	G
P	38	21	94	35	A
P	50	57	08	98	A
S	94	85	12	69	A
N	23	89	97	78	A
J	15	56	06	04	A
D	94	51	80	79	A
P	50	66	49	19	A
F	28	03	39	67	A
I	29	43	15	48	A
C	44	77	68	45	A
N	55	68	02	58	A
K	66	68	75	18	A
R	10	38	82	99	A
T	97	22	50	87	A
H	10	24	70	84	A
L	33	57	89	63	A
M	49	73	42	73	A
N	33	32	19	14	A
E	61	39	42	27	A
T	26	31	80	91	A
S	43	47	84	21	A
P	37	33	68	06	A
D	65	16	29	79	A
R	94	49	05	56	A
V	90	60	44	34	A
Q	31	71	45	05	A
U	38	37	26	75	A
E	18	82	88	54	A
	56	00	02	49	A

1957	A	E 719
"	A	B 709
"	A	G 618
"		E 557
"	A	B 698
"	A	H 698
1935	H	L 8113
1957	B	A 767
"		F 460
1935	H	B 8159
"	G	D 8305
"	G	M 8301
1957		A 2560
"	A	A 711
"		G 426
"	B	C 717
"	A	D 725
"	A	C 682
1935	H	B 7789
1957	A	F 711
"	A	B 717
"		H 172
"		C 309
"	A	A 133
"		G 682
"	A	H 696
"	B	F 744
"	B	A 760
"	A	G 678
"	A	G 760
"	A	C 694
"	A	F 703
"	A	D 648
"	B	F 762
"	B	C 757
"	A	C 717
1935	H	F 8116
1957	B	C 744
"		B 560
"	A	G 742
"	B	F 772
"	A	A 625

\$9000

83 2 4 15 35 A
 B 25 3 7 05 27 A
 D 94 7 7 87 93 A
 P 55 50 17 78 A
 Q 74 29 6 20 4 A
 R 38 35 9 7 49 A
 S 08 13 0 4 15 A
 T 24 8 6 6 2 8 2 A
 U 33 0 8 2 2 3 2 A
 V 81 4 3 8 5 1 8 A
 W 15 9 1 2 9 6 9 A
 X 2 9 3 6 0 2 5 7 A
 Y 2 4 7 5 3 3 2 1 A
 Z 9 3 9 6 3 3 7 5 A
 AA 0 4 5 4 3 5 3 3 A
 AB 6 1 4 5 7 1 1 8 A
 AC 7 5 4 7 3 8 5 5 C
 AD 9 7 1 1 0 9 9 2 A
 AE 9 4 8 2 4 8 4 3 A
 AF 9 5 1 4 8 7 6 7 A
 AG 3 6 6 6 1 7 7 8 A
 AH 9 4 7 4 6 1 2 5 A
 AI 5 6 6 3 3 7 2 2 A
 AJ 0 5 7 9 4 7 5 4 A
 AK 1 7 3 4 8 6 5 2 A
 AL 2 4 9 2 2 0 4 0 A
 AM 9 4 6 6 7 9 1 2 A
 AN 6 3 5 9 5 4 5 2 A
 AO 5 1 0 4 7 1 6 5 A
 AP 1 9 0 2 0 2 4 1 A
 AQ 0 5 9 8 6 5 2 8 A
 AR 8 3 2 5 1 7 6 6 A
 AS 2 2 0 3 9 5 4 0 A
 AT 2 5 0 7 1 9 0 6 A
 AU 1 7 3 9 9 1 5 3 A
 AV 0 0 7 2 8 3 3 5 A
 AW 3 5 7 2 5 6 2 4 A
 AX 6 1 9 6 8 7 4 9 A
 AY 0 0 4 2 0 1 9 8 A
 AZ 4 2 7 4 5 8 6 0 A
 BA 5 4 2 2 4 8 5 1 A
 BB 8 2 5 7 8 4 3 4 A
 BC 3 1 7 2 7 3 8 0 A
 BD 2 4 9 0 3 5 5 2 A
 BE 9 4 5 2 8 7 4 3 A
 BF 2 7 0 8 7 9 6 5 B
 BG 6 2 5 1 6 6 9 5 A
 BH 4 5 9 1 4 2 9 9 A
 BI 3 4 5 1 6 8 9 2 A
 BJ 5 5 7 5 5 6 0 3 A

1957 A H 714
 " A E 628
 1935 H E 8277
 1957 B H 722
 " A C 711
 " A F 742
 " B G 745
 " A D 602
 " G 565
 " B H 712
 " A D 682
 " B E 172
 " B F 745
 " A C 660
 " A D 739
 " B A 739
 " F 567
 " B H 739
 1935 H H 830
 1957 B F 740
 " B 306
 1935 H D 8160
 1957 A H 717
 " B B 745
 " A D 734
 " B G 743
 1935 H R 7728
 1957 A D 701
 " A A 681
 " B H 772
 " D 561
 " A C 714
 " A F 237
 " A F 719
 " A F 700
 " B E 775
 " A C 698
 " A C 642
 " A F 702
 " A B 760
 " A H 698
 " A A 675
 " A C 682
 " A F 602
 1935 H K 8155
 1957 C 281
 1935 G L 8522
 1957 B H 754
 " A F 683
 " B D 742

G	44	88	40	66	A
V	32	01	46	50	A
F	86	81	21	28	A
N	90	30	80	10	A
U	87	33	42	31	A
L	59	40	50	19	A
U	19	38	82	04	A
C	55	96	91	86	A
D	94	51	75	13	A
C	36	15	50	18	A
L	21	52	65	61	A
K	51	79	98	87	A
V	38	08	75	37	A
U	42	64	92	63	A
N	30	72	78	44	A
U	18	99	51	30	A
T	06	59	69	65	A
U	86	63	96	46	A
V	38	08	93	85	A
V	32	31	77	56	A
V	32	73	10	77	A
V	87	64	76	99	A
K	89	39	20	90	A
U	42	53	08	34	A
N	53	27	61	47	A
N	13	36	42	44	B
B	25	25	74	16	A
R	63	44	85	43	A
Q	68	71	61	30	A
N	84	72	31	59	A
G	55	54	51	62	A
T	43	35	12	78	A
K	72	38	89	86	A
I	36	31	06	06	A
T	79	62	47	59	A
L	49	53	22	59	A
S	63	60	23	78	A
K	49	85	62	90	A
I	81	47	61	56	A
I	36	60	59	89	A
E	61	19	23	08	A
G	69	98	08	74	A
L	24	82	42	57	A
S	93	27	94	89	A
C	37	70	72	19	A
U	42	61	81	79	A

1957A	E 655
"	A 557
"	E 304
" A	D 697
" B	G 758
" A	C 709
" B	B 759
"	G 133
1935H	Q 7789
1957	H #133
" A	E 697
" A	F 695
"	A 560
" B	E 758
" A	A 719
" B	F 772
" B	B 760
" B	D 766
"	A 560
"	H 557
"	E 565
" B	G 758
" A	F 682
" B	G 758
" A	H 698
" B	E 732
" A	Q 628
" A	E 697
" A	D 740
"	E 398
" A	B 660
" B	H 762
" A	D 653
"	H 300
" B	F 768
"	E 360
" B	E 717
" A	E 696
" A	B 687
"	G 306
" A	D 625
" A	D 719
" B	B 653
"	H 758
"	F 153
" B	C 758

Q 04 28 1941 A
V 36 52 75 74 A
R 24 81 26 20 A
D 12 72 61 02 A

1957 A

"
" B
" A

G 681

C 549
A 745
E 636

Refer 44-1639-1404

File No. 44-1639-1A(45)

Date Received _____

From _____
(NAME OF CONTRIBUTOR)

(ADDRESS OF CONTRIBUTOR)

(CITY AND STATE)

By _____
(NAME OF SPECIAL AGENT)

To Be Returned Yes
No

Description: *4 copies of maps showing outline of Police Dept. & surrounding area.*

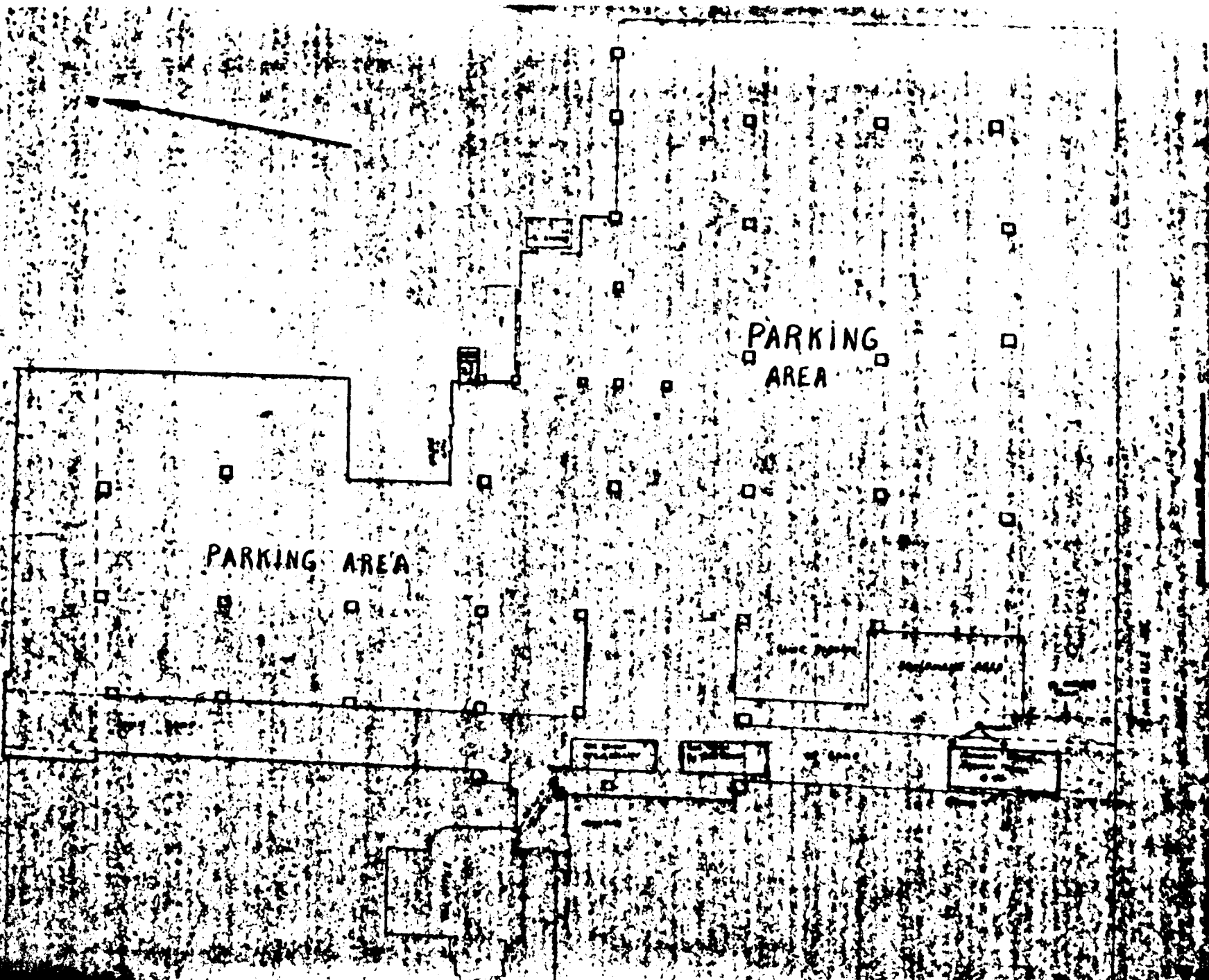

PARKING AREA

PARKING AREA

WATER TOWER

GENERATOR

OFFICE

OFFICE

OFFICE

See 44-1639-1324

File No. 44-1639-1A (46)

Date Received 12/13/1963

From Ina Jeffers "Jack"
(NAME OF CONTRIBUTOR)

Bears Staff Photograph
(ADDRESS OF CONTRIBUTOR)

Dallas Texas
(CITY AND STATE)

By S.A. James C Kennedy
Wall Hayden Kuffner
(NAME OF SPECIAL AGENT)

To Be Returned Yes
No

Descriptions:

11 sheets of photos taken
by Bears at Jack
Ruby's Carousel Club,
Dallas Texas during
summer 1962 at
"Stripper" school being
operated by Ruby.

File No. 44-1629-1A (47)

Date Received 12/26/63

From W. Dallas CID
(NAME OF CONTRIBUTOR)

(ADDRESS OF CONTRIBUTOR)

(CITY AND STATE)

By MLL
(NAME OF SPECIAL AGENT)

To Be Returned Yes
No

Description: req. of fact sheet
DLOND # 36298 dated
12/5/54

File No. 44-1639-1A (48)

Date Received 12-4-63

From San Antonio
(NAME OF CONTRIBUTOR)

(See serial 1320)
(ADDRESS OF CONTRIBUTOR)

(CITY AND STATE)

By Mail
(NAME OF SPECIAL AGENT)

To Be Returned Yes
No

Description: Certified copy
of Corporate Charter
of S + R Inc.
of Dallas, Texas.