

- 1. Disfranchisement reports
- 2. Letter to Embassy
- 3. Tips according to Kellerman

- 1. Soviet report to LA Petell, vigorous rights and demands
- 2. Inquiry to Dept of State on Moscow called, Moscow Journal, 1949, p. 18

U.S. Code

8. What are the outstanding differences between the USSR and USSR? well, except in the U.S. the living standard is a little higher. freedoms are about the same. medical aid and the educational system in the USSR is better than in the U.S.A.

The New Era

IN MINSK THERE WAS A 35 FT. ~~ST. MONUMENT~~ MONUMENT TO STALIN WHICH STOOD EVEN AFTER THE FIRST DENUNCIATION OF STALIN BY KHRUSHCHEV, UNLIKE THE MONUMENT OF STALIN IN Leningrad WHICH WAS TAKEN DOWN IMMEDIATELY. THIS IMPRESSIVE BRONZE AND MARBLE STRUCTURE HAS STOOD FOR AS LONG AS IT HAS DUE TO THE EFFORTS OF RICHARD STALINIST SUCH AS COLN. PETRO-KOFR ^{HEAD} ~~THE~~ OVER. OFFICE IN MINSK AND OTHERS. HOWEVER, AFTER THE 22ND CONGRESS MEETING WHEN KHRUSHCHEV AGAIN DENUNCIATED STALIN, ON NOV. 5. TWO DAYS BEFORE THE NOV. 7 REVOLUTIONARY CELEBRATIONS, A FORCE OF 100 MEN DESCENDED UPON THE STALIN SQUARE ~~FOR~~ (NOW LEIN SQUARE) AND WITH BULLDOZERS AND PILEDRIVER ~~THEY~~ COMMENCED TO TEAR UP (NOT SALVAGE) THE STRUCTURE. THEY MUST HAVE BEEN VERY ENTHUSIASTIC BECAUSE NEXT DAY THEY HAD REMOVED THE 10 TON BRONZE ~~ST.~~ FIGURE OF A MAN REVERED BY THE OLDER GENERATION AND LAUGHED AT BY THE SARCASTIC YOUNGER GENERATION.

THE MOST REMARKABLE THING ABOUT THE DESTRUCTION OF THIS GIANT MONUMENT WAS THAT WORK WAS CEASED ON THE 6TH OF NOVEMBER, BUT STARTED AGAIN ON THE 23RD THE VERY DAY THE BIG PARADE OF KOLLECTORS CAME BY. THE MONUMENT WAS RIGHT ACROSS FROM THE REVIEWING STAND AND IT WAS

55

6

built to be.

In full view of all the dignitaries and workers going by the destruction of Stalin and the symbolic descending of Stalinism ~~was~~ (frustrated hope) was concluded.

But Belarussia as in Stalin's native Georgia is still a stronghold of Stalinism.

and a revival of Stalinism is a very very possible thing in those two republics.

Oswald Correspondence

- 1) Eric Titoujote AND Pavel Golovochoy
- 2) NAME — Alex Kleinlerer
- 3) Letter — ^{on} Piece Paper, Golovochoy
- 3) Murret letters
- 4) Lets re speech at Motilo at Seminary
- 5) 1/2 Ames on Paper
Carlos J. Brinquier
Celso M. Hernandez
Miguel M. Cruz
Wm J. Aillett
- 6) Certification of language ability
by Peter P. Gregory
- 7) Letter on Ft Worth Paper signed Johnny Tackett

By Air.

PER AVION

Dear Gladys,

I've sent

a book to you to-day

I hope you'll have it

in a month or so. This

post-card will get there

in ten days or in twenty days

you'll have the book.

I hope everything is O.K.

All the best to all of you.

Yours truly,
Lee H. Oswald



Lee H. Oswald,
P.O. Box 50067,
New Orleans,
La., U.S.A.

13-56-78

13-56-78

13-56-78

13-56-78

13-56-78

13-56-78

13-56-78

13-56-78

13-56-78

13-56-78

13-56-78

13-56-78

13-56-78

13-56-78

13-56-78

13-56-78

13-56-78

13-56-78

13-56-78

13-56-78

Minch,
August 22, 1962.

Dear Glick,

I did send you a letter at the very beginning of August. It must have come to you by now. So I hope this letter is the second one.

Everything here is OK. (except the weather, which is really nasty). I'm having my holiday now.

I have nothing to read in English. Waiting for your books. The books you wrote to have sent to me didn't come yet. I wonder if they have lost them at post. It would be a pity. I'm too glad to any English book you know.

Will you acknowledge the first letter you receive from me?

I think if it would be right to send you any books now, that I don't know they reach you. There was nobody wrong with the address for I was very careful about it.

My best regards to all you there.

Miss Marina and June.

Your friend, Erick.

55

P.S. I saw Nella the other day. She asked me about you. I told her that you were O.K. She was married and going to leave for somewhere to work at school. She sends her best regards to you.

Erick

PARAVION

CWA

Kyda USA

2703 MERCEDES ST,

Fort Worth,

Texas.

Kenny G. Oswald

Send my address
Army Department

En. G. Oswald, Memphis

USSR

1-11

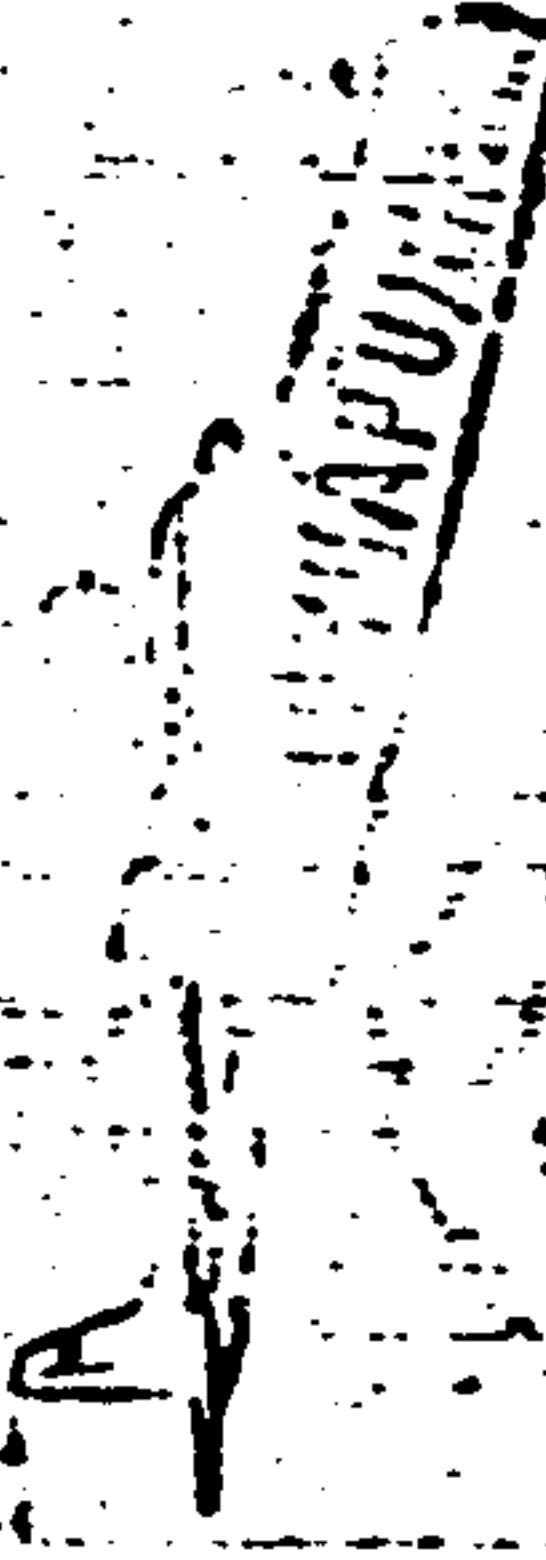

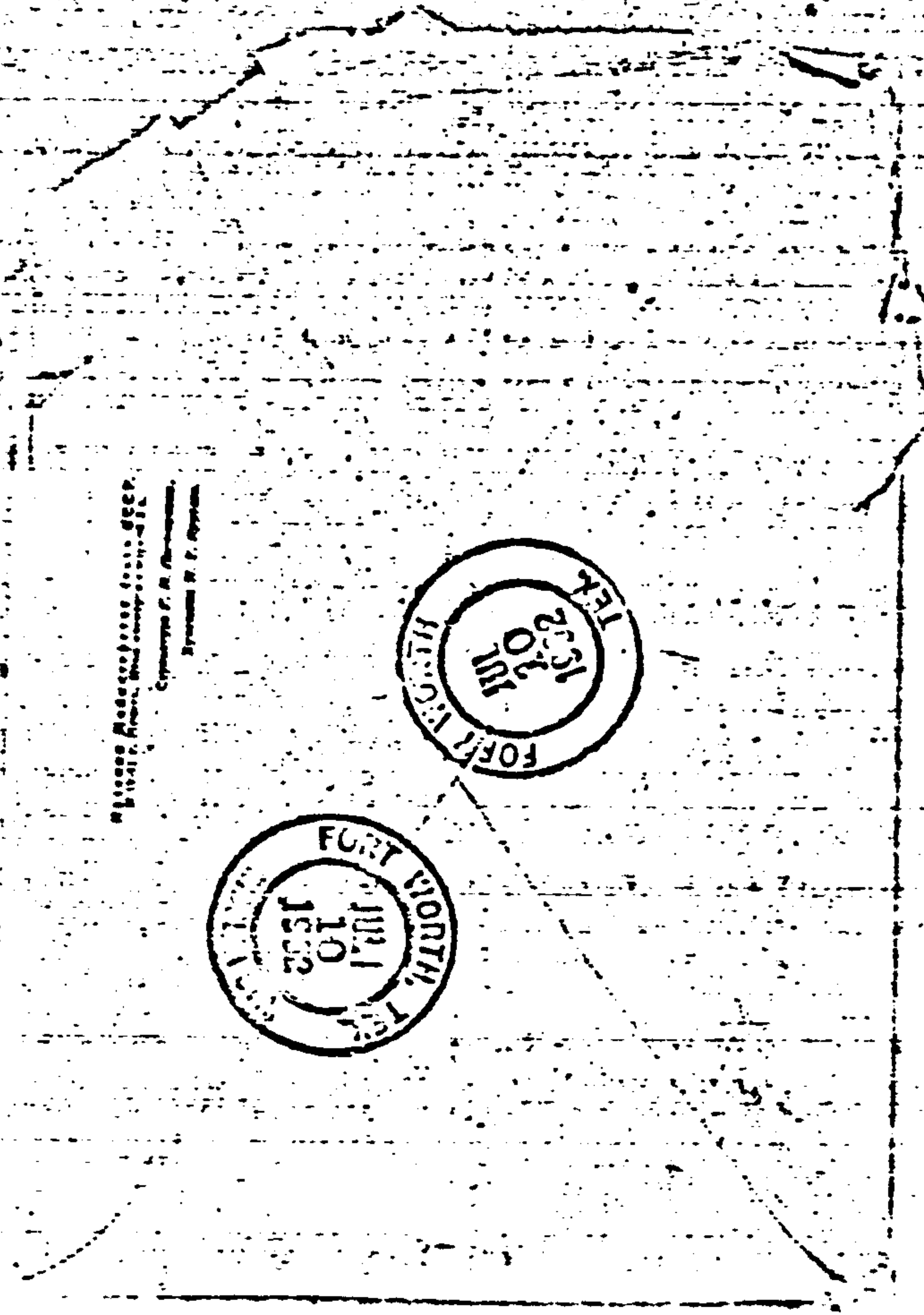

7.44

50.06

57.50

046

Minsk,
Oct 8, 1962.

Dear Alack,

I've got all your
letters and none of the packages.

I went over Zeleni the other day. They got
some books and magazines from you.

It's rather dull without you here.
Almost nobody to speak to. Some weeks
ago I was to a meeting with English students.
They were peace marchers. They were a few
for boys only so anyone was immediately
captured by a dozen of chattering Russian
girls. I managed to get close to some of
the Brits and spoke to them. They said
I had a very good accent (English accent).

It's very nice you can subscribe Russian
news papers in there so I need not send them
to you.

I saw Mura. She told me she got a
package from your wife and sent her best
regards to her. I asked her to write.

1941

Do you remember that tall boy
 fair-haired girl from the Conservatory?
 We were at the 'Eugene Oregon' performance
 with her at Haprog. I go on seeing her
 and she asked me about you. I said you
 were O.K. He said you were a very charming
 boy. He liked you. (Don't say that to your
 wife).

Well, I still finish this letter now.
 I set for French. Is it possible to get a
 French text book for English speaking people
 there? I'd like to have one.
 I think, I'll send a book to you to see
 what happens.

My best wishes to Marina.

Your friend, Erik.

To Marina:

У нас сейчас хорошее время
 очень, много солнца.
 Мы приезжаем скоро закончим.
 Я думаю у тебя и друзей. С тобой все очень
 и приятно очень пора (она сама написала).
 У нас будет хорошая вещь. Хорошо вы все
 узнаете все? Было хорошо. Спасибо тебе.

ABMA:PARAVION

CWA



Kyda P. D. A.
Fort Worth, Texas,
7313 Leavonport Dr.
Kosy Lecht Oswald

sendis aralolen 2. P. D. A. -
Army amparacion
Leningradskaya 1-11,
Minsk, U.S.S.R.

Mi
August

Dear Mike,

Your letters came two weeks ago. I also got the letter for Inna (first one) and it is so nice. We delighted to see your face in the photo. I was glad to hear you had trouble there and I hope you had a good time. I was to the point that month so I couldn't answer at once. You wrote you sent me books. You are really nice that.

Now that you let (do it) I have English practice at all! Why should you stay for a year more? I have been looking for an Englishman, American, or Canadian all the time but there isn't seem to be any of them here. I can only listen to your recorded voice with all the mispronunciations of yours. I think there haven't been any similar changes here since you left so

200

write about it.
I have on month of holiday which
I hope to spend somewhere hiking.
In three or four days I'll be
able to send anything for Marina.
Maybe Inna will send something
or well so she'll have enough to
read in Russian.

My best regards to you all.
Kiss your June.

Your friend, Eric.

P.S.

I think it'd be better to write
my address in Russian. They have
to translate it here and you can imagine
just how they mutilate my name.

For Marina.

Марина!
Твое письмо я получил. Да не стесняйся
ничего писать, но не забудь написать адрес.
Я же в бланке. Я дам на адрес. Лучше всего
написать номер квартиры. Ты можешь написать
на бланке - а в бланке писать, что ты живешь в...

ERIC & Marina in Russian

Said Alk will translate the above for her. Said
he gave Marina's letter to Inna.

191



Минск. Станция "Днепр"

U.S.A.
2313 DAVENPORT ST.
FORT WORTH
TEXAS
MR. Lee Oswald and
MRS. Marina Oswald.

Здравствуйте ли Марина!
Субботу маленькую Дня!
Надеюсь, что вы уже добра-
лись домой. Как вы госкани?
Как субботуи себе Дня?
Весь ей шумом "окрылат"
Америку в таком возрасте, на ка-
ких в котором даже тригоном
Кажется, не смотря на то что он сам
облаченный самолетом, не сме-

Dear Lee & Marina and June -

Hope that you got home. How was the trip?
I received your card from Moscow late because he wrote
'apt 24' as per habit. Judging by your card you should have
left Moscow the end of May. Mentioned that Erik dropped in
see him. Walter on sending photos, what he took at RR station
& train. Walter brought several photos to Zieger and asked
Zieger's daughter to give couple of photos to Anatoli since he
doesn't know latter's address.

→ see last page

мне он на море открыл.
Отпустил там у моря
и погнул енисеем воздо-
жно в мор, во лу по нго-
лече намере . н. 14 . а на
погнул наи конине.
Судь по аспуре та помена
дому грати у морас в
конце мар. . клан, во в не
пане в каной гент та нго-
нам еше рас репу клане-
а . он нодане в нольду. . на
ендунуеи гент носсе та-
нече оредо в морды гато-
гит . Ино ко мее. Он скажан,
во ево в 1101 денс не деного
на и носоней нуно не гуан
о нудемоненте аредо он не
гана в там. А еше репу
нелонное днел гасемне

самы вавилу. . Енисеем там
покоряются в шаг стено
погнул носсе не носсе, не ени-
ку, конорсе в денан на кон-
гане в у ноегда. в конануне
кода в енисеем Днегу, гошо-
ленека не днана днел - он
енисеем носсе гадане.
А амие носсе носсе енисеем
мисону Сурпу, а гаче не, нону
еши ево гора аргата репу ено
кот Стануе, кода она ево гу-
гит - в не гуно еде он нидин
бем не гуапем в беве в беме
гор, конорсе нолзем сто носсе.
но, но та носсе в енисеем,
нода в елгунуеи носсе в
ноно там нелане смее ена
кат. Вгуе там носсе
еши носсе енисеем .

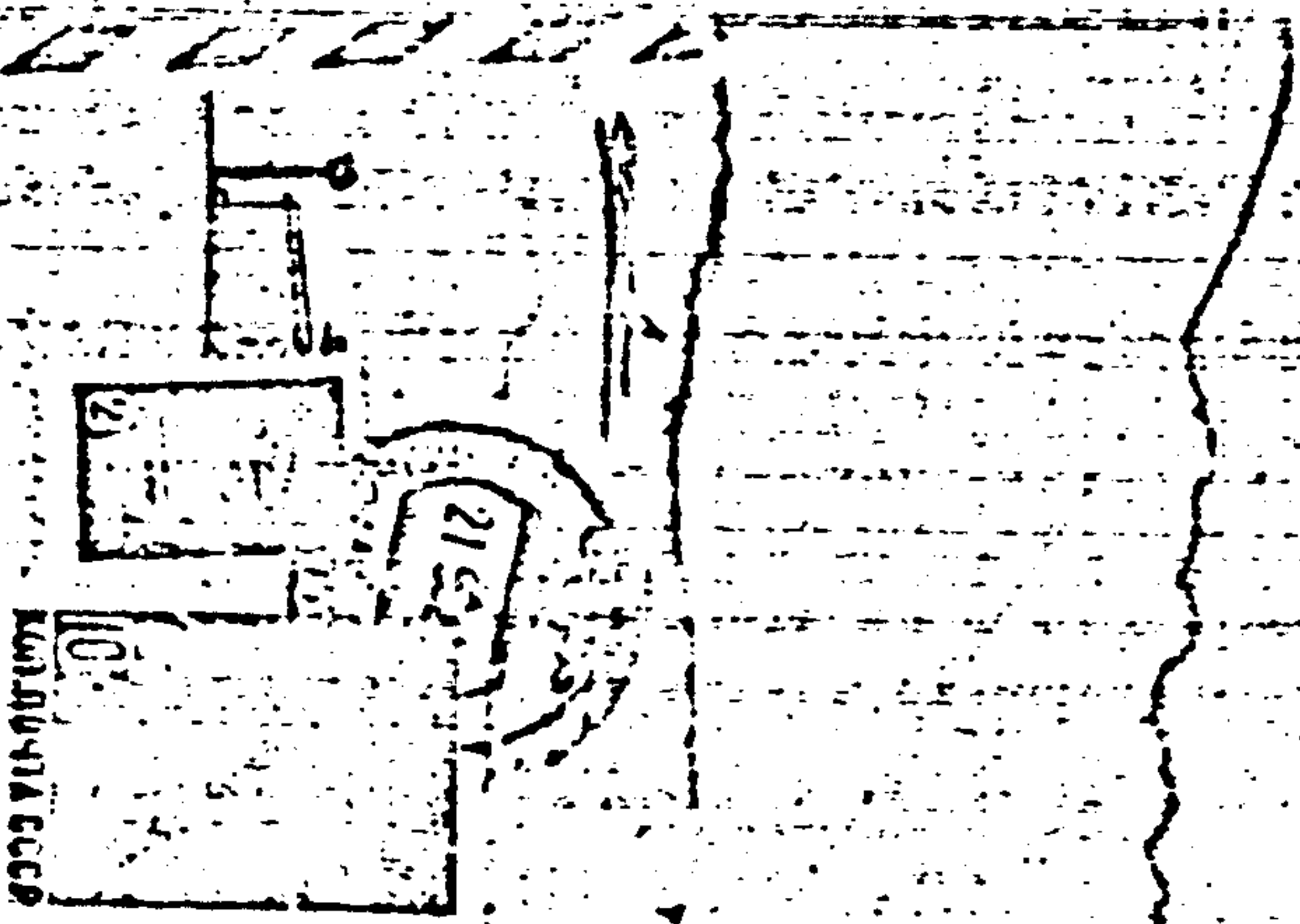

U.S.S.R.
 FORT WORTH TEXAS
 2703 MERCEDES AVENUE
 Komy de Oswald
 Marina Oswald
 U.S.S.R. city Minn
 ZAHAROVA ST. HOUSE 11
 YOLOVACHOV BUREAU

From: Pavel Golovachov
 Minsk
 Zakharyev St. # 11 apt 72

199

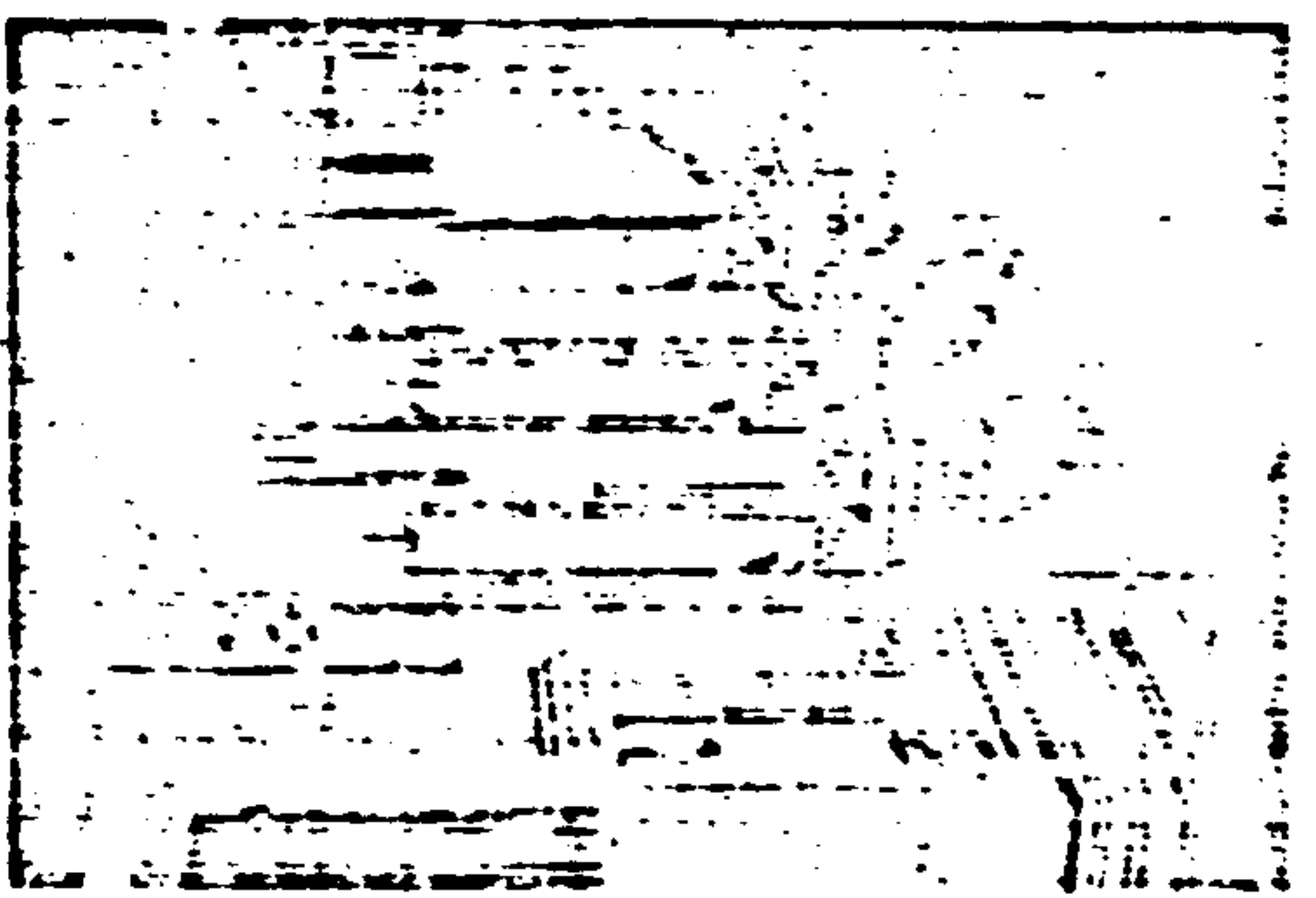

U.S.S.R.
 FORT WORTH TEXAS
 2703 MERCEDES AVENUE
 de Oswald
 U.S.S.R.
 city Minsk
 ZAHAROVA ST.
 HOUSE 11 apt 72
 YOLOVACHOV BUREAU

Hello, Lee!

Why you no write me letters?
 I do want you to write
 letters me also. Well, but
 you speak and write Russian
 better than I speak and write
 English. Of course, you make
 mistakes in word, but it is

English. I speak and write
 English better, but easily

100

100

not yet still. (Napoleon lose
still bigger). You may write
me letters English, but, please,
legibility, but I shall not
read letter. It is very useful
me. I want know English.
adieu. Stacia.

city Minsk

15.09.62 years

9/15/62

P.S. Excuse me for my
mistakes.

JESUIT HOUSE OF STUDIES

3959 LOYOLA LANE
MOBILE, ALABAMA

July 6, 1963

Dear Lee and Moreno:

Here at the House of Studies during the summer months we have a series of lectures on various subjects given by different persons from the neighboring areas. These subjects usually deal with art, literature, economics, religion, politics, etc. We usually have a speaker every one or two weeks on a Saturday or Sunday night. Since we are studying philosophy, most of us are interested in the various phases of Communism, as this is a very timely and practical subject.

We were hoping that you might come over to talk to us about contemporary Russia and the practice of Communism there. A number of speakers have already been contacted and have definite dates on which they will speak. The best time for us to have you speak, if you are willing, is on Saturday night, July 27. The talk usually begins at 7:00 and lasts for about an hour. Then there is a five minute intermission and the speaker returns for a question period which may last a half-hour or so. When I say that we would like to have you speak on contemporary Russia and the practice of Communism there, this is only a general idea of mine. Of course we want you to choose whatever topic you like concerning your travels in Russia and to present the talk and its material in whatever way you like. It can be as informal as you like and a narration of your own observations. In other words, don't feel that it ought to be very formal and theoretical. Also, when I say that the talks usually last for an hour, I don't mean that it has to be that long. This is rather by way of a time limit. You may use whatever notes you may wish to prepare. In short, do it the way you feel you want to do it and be assured that we want you to feel at home in talking to us.

We have about 90 men who are studying philosophy in the House. Usually about 25 or so will attend these talks. We hope that you will accept our invitation and I think you will find it a good experience, as I'm sure we will too. Most of us are about your age.

I wrote my family today telling them that I planned to invite you for this occasion. They had already told me on their last visit that they hoped to invite you to come over with them when they came here sometime. I asked them if they wouldn't mind arranging to make a visit here for the same occasion so that you could come together. I told them that I would ask you to call them to make plans about this or else for them to call you. Of course we hope Moreno will come too.

You can let me know what you think about the matter and ask any further questions you may want to know about the situation. Drop me a line when you get a chance.

Sincerely,

Gene

246

JESUIT HOUSE OF STUDIES
3959 LOYOLA LANE
MOBILE, ALABAMA

August 1, 1963

Dear Mr. Oswald:

This is just a very brief note to express my thanks for the talk you gave us on Russia Saturday, July 27th. I feel that I came away from your talk with an understanding of the Russian people as a people, with ideals, goals, problems--normal, everyday human beings, something that is quite easy to forget with all the threats of war hanging in the air. I find your talk has helped to make me a broader and deeper person, more universal and sympathetic in my thinking. I hope in the future both America and Russia can draw closer to one another and thereby increase in friendship and understanding.

I also wish to tell you that I greatly admire your search for truth and your living in Russia, and I hope you have or will find it.

You can be assured of a permanent remembrance in my prayers and sacrifices, you, your wife, and your family.

With sincere gratitude,



Paul Piazza, S. J.



PAUL PLAZZA, S. J.
 JESUIT HOUSE OF STUDIES
 SPRING HILL STATION
 MOBILE, ALABAMA

Mr. Lee Oswald
 4907 Magazine Street
 New Orleans, La.

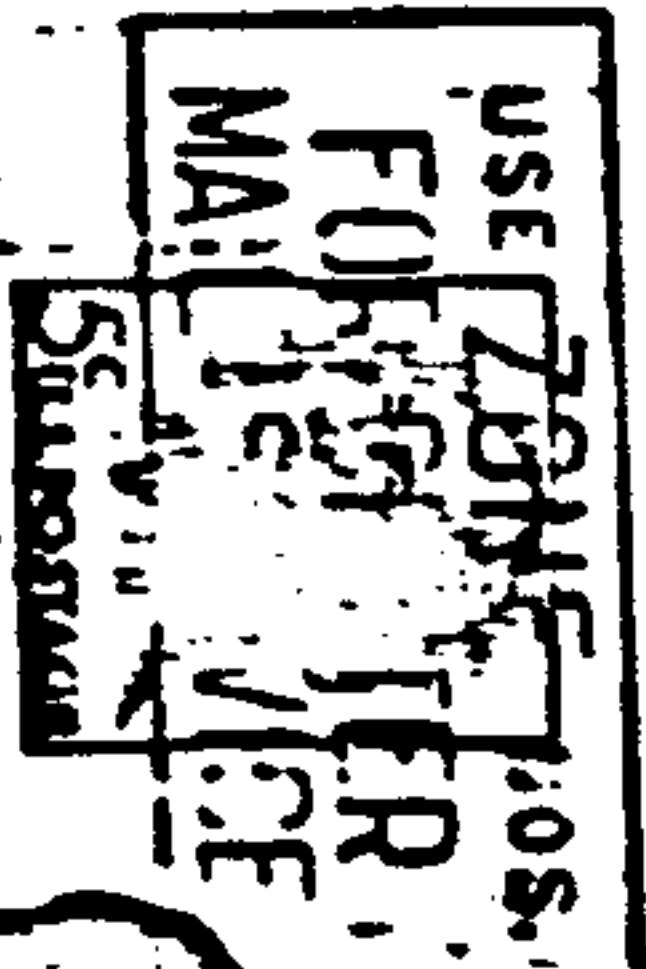

246

PETER P. GREGORY
CONSULTING PETROLEUM ENGINEER
4802 CONTINENTAL LIFE BUILDING
FORT WORTH 8, TEXAS

June 19, 1962

TO WHOM IT MAY CONCERN:

This is to certify that Mr. Lee Harvey Oswald has a good knowledge of the Russian language. He acquired this knowledge during his three-year residence in the Soviet Union. In my opinion, he is capable of being an interpreter and perhaps a translator.

Peter P. Gregory

248

238



The Fort Worth Press

PRINTING BUILDING
FORT WORTH, TEXAS

June 22, 1962

Lee Oswald,

Peter Gregory gave me permission to leave this letter with him in his office. If you should return, he kindly consented to give it to you.

As I'm sure you know by now, I would like to talk with you. It is not my intent to stir the embers of your personal controversy or to subject you to ridicule. I do not pretend, either, to offer exoneration for what you did, because I do not know why you did it or how you feel.

But whatever your reason for defecting, I think people can be made to understand it. It seems apparent that your reason for leaving no longer outweighs your desire to live in America.

You would be surprised how many people still link the name Lee Oswald with "traitor" and "turncoat." You will find in your search for employment that those who don't remember the name nevertheless will think of some excuse for not hiring you when they learn your background.

Personally, I do not condemn blindly. And I do not believe in trial by newspaper. I do believe that where sympathy ends, understanding falters.

You are 22, married to a cute girl and have a small child. You come from the plain vanilla strain of people. You are idealistic, want to express yourself, maybe write.

I am 24, married to a cute girl and have a small child. I come from the plain vanilla strain of people. I am idealistic (two years out of college) and am a writer.

We are brothers under the skin. To say you are a traitor would be a terrific blow to my own pride. I believe you are a man of convictions. But I don't know for sure, because I have not been offered a chance even to shake your hand.

Please talk with me, on the phone, in person, at your house or at mine--just talk. Not to give me a chance to take quick notes and write a hurried news story--just to talk. I could help you in marketing any writing you might be working on. As a free-lance writer myself, I happen to know that selling words is like selling anything else: The buyer needs to be teased with a wee taste first. With a "teaser" short for Scripps-Howard's 21 papers, the full meal could well turn out to be a story in a national magazine, even a book and possibly a movie.

Alex Kleinlerer
3000. WEST PAFORD St.
P.O. Box 11277 ← (77)
FORT WORTH TEXAS

phone WA-3-2525
WA-3-1901 office

Paul received Rui letter
on return from and today -
is answering same.
P. left work and is attending
day school - second year.
P. suggested Maria Rublevich
& 'Izvestia' - Sunday edition of
'Nedelia' (week).
P. said he prepared many magazines
& read to Orlov. P. said he did
not receive as yet books sent to
him by her.
P. asked Maria and Rui about
clipping of Technical nature as:
other year article: "Maksimov".
As names ER & know more
re: name.
P. advised re: Maria's second
paper, he suggested getting a
journal similar to USSR
mishki and using same for
second paper.

P. drew a diagram of the
second paper.
P. gave the address of
Zhanna (First name)
Leningrad
Novgorodskaya at #14 apt 5
Zhanna Shishkova
P. asked for magazines i.e.
~~the~~ with radi-Technical
magazines and other Technical
magazines - "K.B."

Еврей. Меланс, мнъ егъ преленъ,
тмо мого мунгн о нозда с
онобномъ но дѣлу нунунамъ;
нозда немъ сасидо нелану
нелане и нозда не оленъ, и нон
не сав о ноздѣ, неланъ. Б
молва егъланъ нунунамъ, и
нозда и нонъ. (Холонатъ нун
нунунамъ). Р. Давомъ, Геленумъ
еанге (тмъ нѣмъ) нунуламъ. Ибо
нонуну еанъ и не оленъ нон
не нелане о ноздѣ
и оленуаръ и нону нелане
нунунамъ агъце нелане.

Вамъ еъ агъце:

зга Нунуламъ

я. Ноборозаръ

гол 14 нѣз

Нунуламъ

Нелане

Неланъ, Меланс, нелануламъ оленъ

нунуламъ, нон оленуламъ нелане

нелануламъ, Нелануламъ нелане

109

Oswald - Receipts, etc.

1) Payroll receipts

1) Rely Co

2) Leslie Welding

3) Jagers - Child - Store

4) Baumgardner Cd.

2) Misc receipts

3) Withholding Tax receipts

4) Ft Worth Library Cd.

5) T.E.C. Cd. & RA. Unemp. Cd.

6) School picture

7) T.E.C. Benefit claim cds

8) App. Tex Dr. Lic.

9) SM AU pot Vac. Cert.

No receipt to [unclear]

W. L. KELLY & COMPANY, INC.
NEW YORK, N. Y.

EMPLOYEE'S STATEMENT OF EARNINGS AND DEDUCTIONS

DATE	HOURS WORKED	SALARY BY TIME	A. I. N. T. S.			D. E. D. U. C. T. I. O. N. S.		
			TOTAL EARNINGS THIS PERIOD	REPRESENTING FEDERAL I. T. A. S.	INCOME TAX	MISCELLANEOUS AMOUNT	BOND SAVINGS	
JUL 1950					110			

ATTACH THIS STATEMENT TO YOUR FEDERAL INCOME TAX RETURN IF IT IS A STATEMENT OF YOUR EARNINGS AND TAX DEDUCTIONS FOR THE YEAR TO WHICH THE FEDERAL AND STATE GOVERNMENTS ALLOW THE SOCIAL SECURITY TAX AND IS A BASIS OF ANY CLAIMS FOR UNEMPLOYMENT INSURANCE AND BENEFITS.

WALTON COMPANY, INC.
NEW YORK, N.Y.

EMPLOYEE'S STATEMENT OF EARNINGS AND DEDUCTIONS

DATE	HOURS WORKED	SALARY	EARNINGS		DEDUCTIONS		NET PAY
			REGULAR	OVERTIME	FEDERAL INCOME TAX	STATE INCOME TAX	
01/19/54	40	170.00	170.00		4.10		165.90

IN THE EVENT THIS EMPLOYEE CLAIMS THAT HE RECEIVED THIS STATEMENT OF EARNINGS AND DEDUCTIONS FROM ANOTHER EMPLOYER, HE SHOULD REPORT THIS TO THE FEDERAL AND STATE GOVERNMENTS, INCLUDING THE SOCIAL SECURITY ADMINISTRATION, AND TO THE FINANCIAL AND INVESTMENT DIVISIONS OF THE FEDERAL RESERVE BOARD.

W. D. HENRY & COMPANY, INC.
 NEW ORLEANS, L.L.A.

EMPLOYER'S STATEMENT OF EARNINGS AND DEDUCTIONS

DATE	NUMBER	SALARY	COMMITTEE	TOTAL EARNINGS	EXEMPT	FEDERAL		STATE		MISCELLANEOUS		BOND	CONTRACT
						TAX	TAX	AMT	AMT	AMT	AMT		
1/21/55													

REGARDING THIS TYPE OF THE EARNING, SEE THE RECORD. IT IS A STATEMENT OF
 YOUR EARNINGS AND TAX DEDUCTIONS AS REPORTED TO THE FEDERAL AND STATE
 GOVERNMENTS UNDER THE SOCIAL SECURITY LAW AND IS A BASIS OF ANY CLAIM
 FOR THE PAYMENT OF INSURANCE AND PENSION.

55

WILLIAM LITTLE & COMPANY, INC.
NEW QUENY, UTAH.

EMPLOYEE'S STATEMENT OF EARNINGS AND DEDUCTIONS.

DATE		HOURS WORKED	SALARY	COMM. ONE THIRD	TOTAL EARNING THIS PERIOD	DEDUCTIONS	NET PAY	MISCELLANEOUS			BOND	REMARKS	
MONTH	YEAR							TAX	AMOUNT	ITEM			
12	1953		600		600		410						

NOTE: THIS STATEMENT SHOWS EARNINGS AND DEDUCTIONS FOR THE MONTH OF DECEMBER 1953. YOUR EARNINGS AND TAX DEDUCTIONS SHOULD BE CHECKED AGAINST YOUR STATE GOVERNMENT AND FEDERAL GOVERNMENT RECORDS TO BE SURE OF ANY CHANGE FOR AN IMPROVED PAY AND BENEFIT.

515

W. B. BERRY & COMPANY, INC.
 NEW ORLEANS, LA.

EMPLOYEE'S STATEMENT OF EARNINGS AND DEDUCTIONS

DATE	HOURS WORKED	SALARY	COM. OVERTIME	A		B		C			D		E	
				TOTAL EARNINGS	TAX DEDUCTIONS	TOTAL EARNINGS	TAX DEDUCTIONS	STATE TAX	FEDERAL TAX	MISCELLANEOUS	BOND	CHARITY		
1-17-65		500.00												

ATTACH THIS STATEMENT WITH YOUR RECEIPT. IT IS A STATEMENT OF YOUR EARNINGS AND TAX DEDUCTIONS AS REPORTED TO THE FEDERAL AND STATE GOVERNMENTS UNDER THE SOCIAL SECURITY LAW AND IS A BASIS OF ANY CLAIMS FOR UNEMPLOYMENT INSURANCE AND PENSIONS.

W.M. D. DRETT & COMPANY, INC.
 NEW ORLEANS, LOUISIANA

EMPLOYEE'S STATEMENT OF EARNINGS AND DEDUCTIONS

DATE	HOURS WORKED	SALARY	COMM. & OTHERS	E A R N I N G S		D E D U C T I O N S		BOND	SAVINGS
				TOTAL EARNINGS THIS PERIOD	EXPENSES	FEDERAL & STATE TAX	MISCELLANEOUS AMOUNT		
MAY 21 63		11.25		11.25					

DETACH THIS STUB REPORT CASHING. KEEP THIS RECORD. IT IS A STATEMENT OF YOUR EARNINGS AND TAX DEDUCTIONS AS REPORTED TO THE FEDERAL AND STATE GOVERNMENTS UNDER THE SOCIAL SECURITY LAW AND IS A BASIS OF ANY CLAIMS FOR UNEMPLOYMENT INSURANCE AND PENSION.

LESLIE WELDING CO., INC.
 11241 WEST MELROSE ST., FRANKLIN PARK, ILL.

No 6189

HOURS		EARNINGS					DEDUCTIONS					
REGULAR	O. T.	REGULAR	O. T.	COMMISSION	BONUS	CASH ON HAND	P.L.C.A.	W. H. TAX	ADVANCES	UNPAID	INSUR.	DATE

LESLIE WELDING CO. 2615 11241
 59.50 105 16.70

JUL 21/61

THIS IS NOT A CHECK - DO NOT CASH

DETACH AND
 RETAIN FOR
 YOUR RECORDS.

57

LESLIE WELDING CO. INC.
11841 WEST MELROSE ST. FRANKLIN PARK, ILL.

110 7219

EARNINGS				DEDUCTIONS								
HOURS	R. T.	REGULAR	O. T.	COMMISSION	PROPS	EARNINGS-TO-DATE	P.L.S.A.	W. H. TAX	ADVANCES	INSURANCE	RESC.	DATE

40.00
 30.00
 577.27
 1.15
 474.52

THIS IS NOT A CHECK - DO NOT CASH

DETACH AND
RETAIN FOR
YOUR RECORDS.

LESLIE WELDING CO. INC.
11841 WEST MELROSE ST. FRANKLIN PARK, ILL.

110 7296

EARNINGS				DEDUCTIONS								
HOURS	R. T.	REGULAR	O. T.	COMMISSION	PROPS	EARNINGS-TO-DATE	P.L.S.A.	W. H. TAX	ADVANCES	INSURANCE	RESC.	DATE

40.00
 50.00
 540.34
 1.50
 538.84

THIS IS NOT A CHECK - DO NOT CASH

DETACH AND
RETAIN FOR
YOUR RECORDS.

LESLIE WELDING CO., INC.
13241 WEST MELROSE ST., FRANKLIN PARK, ILL.

No. 7192

HOURS				EARNINGS				DEDUCTIONS				
REGULAR	O. T.	REGULAR	O. T.	COMMISSION	GROSS	EARNINGS-DATE	P.L.C.A.	W. H. TAX	ADVANCED	INSURANCE	MEMO.	DATE
40.00		50.00			40.00	41.054		1.56	2.20			SEP 15

THIS IS NOT A CHECK - DO NOT CASH

DETACH AND
RETAIN FOR
YOUR RECORDS.

LESLIE WELDING CO., INC.
13241 WEST MELROSE ST., FRANKLIN PARK, ILL.

No. 7067

HOURS				EARNINGS				DEDUCTIONS				
REGULAR	O. T.	REGULAR	O. T.	COMMISSION	GROSS	EARNINGS-DATE	P.L.C.A.	W. H. TAX	ADVANCED	INSURANCE	MEMO.	DATE
40.00		50.00			50.00	44.034		1.56	2.20			SEP 31

THIS IS NOT A CHECK - DO NOT CASH

DETACH AND
RETAIN FOR
YOUR RECORDS.

67

LESLIE WELDING CO. INC.
11241 WEST WELLS ST. FRANKLIN PARK, ILL.

No. 6797

EARNING				DEDUCTIONS								
HOURS	R.T.	REGULAR	O.T.	COMMISSION	AGRS	SAVINGS-D-DATE	P.L.A.	W.M. TAX	ADVANCE	UNPAID	WEC.	DATE

40.00 20 10.00 41

THIS IS NOT A CHECK - DO NOT CASH

DETACH AND
RETAIN FOR
YOUR RECORDS.

LESLIE WELDING CO. INC.
11241 WEST WELLS ST. FRANKLIN PARK, ILL.

No. 6952

EARNING				DEDUCTIONS								
HOURS	R.T.	REGULAR	O.T.	COMMISSION	AGRS	SAVINGS-D-DATE	P.L.A.	W.M. TAX	ADVANCE	UNPAID	WEC.	DATE

41.00 1.00 11.25 63

THIS IS NOT A CHECK - DO NOT CASH

DETACH AND
RETAIN FOR
YOUR RECORDS.

SEP 1972

LESLIE WELDING CO., INC.
 11241 WEST MELROSE ST. FRANKLIN PARK, ILL.

No. 6677

EARNINGS				DEDUCTIONS					
REGULAR	O. T.	COMMISSION	GRATUITY	P.L.O.A.	W. H. TAX	ADVANCES	INSURANCE	AMEL.	DATE

40.00

50.00

20.00

1.30 2.40

AS 135

THIS IS NOT A CHECK - DO NOT CASH

DETACH AND
 RETAIN FOR
 YOUR RECORDS.

LESLIE WELDING CO., INC.
 11241 WEST MELROSE ST. FRANKLIN PARK, ILL.

No. 6557

EARNINGS				DEDUCTIONS					
REGULAR	O. T.	COMMISSION	GRATUITY	P.L.O.A.	W. H. TAX	ADVANCES	INSURANCE	AMEL.	DATE

23.00

50.00

1.50

55.55

1.74 3.10

AS 115

THIS IS NOT A CHECK - DO NOT CASH

DETACH AND
 RETAIN FOR
 YOUR RECORDS.

LESLIE WELDING CO., INC.
11241 WEST MELROSE ST. FRANKLIN PARK, ILL.

No 6422

HOURS			EARNINGS				DEDUCTIONS					
REGULAR	O. T.	REGULAR	O. T.	COMMISSION	GROSS	EARNINGS-TO-DATE	P.L.C.A.	W. H. TAX	ADVANCES	INSURANCE	MSG.	DATE

THIS IS NOT A CHECK - DO NOT CASH

DETACH AND
RETAIN FOR
YOUR RECORDS.

LESLIE WELDING CO., INC.
11241 WEST MELROSE ST. FRANKLIN PARK, ILL.

No 6315

HOURS			EARNINGS				DEDUCTIONS					
REGULAR	O. T.	REGULAR	O. T.	COMMISSION	GROSS	EARNINGS-TO-DATE	P.L.C.A.	W. H. TAX	ADVANCES	INSURANCE	MSG.	DATE

THIS IS NOT A CHECK - DO NOT CASH

DETACH AND
RETAIN FOR
YOUR RECORDS.

61

JAGGARS - CHILES - STOVALL, INC.

DALLAS, TEXAS

PERIOD ENDING	REGULAR		OVERTIME		OTHER EARNINGS
	HOURS	AMOUNT	HOURS	AMOUNT	
12/31/50	1000	5100	100	500	

YOU SHOULD FIND THIS PAID AMOUNT

REGULAR	OVERTIME	OTHER EARNINGS	TOTAL	FICA	WELFARE	M.S./M.C.P.	CC 44	ADVANCE	MISCELLANEOUS	BALANCE OF EARNINGS
5100	500		5600	219	50					6747

IN ADDITION TO YOUR TOTAL EARNINGS
JAGGARS - CHILES - STOVALL - PAID FOR YOUR BENEFIT:
 • ALL OF YOUR EMPLOYER'S CONTRIBUTION INSURANCE PREMIUMS
 • ALL OF YOUR EMPLOYER'S CONTRIBUTION INSURANCE PREMIUMS
 • ALL OF YOUR EMPLOYER'S CONTRIBUTION INSURANCE PREMIUMS
 • ALL OF YOUR EMPLOYER'S CONTRIBUTION INSURANCE PREMIUMS

QUALITY WORK INSURES REGULAR CHECKS

PLEASE CHECK THESE DEDUCTIONS AS PER YOUR REQUEST

JAGGARS - CHILES - STOVALL, INC.

DALLAS, TEXAS

PERIOD ENDING	REGULAR		OVERTIME		OTHER EARNINGS
	HOURS	AMOUNT	HOURS	AMOUNT	
12/31/50	1000	5100	100	500	

YOU SHOULD FIND THIS PAID AMOUNT

REGULAR	OVERTIME	OTHER EARNINGS	TOTAL	FICA	WELFARE	M.S./M.C.P.	CC 44	ADVANCE	MISCELLANEOUS	BALANCE OF EARNINGS
5100	500		5600	219	50					6211

IN ADDITION TO YOUR TOTAL EARNINGS
JAGGARS - CHILES - STOVALL - PAID FOR YOUR BENEFIT:
 • ALL OF YOUR EMPLOYER'S CONTRIBUTION INSURANCE PREMIUMS
 • ALL OF YOUR EMPLOYER'S CONTRIBUTION INSURANCE PREMIUMS
 • ALL OF YOUR EMPLOYER'S CONTRIBUTION INSURANCE PREMIUMS
 • ALL OF YOUR EMPLOYER'S CONTRIBUTION INSURANCE PREMIUMS

QUALITY WORK INSURES REGULAR CHECKS

PLEASE CHECK THESE DEDUCTIONS AS PER YOUR REQUEST

No 2560

JAGGARS - CHILES - STOVALL, INC.
 DALLAS, TEXAS

PERIOD ENDING: 12/31/62
 ACCOUNT NO.: 1000
 ACCOUNT: 1000
 OTHER: 1000

IN ADDITION TO YOUR TOTAL EARNINGS
 JAGGARS - CHILES - STOVALL PAID FOR YOUR BENEFIT
 PLAN PER YOUR EARNINGS AND COMPENSATION INSURANCE PREMIUM
 ALL OF YOUR HEALTH INSURANCE PREMIUMS AND SOCIAL SECURITY
 TAX AMOUNTS EQUAL TO YOUR CONTRIBUTION FOR SUCH AND SOCIAL SECURITY

JAGGARS - CHILES - STOVALL, INC.
 DALLAS, TEXAS

PERIOD ENDING	REGULAR		OVERTIME		OTHER EARNINGS
	HOURS	AMOUNT	HOURS	AMOUNT	
12/31/62	40.00	2,400.00	10.00	200.00	2,600.00

IN ADDITION TO YOUR TOTAL EARNINGS
 JAGGARS - CHILES - STOVALL PAID FOR YOUR BENEFIT
 PLAN PER YOUR EARNINGS AND COMPENSATION INSURANCE PREMIUM
 ALL OF YOUR HEALTH INSURANCE PREMIUMS AND SOCIAL SECURITY
 TAX AMOUNTS EQUAL TO YOUR CONTRIBUTION FOR SUCH AND SOCIAL SECURITY

YOU LISTED AND
 THIS IS THE
 AMOUNT

THIS SUM IS A RECORD OF YOUR
 EARNINGS AND DEDUCTIONS AS
 REPORTED TO FEDERAL AND
 STATE GOVERNMENTS

PLEASE DETACH AND RETAIN FOR YOUR RECORDS
 JAGGARS - CHILES - STOVALL PAID OUT THESE AMOUNTS FOR YOU

WALANCE
 OF
 EARNINGS
 4,200.00

TYPE OF DEDUCTION	AMOUNT
FICA	169.40
STATE TAX	4.10
FEDERAL TAX	10.00
UNEMPLOYMENT INSURANCE	10.00
HEALTH INSURANCE	10.00
DISABILITY INSURANCE	10.00
RETIREMENT PLAN	10.00
OTHER	10.00

QUALITY WORK INSURES REGULAR CHECKS

THESE DEDUCTIONS
 AS PER YOUR REQUEST

QUALITY WORK INSURES REGULAR CHECKS

THESE DEDUCTIONS
 AS PER YOUR REQUEST

No 2255

60

JAGGARS - CHILES - STOVALL, INC.
DALLAS, TEXAS

YOU EMPLOYED AND
WAS PAID

THIS STUDY IS A RECORD OF YOUR
EARNINGS AND DEDUCTIONS AS
REPORTED TO FEDERAL AND
STATE GOVERNMENTS

NO 5092

PERIOD ENDING	REGULAR HOURS	AMOUNT	OVERTIME HOURS	AMOUNT	OTHER EARNINGS	TOTAL	FICA WITH TAX	PERCENTAGE OF TAXABLE INCOME	STATE TAX	PERCENTAGE OF TAXABLE INCOME	ADVANCE CODE	MISCELLANEOUS CODE	AMOUNT	BALANCE OF EARNINGS
12/31/50	4000	9400	10	20		9420	169	1.80					4051	

IN ADDITION TO YOUR TOTAL EARNINGS
JAGGARS - CHILES - STOVALL AND FROM YOUR EMPLOYER
ALL OF YOUR EMPLOYER'S EMPLOYERS' INSURANCE PREMIUMS
ALL OF YOUR EMPLOYER'S EMPLOYERS' INSURANCE PREMIUMS
AN AMOUNT EQUAL TO YOUR CONTRIBUTION FOR OLD AGE SECURITY

QUALITY WORK INSURES REGULAR CHECKS

THESE DEDUCTIONS
ARE PER YOUR REQUEST

JAGGARS - CHILES - STOVALL, INC.
DALLAS, TEXAS

THIS STUDY IS A RECORD OF YOUR
EARNINGS AND DEDUCTIONS AS
REPORTED TO FEDERAL AND
STATE GOVERNMENTS

NO 2255

PERIOD ENDING	REGULAR HOURS	AMOUNT	OVERTIME HOURS	AMOUNT	OTHER EARNINGS	TOTAL	FICA WITH TAX	PERCENTAGE OF TAXABLE INCOME	STATE TAX	PERCENTAGE OF TAXABLE INCOME	ADVANCE CODE	MISCELLANEOUS CODE	AMOUNT	BALANCE OF EARNINGS
12/31/50	4000	9400	10	20		9420	169	1.80					4051	

IN ADDITION TO YOUR TOTAL EARNINGS
JAGGARS - CHILES - STOVALL PAID FOR YOUR EMPLOYER
ALL OF YOUR EMPLOYER'S EMPLOYERS' INSURANCE PREMIUMS
ALL OF YOUR EMPLOYER'S EMPLOYERS' INSURANCE PREMIUMS
AN AMOUNT EQUAL TO YOUR CONTRIBUTION FOR OLD AGE SECURITY

QUALITY WORK INSURES REGULAR CHECKS

THESE DEDUCTIONS
ARE PER YOUR REQUEST

CO

JAGGARS-CHILES-STOVALL, INC.
DALLAS, TEXAS

PERIOD ENDING	REGULAR HOURS	REGULAR AMOUNT	OVERTIME HOURS	OVERTIME AMOUNT	OTHER EARNINGS
12-31-62	160	1,400	20	270	
TOTAL	180	1,670			

IN ADDITION TO YOUR TOTAL EARNINGS
JAGGARS-CHILES-STOVALL PAID FOR YOUR BENEFIT:
 • ALL OF YOUR WORKERS COMPENSATION INSURANCE PREMIUM
 • ALL OF YOUR UNEMPLOYMENT INSURANCE PREMIUM
 • ALL OF YOUR LOCAL FRUIT AND VEGETABLE INSURANCE PREMIUM

JAGGARS-CHILES-STOVALL, INC.
DALLAS, TEXAS

PERIOD ENDING	REGULAR HOURS	REGULAR AMOUNT	OVERTIME HOURS	OVERTIME AMOUNT	OTHER EARNINGS
12-31-62	160	1,400	20	270	
TOTAL	180	1,670			

IN ADDITION TO YOUR TOTAL EARNINGS
JAGGARS-CHILES-STOVALL PAID FOR YOUR BENEFIT:
 • ALL OF YOUR WORKERS COMPENSATION INSURANCE PREMIUM
 • ALL OF YOUR UNEMPLOYMENT INSURANCE PREMIUM
 • ALL OF YOUR LOCAL FRUIT AND VEGETABLE INSURANCE PREMIUM

YOU EARNED AND
WAS PAID
THIS
AMOUNT

THIS STATE IS A MEMBER OF YOUR
EMPLOYER'S AND CONTRIBUTOR AS
INDICATED TO FEDERAL AND
STATE GOVERNMENTS
PLEASE DETACH AND RETURN FOR YOUR RECORDS

NO 3620

JAGGARS-CHILES-STOVALL PAID OUT THESE AMOUNTS FOR YOU	FICA	WIM TAX	INS / HOUR	COIN CH. AS	ADVANCE	MISCELLANEOUS AMOUNT	BALANCE OF EARNINGS
1,670	100	270					4,920

QUALITY WORK INSURES REGULAR CHECKS

THESE DEDUCTIONS
AS PER YOUR REQUEST

QUALITY WORK INSURES REGULAR CHECKS

YOUR DEDUCTIONS
AS PER YOUR REQUEST

TAX	INS / HOUR	COIN CH. AS	ADVANCE	MISCELLANEOUS AMOUNT	BALANCE OF EARNINGS
100	270				4,920

JAGGARS - CHILES - STOVALL, INC.
DALLAS, TEXAS

PERIOD ENDING	REGULAR		OVERTIME		OTHER EARNINGS
	HOURS	AMOUNT	HOURS	AMOUNT	

JAN 10 40:00 JAN 20 1:50 25:00

25:25 40:00

PLICA	WITH TAX	W/OUT TAX	COIN	ADVANCE	CODE	AMOUNT	BALANCE OF EARNINGS
							72:34

IN ADDITION TO YOUR TOTAL EARNINGS
JAGGARS - CHILES - STOVALL PAID FOR YOUR BENEFIT:
• ALL OF YOUR EMPLOYER'S CONTRIBUTION INSURANCE PREMIUM
• ALL OF YOUR UNEMPLOYMENT INSURANCE PREMIUM
• AN AMOUNT EQUAL TO YOUR CONTRIBUTION FOR OLD AGE SECURITY

JAGGARS - CHILES - STOVALL, INC.
DALLAS, TEXAS

PERIOD ENDING	REGULAR		OVERTIME		OTHER EARNINGS
	HOURS	AMOUNT	HOURS	AMOUNT	

JAN 10 40:00 JAN 20 1:50 25:00

70:31 20:00

IN ADDITION TO YOUR TOTAL EARNINGS
JAGGARS - CHILES - STOVALL PAID FOR YOUR BENEFIT:
• ALL OF YOUR EMPLOYER'S CONTRIBUTION INSURANCE PREMIUM
• ALL OF YOUR UNEMPLOYMENT INSURANCE PREMIUM
• AN AMOUNT EQUAL TO YOUR CONTRIBUTION FOR OLD AGE SECURITY

PLICA	WITH TAX	W/OUT TAX	COIN	ADVANCE	CODE	AMOUNT	BALANCE OF EARNINGS
							69:14

QUALITY WORK INSURES REGULAR CHECKS

THESE DEDUCTIONS AS PER YOUR REQUEST

No 4058

60

JAGGARS - CHILES - STOVALL, INC.

PALLAS, TEXAS

PERIOD ENDING	REGULAR		OVERTIME		OTHER EARNINGS
	HOURS	AMOUNT	HOURS	AMOUNT	

REGULAR AMOUNT 58.00 OVERTIME AMOUNT 4.20 OTHER EARNINGS 0.70

IN ADDITION TO YOUR TOTAL EARNINGS
JAGGARS - CHILES - STOVALL PAID FOR YOUR SHARE:
 * ALL OF YOUR MEDICAL & COMPENSATION PREMIUMS
 * ALL OF YOUR UNEMPLOYMENT INSURANCE PREMIUMS
 * AN AMOUNT EQUAL TO YOUR CONTRIBUTION FOR OLD AGE BENEFIT

JAGGARS - CHILES - STOVALL, INC.
 PALLAS, TEXAS

PERIOD ENDING	REGULAR		OVERTIME		OTHER EARNINGS
	HOURS	AMOUNT	HOURS	AMOUNT	

REGULAR AMOUNT 58.00 OVERTIME AMOUNT 4.20 OTHER EARNINGS 0.70

IN ADDITION TO YOUR TOTAL EARNINGS
JAGGARS - CHILES - STOVALL PAID FOR YOUR SHARE:
 * ALL OF YOUR MEDICAL & COMPENSATION PREMIUMS
 * ALL OF YOUR UNEMPLOYMENT INSURANCE PREMIUMS
 * AN AMOUNT EQUAL TO YOUR CONTRIBUTION FOR OLD AGE BENEFIT

TOTAL AMOUNT

59.90

YOU EARNED AND WE PAID THIS AMOUNT

59.90

QUALITY WORK INSURES REGULAR CHECKS

REGULAR	AMOUNT	58.00
OVERTIME	AMOUNT	4.20
OTHER EARNINGS	AMOUNT	0.70

THESE DEDUCTIONS AS PER YOUR REQUEST

THIS STATE IS IN CHARGE OF YOUR EARNINGS AND DEDUCTIONS AS REPORTED TO FEDERAL AND STATE GOVERNMENTS

PLEASE DETACH AND RETAIN FOR YOUR RECORDS

JAGGARS - CHILES - STOVALL PAID OUT THESE AMOUNTS FOR YOU

P.I.C.A.

W.M.T.A.

M.I./M.S.

EMP. ADVANCE

CODE

MISCELLANEOUS

AMOUNT

40.41

QUALITY WORK INSURES REGULAR CHECKS

REGULAR	AMOUNT	58.00
OVERTIME	AMOUNT	4.20
OTHER EARNINGS	AMOUNT	0.70

THESE DEDUCTIONS AS PER YOUR REQUEST

60

NO 2408

40.41

JAGGARS-CHILES-STOVALL, INC.

DALLAS, TEXAS

PERIOD ENDING	REGULAR AMOUNT	OVERTIME AMOUNT	OTHER EARNINGS
12/31/66	4000.00	2500.00	2500.00

REGULAR AMOUNT	OVERTIME AMOUNT	OTHER EARNINGS	TOTAL
4000.00	2500.00	2500.00	9000.00

IN ADDITION TO YOUR TOTAL EARNINGS
 JAGGARS-CHILES-STOVALL PAID FOR YOUR EMPLOYER'S
 * ALL OF YOUR WORKER'S COMPENSATION INSURANCE PREMIUM,
 * ALL OF YOUR UNEMPLOYMENT INSURANCE PREMIUM,
 * AN AMOUNT EQUAL TO YOUR CONTRIBUTION FOR OUR 401-K ACCOUNT.

JAGGARS-CHILES-STOVALL, INC.
 DALLAS, TEXAS

PERIOD ENDING	REGULAR		OVERTIME		OTHER EARNINGS	TOTAL
	HOURS	AMOUNT	HOURS	AMOUNT		
12/31/66	4000	4000.00	2500	2500.00	2500.00	9000.00

IN ADDITION TO YOUR TOTAL EARNINGS
 JAGGARS-CHILES-STOVALL PAID FOR YOUR EMPLOYER'S
 * ALL OF YOUR WORKER'S COMPENSATION INSURANCE PREMIUM,
 * ALL OF YOUR UNEMPLOYMENT INSURANCE PREMIUM,
 * AN AMOUNT EQUAL TO YOUR CONTRIBUTION FOR OUR 401-K ACCOUNT.

YOU EARNED AND WE PAID THIS AMOUNT

THIS STATE IS A RECORD OF YOUR EARNINGS AND DEDUCTIONS AS REPORTED TO FEDERAL AND STATE GOVERNMENTS

PLEASE DETACH AND RETAIN FOR YOUR RECORDS

QUALITY WORK INSURES REGULAR CHECKS

15% FICA	STATE TAX	FEDERAL TAX	UNEMPLOYMENT	WORKER'S COMP.
1350.00	231.00	416.00		

THESE DEDUCTIONS AS PER YOUR REQUEST

QUALITY WORK INSURES REGULAR CHECKS

60

2477

210 498

9000

No 6089